

ifm electronic

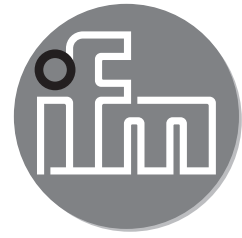

Installation Instructions  
Flow sensor

**efector300®**

**SF6200**

UK

701816 / 01 03 / 2011

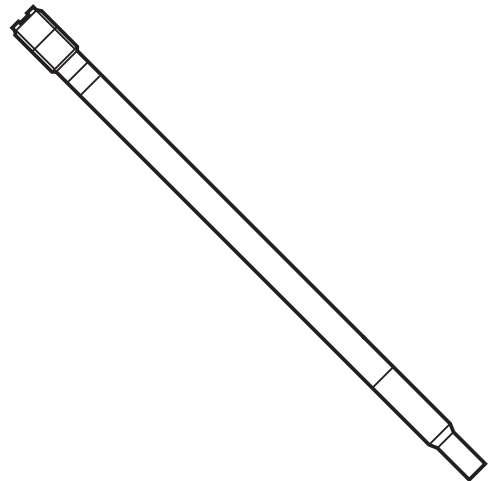

# 1 Function and features

In conjunction with the VS3000 control monitor the flow sensor monitors flows in liquids and gases. The sensor / control monitor combination senses whether a preset flow value has been reached (= medium flowing) or not (= medium not flowing) and provides a switched signal.

## 2 Installation

The unit is adaptable for various process fittings (clamp adapters to be ordered separately as accessories, order no. E4016, E40174).

- In the case of horizontal pipes mount the unit from the side, if possible (fig. 1).
  - When the unit is to be mounted at the bottom of the pipe, it should be free from deposits.
  - When the unit is to be mounted at the top of the pipe, it should be completely filled with the medium to be monitored.
- In the case of vertical pipes mount the unit in a place where the medium flows upwards (fig. 2).

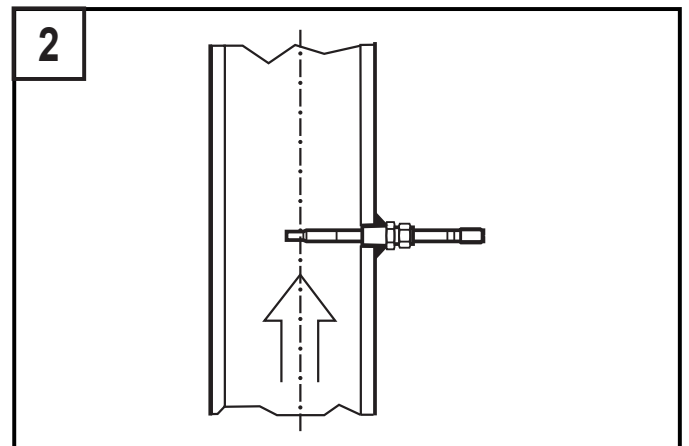
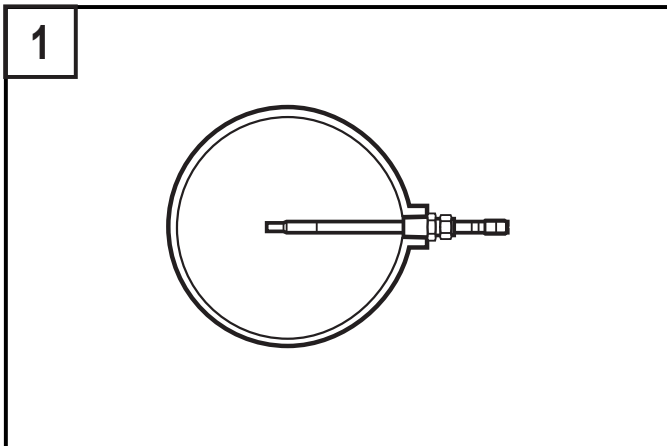

To avoid malfunction a minimum distance between the flow sensor and bends, valves, changes in cross-section or such like must be observed:

- Min. 5 x pipe diameter upstream (A),
- min. 3 x pipe diameter downstream (B).

