

# Truflo® — TKB Series In-Line Paddle Wheel Flow Meter Sensor

**ICON**™ Corrosion-Free  
PROCESS CONTROLS Instrumentation Equipment

Battery Powered | Flow | Total



# Industry's **Longest Lasting** Paddle Wheel Flow Meter

# Truflo® — TKB Series

## In-Line Paddle Wheel Flow Meter Sensor

- ✓ No Programming | Quick Installation
- ✓ Industry's Highest Accuracy:  $\pm 0.5\%$
- ✓ Lifetime Warranty\*



- ✓ Battery Powered
- ✓ Flow | Total
- ✓ Revolutionary ShearPro® Paddle Wheel Design
- ✓ Low Pressure Drop
- ✓ NEMA 4X | IP 66 Protection
- ✓ Password Protected Security
- ✓ True Union Design 1/2" - 2"
- ✓ Flange Connection 3" - 4"

### Engineered for accuracy, ruggedness, longevity, and battery powered convenience

The Truflo® TKB Series digital in-line flow meter sensors are easy to install with exceptional guaranteed long-life performance. They are highly repeatable, extremely rugged sensors that offer outstanding value and require no scheduled maintenance.

The TKB Series has a process-ready output signal with a wide dynamic flow range of 0.3 to 33 ft/s | 0.1 to 10 m/s. The sensor measures liquid flow rates in full pipes.

TKB Series flow meters are offered in a variety of materials and are available from 1/4" - 4" pipe sizes. The many material choices, including PVC, PP, PVDF and 316 SS make this model highly adaptable and chemically resistant to many corrosive liquid process applications.

The TKB Series flow meter bodies (PVC, PP, PVDF) are true-union designed up to 2" just as any true-union ball valve is designed. 3" - 4" versions are flanged. They come completely pre-programmed with a bright LCD Display that rotates 360°.

\* The Truflo® TKB Series also comes equipped with a lifetime warranty on the paddle wheel assembly.

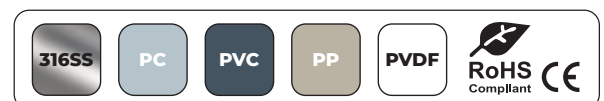

# Truflo® — TKB Series

## In-Line Paddle Wheel Flow Meter Sensor

### New ShearPro® Design

- ✓ Contoured Flow Profile
- ✓ Reduced Turbulence = Increased Longevity
- ✓ 78% Less Drag than Old Flat Paddle Design†

†Ref: NASA "Shape Effects on Drag"



### Tefzel® Paddle Wheel

- ✓ Superior Chemical And Wear Resistance vs PVDF

### Zirconium Ceramic Rotor | Bushings

- ✓ Up to 15x the Wear Resistance vs. Regular Ceramic
- ✓ Integral Rotor Bushings Reduce Wear and Fatigue Stress

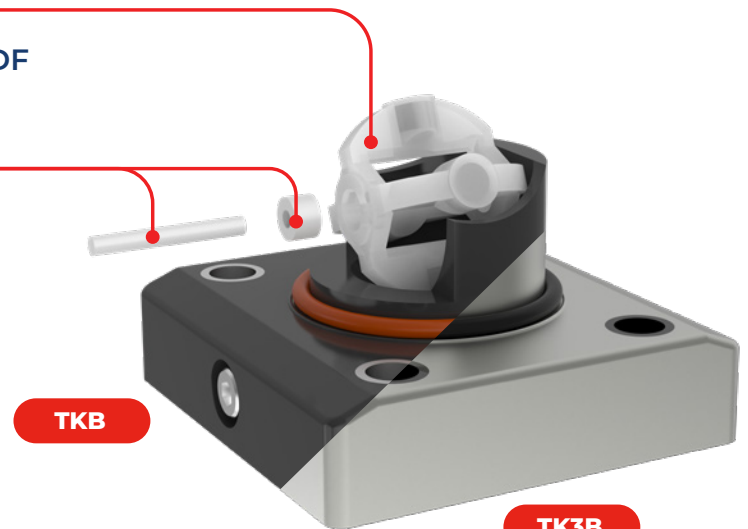

### ShearPro® Through-Pin Design

- ✓ Eliminates Finger Spread
- ✓ No Lost Paddles
- ✓ Increased Temp. Rating
- ✓ 360° Housing Protects Rotor

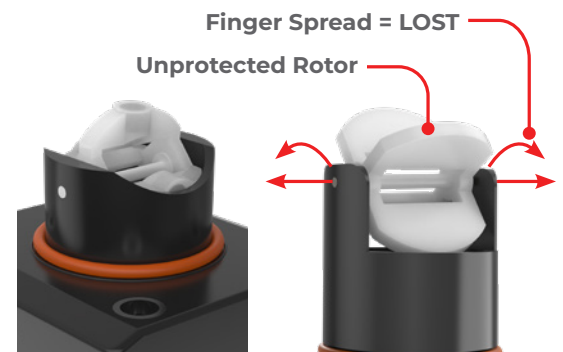

ShearPro® vs. Competitor 'A'

### Displaying Flow Rate | Flow Totalizer

r indicates Default Flow Rate Mode

Press and hold **SET** for 3 sec to change from Flow Rate to Flow Total

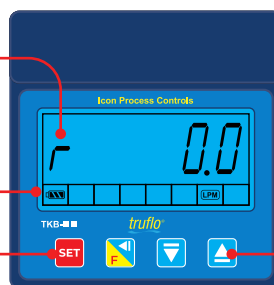

Press and hold **▲** for 3 sec to view 8 + 9 digits while in Totalizer Screen

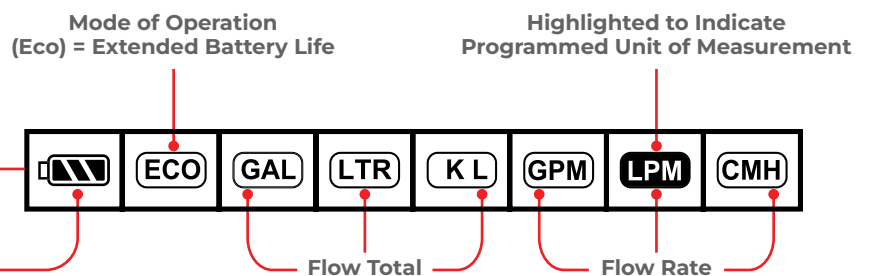

Battery Life

Flow Total

Flow Rate

Mode of Operation (Eco) = Extended Battery Life

Highlighted to Indicate Programmed Unit of Measurement

# Truflo® — TKB Series

## In-Line Paddle Wheel Flow Meter Sensor

### Specifications

General		
Operating Range	0.3 to 33 ft/s	0.1 to 10 m/s
Pipe Size Range	¼" to 4"	DN08 to DN100
Linearity	±0.5% of F.S @ 25°C   77°F	
Repeatability	±0.5% of F.S @ 25°C   77°F	
Wetted Materials		
Sensor Body	PVC (Dark)   PP (Pigmented)   PVDF (Natural)   316SS	
O-Rings	FKM   EPDM*   FFKM*	
Rotor Pin   Bushings	Zirconium Ceramic   ZrO <sub>2</sub>	
Paddle   Rotor	ETFE Tefzel®	
Electrical		
Operating Voltage Battery	3.0 VDC	
Battery	Lithium Battery (CR2477T)	
Life of Battery	> 1 Year Normal, > 2 Years Eco Mode	
Max. Temperature/Pressure Rating - Standard and Integral Sensor   Non-Shock		
PVC	180 psi @ 68°F   40 psi @ 140°F	12.5 bar @ 20°C   2.7 bar @ 60°C
PP	180 psi @ 68°F   40 psi @ 190°F	12.5 bar @ 20°C   2.7 bar @ 88°C
PVDF	200 psi @ 68°F   40 psi @ 240°F	14 bar @ 20°C   2.7 bar @ 115°C
316 SS	Consult Factory	
Operating Temperature		
PVC	32°F to 140°F	0°C to 60°C
PP	-4°F to 190°F	-20°C to 88°C
PVDF	-40°F to 240°F	-40°C to 115°C
316 SS	-40°F to 300°F	-40°C to 149°C
Standards and Approvals		
CE   FCC   RoHS Compliant		

See Temperature and Pressure Graphs for more information

\*Optional

### K-Factors for TK Series

Size	LPM	GPM
¼"	547	2079
⅜"	300	1140
½"	127.6	484.9
¾"	81.8	310.8
1"	55.1	209.4
1½"	18.8	71.4
2"	10.2	38.8
3"	4.7	18
4"	2.1	8
⚠ K-Factor is Pre-Programmed		

### Min/Max Flow Rates

Pipe Size (O.D.)	LPM   GPM		LPM   GPM	
	0.3m/s min.		10m/s max.	
DN08 (¼")	0.04	0.16	12	3
DN10 (⅜")	1.0	3.8	50	13
DN15 (½")	3.5	1.0	120	32
DN20 (¾")	5.0	1.5	170	45
DN25 (1")	9.0	2.5	300	79
DN40 (1½")	25.0	6.5	850	225
DN50 (2")	40.0	10.5	1350	357
DN65 (2½")	60.0	16.0	1850	357
DN80 (3")	90.0	24.0	2800	739
DN100 (4")	125.0	33.0	4350	1149

◀ SS Only

◀ SS Only

# Truflo® — TKB Series

## In-Line Paddle Wheel Flow Meter Sensor

### Temperature | Pressure Graphs | Non-Shock

**Note:** The Pressure/Temperature graphs are specifically for the Truflo® Flow Meter Sensors.

During system design the specifications of all components must be considered.

■ = PVC ■ = PP ■ = PVDF

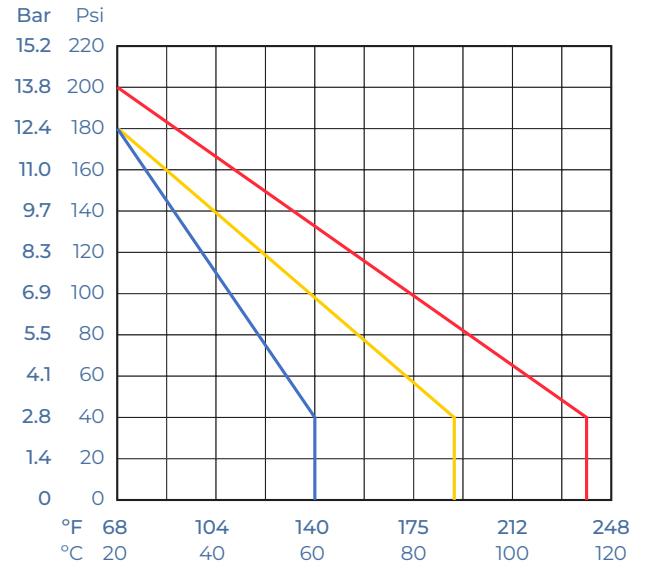

### Model Selection

TKB - [20] - [P] - [T] - [ ] **NOTE:** Leave blank for standard options

Pipe Size	Material	End Connections	Seals
15 : ½"    50 : 2"	<b>P</b> : PVC	Sch 80 Soc (Standard on PVC)	FKM (std)
20 : ¾"    80 : 3"	<b>PP</b> : PP	<b>T</b> : NPT (Standard on PP/PVDF, available on PVC)	<b>E</b> : EPDM
25 : 1"    100 : 4"	<b>PF</b> : PVDF	<b>F</b> : ANSI 150lb Flange	<b>K</b> : FFKM   Kalrez®
40 : 1½"		<b>B</b> : Butt Fusion	

TK3B - [20] - [SS] - [SE] - [ ] **NOTE:** Leave blank for standard options

Pipe Size	Material	End Connections	Seals
08 : ¼"    40 : 1½"	<b>S</b> : SS	<b>T</b> : NPT (Standard)	FKM (std)
10 : ⅜"    50 : 2"		<b>SE</b> : Sanitary	<b>E</b> : EPDM
15 : ½"    80 : 3"			<b>K</b> : FFKM   Kalrez®
20 : ¾"    100 : 4"			
25 : 1"			



by



Corrosion-Free Instrumentation Equipment

Phone: 905.469.9283 • Sales: sales@iconprocon.com • Support: support@iconprocon.com