

Sun Visor for 9900/9950 Transmitter

Quick Start Leaflet

+GF+

**CE
UK
CA**

159900233 3-9000.396.091
MA_00189 / EN DE / 00 (02.2025)
© Georg Fischer Signet LLC
5462 N. Irwindale Avenue,
Irwindale, CA 91706 U.S.A.
Tel. (626) 571-2770 / www.gfps.com
info.ps@georgfischer.com

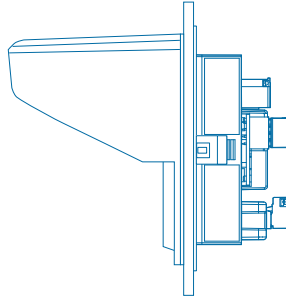

Installation Video



Compatibility

Sun Visor

9900 Transmitter

9950 Transmitter



01 Mount Sun Visor

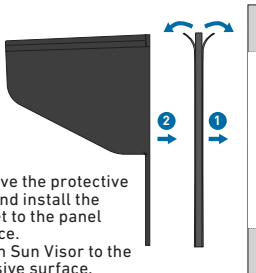

- 1 Remove the protective film and install the gasket to the panel surface.
- 2 Attach Sun Visor to the adhesive surface.

02 Mount Transmitter

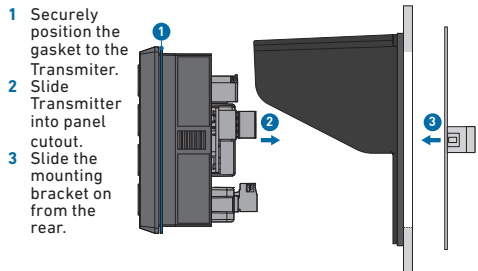

- 1 Securely position the gasket to the Transmitter.
- 2 Slide Transmitter into panel cutout.
- 3 Slide the mounting bracket on from the rear.

03 Fix mounting bracket

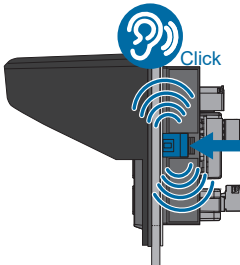

Press firmly, until you hear a click on both sides.
For maximum sealing, press the mounting bracket ears down as deep as possible.

04 Optional sealing

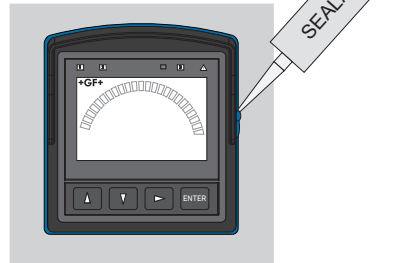

Optional: For a watertight seal (NEMA 4X, IP66 or higher), the Sun Visor must be sealed all around with sealant.

Sonnenblende für 9900/9950 Transmitter Kurzanleitung

+GF+

CE
UK
CA

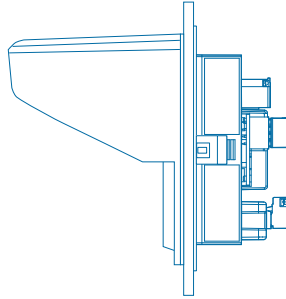

Installations-
video



Kompatibilität

Sonnenblende

9900 Transmitter

9950 Transmitter



01 Sonnenblende montieren

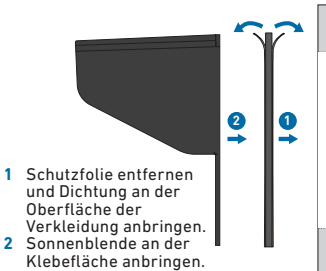

02 Transmitter montieren

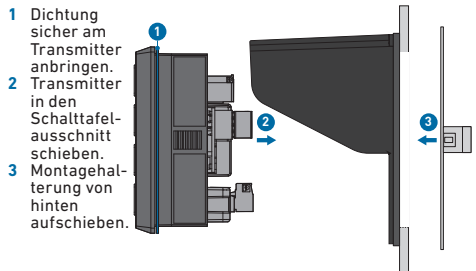

03 Montagehalterung fixieren

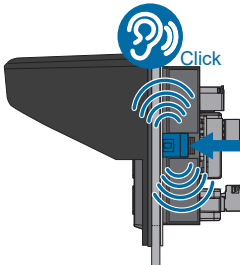

Fest andrücken, bis auf beiden Seiten ein Klicken zu hören ist. Für eine maximale Abdichtung, die Laschen der Montagehalterung so tief wie möglich nach unten drücken.

04 Optionale Abdichtung

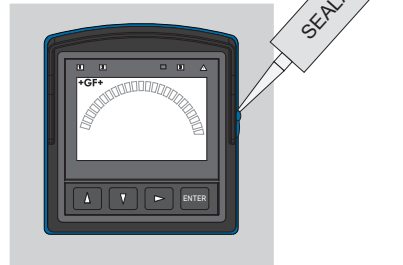

Optional: Für eine wasserdichte Versiegelung (NEMA 4X, IP66 oder höher) muss die Sonnenblende rundum mit Dichtmittel abgedichtet werden.