

RM2 Millennium

2-channel Rack Mount Controller

The RM2 Millennium's design provides flexible configuration, simple operation and maintenance, and intelligent functions that will save time and improve your bottomline.

- Calibration/Reset Button Programming, Clearing Alarms or Calibrations
- High Intensity LEDs Indicate Fault and Alarm
- RS-232 Serial COM Port Connect a Laptop or PDA for Setup and Event Logging
- Five Jumper Selectable Relays Normally Open or Closed
- Relay Set Points High/Low = Gas
Fire/Fault = Flame
- Two 4–20 mA Analog Outputs for Gas and Flame Detectors
- Four Character Scrolling Display – Visible in all Lighting Conditions
- English, Spanish, French Menu Languages Available



RM2 Millennium Controller

Features and Benefits

The Millennium RM2 is a 2-channel rack mount controller designed to offer you the ultimate in control and versatility. Create a monitoring system to suit your installation by combining any of Net Safety's flame or gas detection solutions to a centralized display to cover multiple zones with a single monitoring device.

The RM2's independent channels eliminate the standard industry limitation of monitoring only flame or only gas by adding a new level of flexibility — combining flame and/or gas detection into a single monitoring device. And with the RM2's independent channels, activity on one channel does not affect the other channel so a variety of tasks and activities can be performed without initiating false alarms.

Setup, operate, monitor and maintain the RM2 using the Front Panel Push button, or connect a PC or a PDA via the serial

communications port. The RM2 contains custom designed software and a number of user programmable options to configure the RM2 to exactly suit your needs in the field on demand. Operation and maintenance are simple without compromising safety or reliability. Specifically designed with end user input, the RM2 shows you what you need to know quickly and easily. Each channel has its own clearly visible display with helpful prompts to guide you through setup and maintenance tasks. Bright LEDs visually indicate warnings and alerts for each input channel and the RM2 circuitry. The Event Logging feature securely stores in protected RAM up to 1000 events automatically listing the date, time, channel, detector type and the associated alarm, fault or calibration event. Highly useful information for developing maintenance schedules or performing troubleshooting and sequence of events analysis.

Specifications

Table 1 - RM2 Millennium Controller Ranges

| Specifications | Analog | Relay | Digital |
|--------------------------------|--|---|----------------------------|
| Operating Voltage Range | 10.5 to 32 Vdc | | |
| Power Consumption (at 24 V dc) | Nominal 150 mA (1.8 W / 3.0 W) de-energized / energized maximum 290 mA / 3.48 W | | |
| Power Consumption (at 12 V dc) | Nominal 80 mA / 130 mA (1.92 W / 3.12 W) de-energized / energized maximum 160 mA / 3.84 W | | |
| Temperature Range | -40 °C to +80 °C (-40 °F to +176 °F) | | |
| Humidity Range | 0 to 100 % RH, non-condensing | | |
| Chassis Material | 16 gauge steel / powder coated | | |
| Weight | 2.1 Kg / 4.5 lb (Stainless Steel option 3.4 Kg / 7.5 lb) | | |
| Outputs | 4 to 20 mA - Into a maximum loop impedance of 800 Ohms at 32 V dc or 150 Ohms at 10.5 V dc. Isolated or non-isolated loop supply. | Form C contacts rated 5 Amps at 30 V dc / 250 V ac. Selectable energized / de-energized latching / non-latching, N.O. or N.C. Fault relay fixed as energized, non-latching. | RS-485 RTU Modbus protocol |
| Certifications/Approvals | CSA - Class I, Division 2, Groups A, B, C and D - Temperature code T6 (Canada only) ANSI-UL/ISA - Certified for ordinary location for Canada and US | | |
| Warranty | 2 Year Warranty on Electronics | | |

Compatibility

The following Net Safety products are compatible with the RM2 Millennium Controller:

- **Flame Detectors:** IR35-A, UV/IRS-A, UVS-A, UVS-H2-A, UV/IRS-H2-A
- **Gas Transmitters:** Millennium II Series, Millennium Series, Toxic Series
- **Gas Sensors:** ST Toxic Sensor Series

Figure 1 - Compatible Net Safety Products

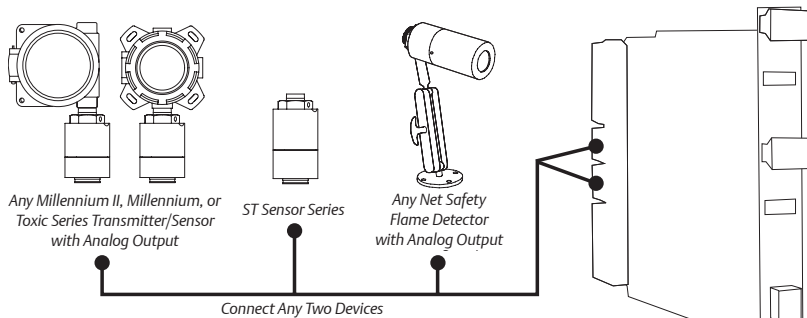

| ORDERING INFORMATION | |
|----------------------|---|
| RM2-ARD | 2-channel rack mount w/ analog, relay and digital RS-485 Modbus RTU protocol output |
| Labelling Options | |
| -CC | two combustible detectors |
| -CF | one combustible, one flame detector |
| -CT | one combustible, one toxic detector |
| -FF | two flame detectors |
| -FT | one flame, one toxic detector |
| -TT | two toxic detectors |

| ACCESSORIES |
|--|
| RM2-COM-KIT - Communication Kit CAGE 2/4/8/12/16 - Rack Mount Cages |
|  |
| BFP - Blank Filler Plate |

HEADQUARTERS
Emerson Process Management
Flame and Gas Detection
Net Safety Monitoring Inc.
2721 Hopewell Place NE
Calgary, Alberta, Canada T1Y 7J7
T + 1 (403) 219 0688
T 1 866 FIREGAS
F + 1 (403) 219 0694
www.net-safety.com

©2012 Emerson Process Management. All rights reserved.

The Emerson logo is a trademark and service mark of Emerson Electric Co. Rosemount Analytical and Net Safety Monitoring are marks of Emerson Process Management family of companies. All other marks are the property of their respective owners.

The contents of this publication are presented for information purposes only, and while effort has been made to ensure their accuracy, they are not to be construed as warranties or guarantees, express or implied, regarding the products or services described herein or their use or applicability. All sales are governed by our terms and conditions, which are available on request. We reserve the right to modify or improve the designs or specifications of our products at any time without notice.