

# EZ-View® Flow Meters

## With Flow-Alert™ Flow Switch

- Reed switch and latching models
- Automatically signals alarm, if flow is too high or too low
- Models available for AC or DC power supply
- Latching model includes Hirschmann type electrical connector
- Easy to install
- Easy flow limit adjustment
- Operates in any position
- Relatively insensitive to shock and vibration
- Repeatability within  $\pm 1\%$
- Low cost

### SPECIFICATIONS:

#### MATERIALS:

Polysulfone plastic body, piston and cone  
 T300-series stainless spring  
 Buna N flow indicator ring and pressure seals  
 C360 Brass or PVC fittings  
 Polypropylene limit indicators  
 Strontium Ferrite magnet

**FITTINGS/ THREADS:** NPT ANSI/ASME B1.20.1, BSPP ISO228

See Ordering Information Table, page 70

**TEMPERATURE RANGE:** 32 °F to 250 °F (0 °C to 121 °C)

**PRESSURE RATING:** Liquid: 325 psi / 22.4 bar maximum;  
 Air/Gases: 125 psi / 8.6 bar maximum

**PRESSURE DROP:** See Differential Pressure Charts, page 68

**ACCURACY:**  $\pm 5\%$  of full scale

**REPEATABILITY:**  $\pm 1\%$

**DIMENSIONS:** See Ordering Information Table, page 70

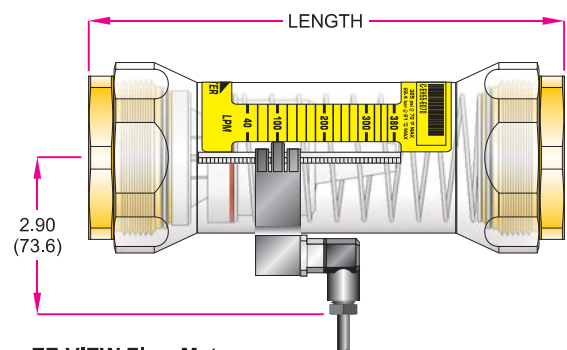
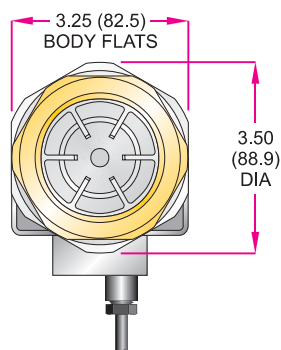

**EZ-VIEW Flow Meter**  
(with Flow-Alert Flow Switch Module)

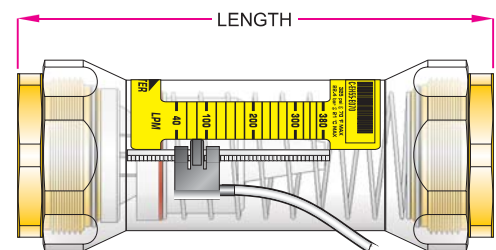
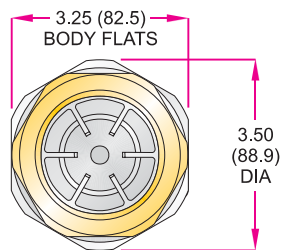

**EZ-VIEW Flow Meter**  
(with Flow-Alert Reed Switch)

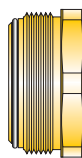

1-1/2" NPTF  
female  
brass fitting

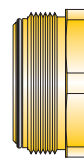

1-1/2" BSPP  
female  
brass fitting

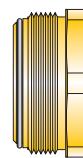

2" NPTF  
female  
brass fitting



2" BSPP  
female  
brass fitting

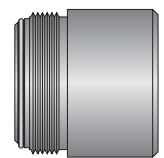

2" PVC  
socket weld  
fitting

# EZ-View® Flow Meters

## With Flow-Alert™ Flow Switch

### Flow Switch Options and Specifications:

The AC and DC powered Flow-Alert Flow Switch modules consist of a latching relay circuit housed in a sealed polypropylene enclosure. The modules have a normally open dry relay contact that can be used to directly control alarms, warning lights, relays or be used to interface to a PLC. The relay will be latched on as the magnet inside the flow meter passes by the module, and remain latched on until the magnet passes in the other direction or power is interrupted. The set point is adjustable from 0 to 100% of full scale.

The Reed Switch Flow-Alert modules are housed in a sealed polypropylene enclosure. The reed switch module does not provide the latching function like the AC and DC powered units. When the magnet inside the flow meter comes within proximity of the module, the reed switch will change state. The set point is adjustable from 0 to 100% full scale. Two reed switches providing low flow and high flow set points may be installed on a single flow meter.

	AC Latching	DC Latching	Reed Switch Form-A Normally Open (NO)	Reed Switch Form-B Normally Closed (NC)	Reed Switch Form-C
Operating Voltage	115 VAC ±10%	10-30 VDC	–	–	–
Operating Current	25 mA maximum	25 mA maximum	–	–	–
Contact Rating	1A @ 30 VDC 0.5A @ 125 VAC Resistive Load	1A @ 30 VDC 0.5A @ 125 VAC Resistive Load	1A max 200 VDC max 15 Watts max Resistive Load	0.25A max 175 VDC max 5 Watts max Resistive Load	0.25A max 175 VDC max 5 Watts max Resistive Load
Operating Temperature	32 to 158 °F (0 to 70 °C)	32 to 158 °F (0 to 70 °C)	32 to 250 °F (0 to 121 °C)	32 to 250 °F (0 to 121 °C)	32 to 250 °F (0 to 121 °C)
Connector	4-pin connector (Protection Class IP65)	4-pin connector (Protection Class IP65)	–	–	–
Cable	Not Included	Not Included	3 foot, 2-wire #24 AWG black PVC Jacketed pig-tail	3 foot, 2-wire #20 AWG grey PVC Jacketed pig-tail	3 foot, 3-wire #24 AWG grey PVC Jacketed pig-tail
Rating	NEMA 12 & 13 (IP65)	NEMA 12 & 13 (IP65)	NEMA 12 & 13 (IP65)	NEMA 12 & 13 (IP65)	NEMA 12 & 13 (IP65)
Certification	N/A	CE	CE	CE	CE
Model Number	H526-004	H526-006	H526-008-NO	H526-008-NC	H526-008

**NOTE: Flow switches and flow meters sold separately**

### Ordering Information

Fluid Media	Flow Range		1-1/2" NPTF female, brass fitting	1-1/2" BSPP female, brass fitting	2" NPTF female, brass fitting	2" BSPP female, brass fitting	2" PVC socket fitting <sup>①</sup>
	Oil 0.876 s.g.	2 – 25 GPM 5 – 50 GPM 7 – 75 GPM 10 – 100 GPM	10 – 95 LPM 20 – 190 LPM 30 – 280 LPM 40 – 380 LPM	H615-725 H615-750 H615-775 H615-710	H616-725 H616-750 H616-775 H616-710	H617-725 H617-750 H617-775 H617-710	H618-725 H618-750 H618-775 H618-710
Water 1.0 s.g.	2 – 25 GPM 5 – 50 GPM 7 – 75 GPM 10 – 100 GPM	10 – 95 LPM 20 – 190 LPM 30 – 280 LPM 40 – 380 LPM	H615-625 H615-650 H615-675 H615-610	H616-625 H616-650 H616-675 H616-610	H617-625 H617-650 H617-675 H617-610	H618-625 H618-650 H618-675 H618-610	H619-625 H619-650 H619-675 H619-610
Air 1.0 s.g.	35 – 200 SCFM 45 – 300 SCFM 60 – 600 SCFM 90 – 800 SCFM 140 – 1000 SCFM	15 – 95 LPS 20 – 140 LPS 25 – 275 LPS 45 – 370 LPS 75 – 475 LPS	H615-520 H615-530 H615-560 H615-580 H615-510	H616-520 H616-530 H616-560 H616-580 H616-510	H617-520 H617-530 H617-560 H617-580 H617-510	H618-520 H618-530 H618-560 H618-580 H618-510	
DIMENSIONS:	Length <sup>②</sup> in (mm)		8.72 (221.5)	8.72 (221.5)	8.72 (221.5)	8.72 (221.5)	11.48 (291.6)
	Fitting Flats in (mm)		3.00 (76.2)	3.00 (76.2)	3.00 (76.2)	3.00 (76.2)	N/A
	Weight lb (kg)		4.10 (1.86)	4.10 (1.86)	3.10 (1.41)	3.10 (1.41)	1.70 (.077)

<sup>①</sup> Fits 2" Sch 40/80 PVC, CPVC pipe.

<sup>②</sup> Length includes end fitting.

**NOTE: Flow switches and flow meters sold separately**