

FloPro

Series 3



PRODUCT MANUAL



www.macemeters.com



Water Monitoring Solutions

MACE FloPro Series 3 Product Manual

Product Support

Should you experience difficulty in using this product, please contact your supplier.

We also welcome feedback from customers who feel that their experience may provide an improvement to the product or may be beneficial to other users.

Please go to www.macemeters.com

Disclaimer

No warranties of any nature are extended by this document.

Measuring and Control Equipment Co. Pty. Ltd. (MACE) will not accept any financial or other responsibility that may be the result of your use of this information, including direct, indirect, special or consequential damages.

You must be careful to ensure that the use of this information complies with the laws, rules and regulations of the jurisdictions with respect to which it is used.

MACE assumes no responsibility for personal or property damage caused by the misuse of this equipment.

Copyright

Information in this document is subject to change without notice. The software described in this document is furnished under a license agreement or nondisclosure agreement. The software may be used or copied only in accordance with the terms of those agreements. No part of this publication may be reproduced, stored in a retrieval system, or transmitted in any form or any means electronic or mechanical, including photocopying and recording for any purpose other than the purchaser's personal use without the written permission of Measuring & Control Equipment P/L.

Copyright © 1996-2009. MACE P/L. All rights reserved.

About Doppler ultrasonics

MACE Flo-series instruments utilise the Doppler Effect to measure velocity of stream flows.

The Doppler Effect (after C. J. Doppler 1803-53) is defined as, "the apparent change in the frequency of sound or electromagnetic radiation due to relative motion between the source and the observer" (Uvarov & Isaacs (1986). Dictionary of Science).

The MACE Flo-Series instruments transmit an ultrasonic (sound) wave into the flow. This sound wave is reflected by acoustically reflective particles (e.g. air bubbles, suspended solids) and the instrument detects the reflected frequencies. The difference between the transmitted frequency and the received frequencies is directly proportional to the velocity of the stream flow.

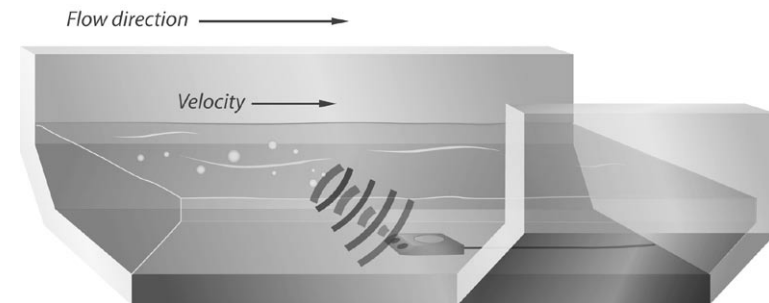

In full or partially full pipes, the velocity of the stream flow varies markedly across the cross-section of the pipe. Typically, velocity is zero along the wall of the pipe and increases to a maximum at or about the centre of the pipe. MACE Flo-series instruments receive reflected frequencies from particles moving at these different velocities. The greater the area of flow moving at a particular velocity, the greater the number of reflections with the respective frequency shift. The average velocity of the stream is therefore calculated by averaging those frequency reflections received across the whole stream profile.

Section A: Hardware Manual

This is an interactive PDF

This user manual is setup as an interactive PDF. The user can click on any of the “*Chapters*” in the Table of contents to navigate directly to the corresponding page. To return to the Table of contents click on the “*Return to TOC*” button at the bottom of each page.

References to chapters in the body text are hyperlinks.

CHAPTER	PAGE	
1.0	Introduction to FloPro Series 3	1
2.0	Warnings	2
3.0	Site selection	3
4.0	Sensor types	8
4.1	Insertion sensors	8
4.2	Strap mount sensors	8
5.0	Installing an insertion sensor	9
6.0	Installing a sensor on a plastic strap	12
7.0	Installing a sensor using the mounting plate	15
8.0	Installing FloPro power options	16
8.1	Solar panel installation on a 2” pole	16
8.2	Installing a MACE mains powered trickle charger	18
8.3	Powering the FloPro with an external battery	19
9.0	Electronics module	20
10.0	Installing the FloPro on a 2” pole	22
10.1	Sensor and power cables routed inside the pole	22
10.2	Sensor and power cables routed through conduit	24
11.0	Installing the FloPro on a wall	25
12.0	The I/O (Input/Output) card	26
13.0	Wiring digital inputs	27
14.0	Wiring analogue inputs	28
15.0	Wiring digital outputs	30
16.0	Wiring analogue outputs	30
17.0	Installing additional cards	31
18.0	Installing a Series3 FloSI card	32
19.0	Maintenance	33
19.1	Battery maintenance	33
19.2	Solar panel maintenance	33
19.3	Sensor maintenance	34
19.4	Depth sensor reference filter maintenance	34

Section B: Software Manual

CHAPTER	PAGE
20.0	Introduction to FloCom+ 37
21.0	Installing the software 38
22.0	Connecting to the device 40
22.1	Connecting to the device using the serial port 40
22.2	What to do if the password is lost/forgotten 41
23.0	System information 42
24.0	FloPro settings dialogue box 44
24.1	General settings 45
24.2	Sensor power 46
24.3	View configuration 46
24.4	Reset configuration 46
25.0	Configure modules 47
25.1	Adding a module 47
25.2	Configuring and editing the Doppler module options 47
25.3	Removing a configured module 48
26.0	Configure channels 49
26.1	Adding a new channel 49
26.1.1	Add a "Velocity" channel type - Doppler card 50
26.1.2	Add a "Depth" channel type - Doppler card 50
26.1.3	Add a "Velocity" channel type - I/O card (4-20mA) 51
26.1.4	Add a "Velocity" channel type - I/O card (Frequency) 52
26.1.5	Add a "Depth" channel type - I/O card (4-20mA) 53
26.1.6	Add a "Depth" channel type - I/O card (Shaft encoder) 54
26.1.7	Add a "Flowrate (Velocity)" channel type - Doppler 55
26.1.8	Add a "Flowrate (Velocity)" channel type - I/O card 56
26.1.9	Add a "Flowrate (Weir)" channel type 57
26.1.10	Add a "Total flow" channel type 59
26.1.11	Add a "Event - pulse" channel type 60
26.1.12	Add a "Event-status change" channel type 61
26.1.13	Add a "Input pulse total" channel type 62
26.1.14	Add a "Binary" channel type - I/O card 63
26.1.15	Add a "User defined" channel type - I/O card (Voltage) 64

Section B: Software Manual

CHAPTER	PAGE
26.2	The order and removal of channels 65
26.3	Editing a channel 66
26.3.1	Edit "Velocity" channel type - Doppler card 67
26.3.2	Edit "Depth" channel type - Doppler card 75
26.3.3	Edit "4-20mA" input type - I/O card 78
26.3.4	Edit "Frequency", "Voltage" and "Shaft encoder" input type - I/O card 79
26.3.5	Edit "Flowrate (Velocity)" channel type 80
26.3.6	Edit a "Flowrate (Weir)" channel type 85
26.3.7	Edit a "Total" channel type 89
26.3.8	Edit a "Event - pulse" channel type 90
26.3.9	Edit a "Event - status change" channel type 90
26.3.10	Edit a "Input total pulse" channel type 91
26.3.11	Edit a "Binary" channel type 92
27.0	Configure outputs 93
27.1	Adding outputs 93
27.2	Editing outputs 95
28.0	Configuring FloSI Card 97
28.1	Configuring a FloSI 97
28.2	Serial Interface Settings 98
28.3	Ordering the SDI-12 or ASCII Output String 102
29.0	About real time data 103
30.0	Real time data 107
31.0	Start/Stop device 108
32.0	Disconnect 108
33.0	View totals 109
34.0	Downloading stored data 110
35.0	View downloaded data file 110
Appendix A	Flume/weir coefficients 114

1.0 Introduction to FloPro Series 3

This manual describes the installation, use and maintenance of the FloPro Series 3.

The FloPro Series 3 typically consists of four main components:

- The electronics module.
- The sensor(s).
- The solar panel (or power supply).
- Flocom+ software enabling you to configure and download your FloPro Series 3.

Section A:

Hardware Manual

Mace FloPro Series 3

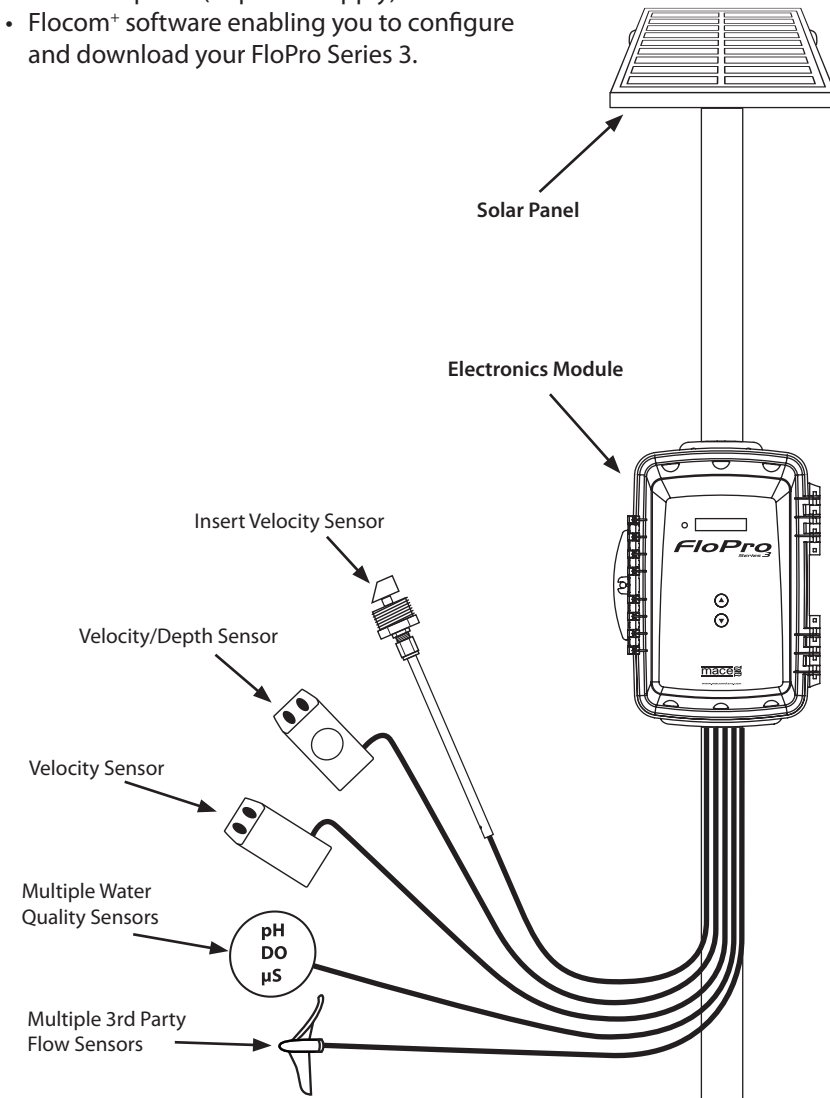

2.0 Warnings

2.1 Intrinsic Safety

The FloPro Series 3 is NOT an intrinsically safe instrument and should not be installed in hazardous (explosive) environments. Should an intrinsically safe instrument be required, MACE can offer other instruments with this approval level.

2.2 Floods

MACE recommends that the FloPro Series 3 electronics module be mounted above known flood peak levels. MACE will not be liable for damage caused by flooding. (The unit is weatherproof, but NOT waterproof and should NOT be submerged).

2.3 Sunlight

MACE recommends that the FloPro Series 3 electronics module be mounted so that the LCD faces in a direction away from direct sunlight (ie South in the Southern Hemisphere and North in the Northern Hemisphere).

2.4 Cable damage

MACE recommends that all cables be appropriately routed through electrical conduit or other similar mechanism. MACE will not be liable for damage to cables, especially if it is caused by vehicles, digging implements, animals or debris in the pipe or channel.

2.5 Insects and moisture

After the FloPro Series 3 system has been installed and fully tested, MACE recommends the use of expanding "space filler" foam down the first 5 to 10cm (2 to 4") of the conduit or mounting pole to prevent insect/moisture ingress.

2.6 Battery life

Care must be taken when a mains power supply is used to charge the internal battery instead of a solar panel. If the mains power remains disconnected for an extended period of time, the internal battery may be permanently damaged.

2.7 Electromagnetic compatibility (EMC)

This is a Class A product. In a domestic environment this product may cause radio interference in which case the user may be required to take adequate measures.

3.0 Site selection

When selecting a suitable site to measure flow and mount the instrument, you must consider the following:

1. Does the stream flow that I wish to measure contain sufficient acoustically reflective particles such as sand, silt, dirt, leaves or air bubbles? (The stream that you wish to measure must contain at least 100 parts per million of acoustically reflective particles that are greater than 75 microns in size).

Yes – The stream flow is suitable for Doppler ultrasonic flow measurement.

No – The stream flow is unsuitable for Doppler ultrasonic flow measurement.

2. Does the pipe in which I am measuring, run full or partially full?

Full – A velocity only sensor can be used.

Partial – A combined depth/velocity sensor will be required.

3. If the pipe flows full, is the internal pressure of the pipe within the range 0 - 25 m (0 - 253kPa, 0 – 37 psi)?

Yes – The stream flow is suitable for Doppler ultrasonic flow measurement.

No – The stream flow is suitable for Doppler ultrasonic flow measurement only if it contains at least 100 parts per million of suspended solids that are greater than 75 microns in size.

4. Can I get access to the outside wall of the pipe for mounting the sensor?

Yes – Consider using an insert velocity sensor if the pipe runs full.

No – Must use a strap mount sensor internally.

3.0 Site selection - Continued

5. Does the proposed site have obstructions in the pipe which might cause irregularities in the flow (eg. elbows, constrictions, valves, gates etc)?

Yes – You will need to install the sensor at a point where there is at least eight pipe diameters of straight pipe with no obstructions. MACE recommends that the sensor is mounted so that there is a distance of at least six pipe diameters of straight pipe in front of it and at least two pipe diameters of straight pipe behind it.

No – Even when there are no obvious obstructions, MACE recommends observing the instructions described above.

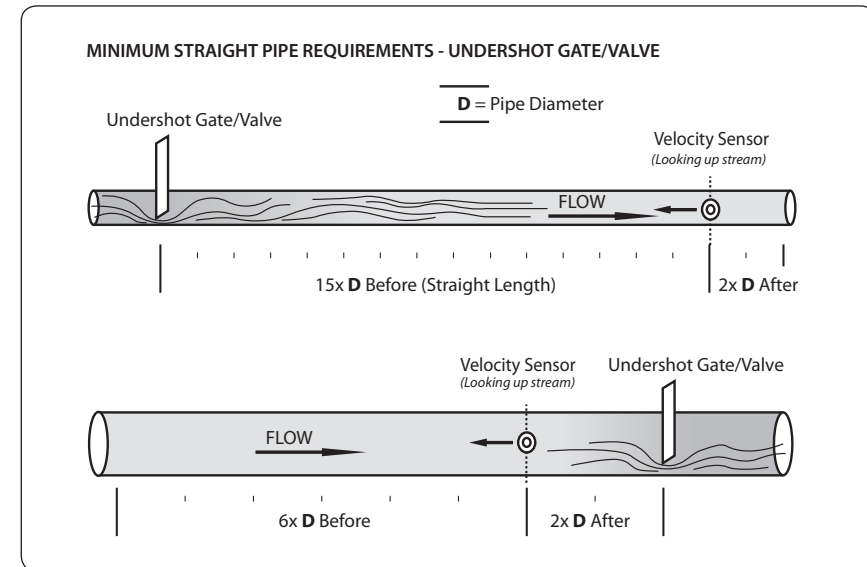
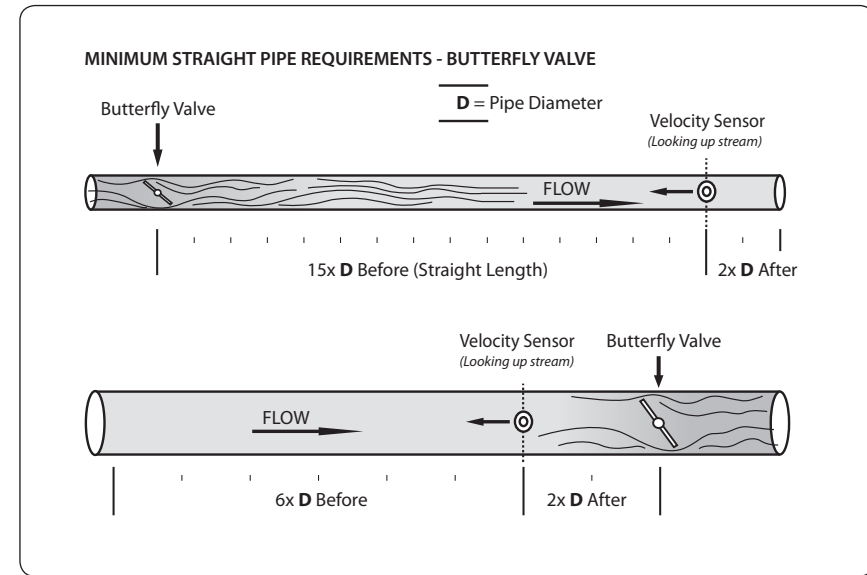
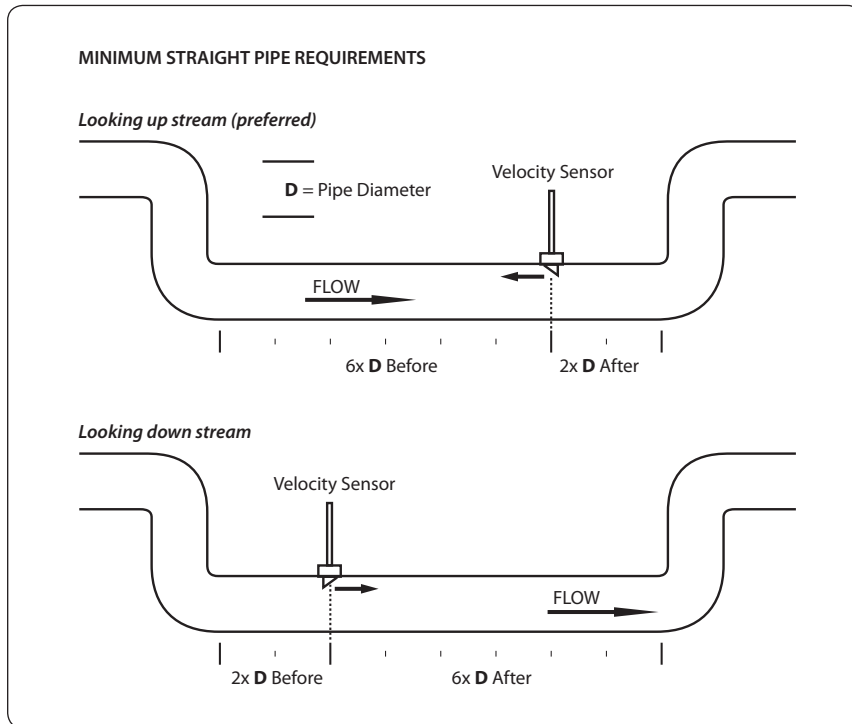

3.0 Site selection - Continued

6. Where is the best place to mount the sensor in a Full pipe?

The sensor should be mounted on the side wall of the pipe, between the 2 and 5 o'clock positions. A ball valve should be used when mounting "Insert" type sensor to allow for easy maintenance.

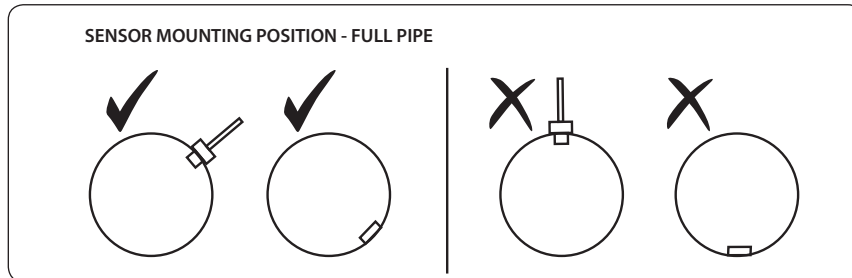

WARNING - Don't mount the sensor at the top of the pipe as air pockets could give unreliable readings. Don't mount the sensor at the bottom of the pipe as silt build-up can cover the sensor. Only mount the sensor between 2 and 5 o'clock as shown above.

7. Where is the best place to mount the sensor in a partially full pipe or channel?

The sensor must be mounted such that the depth sensor is always covered by water to a depth of at least 50mm (2 inches). Refer diagram over page.

8. Is there likely to be silt build-up over the sensor?

If this is the case, MACE recommends mounting the sensor on the side wall of the pipe instead of near the bottom of the pipe. Refer diagram over page.

9. Is there enough sunlight for the solar panel to work efficiently?

Yes – Mount solar panel as per instructions (see 8.1 Solar panel installation on a 2" pole)

No – A mains powered trickle charger should be used to charge the internal battery.

! Users are advised to ascertain the suitability of solar panels for their application by checking relevant solar radiation maps for their region (for example those found at http://rredc.nrel.gov/solar/old_data/nsrdb/redbook/atlas/). As a guideline, for an FloPro with 3 Doppler sensors and measuring every 5 minutes, at least 3 hours sunlight per day

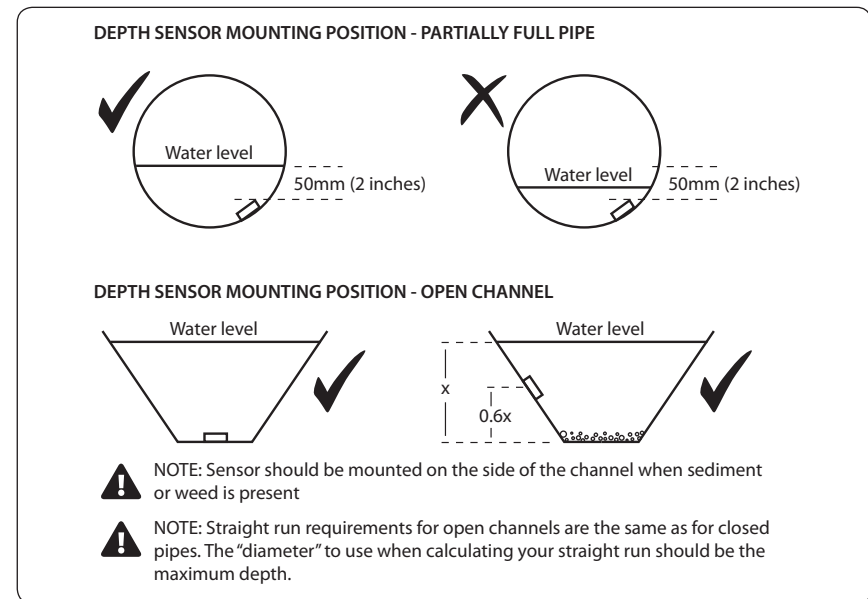

10. How far can the sensor be mounted from the electronics module?

A maximum of 50 metres (150ft) of cable is available on any MACE sensor.

11. How do I customise the FloPro Series 3 for my application?

Use the application software, FloCom⁺ to:

- Configure the unit for your site. For example, this includes setting the pipe diameter and logging interval.
- View the velocity profile measured by the sensors. This is useful if you think there may be irregularities in the flow at the site or you want to check the operation of the unit.
- Download data from the FloPro Series 3.

FloCom⁺ is available for download at www.macemeters.com

4.0 Sensor types

The FloPro Series 3 sensors measure the amount of water flowing in the pipe using one of two methods. When the pipe is full, only the velocity of the flow is measured as the cross sectional area of the flow is constant. In partially full pipes or open channels, the velocity and depth of the flow are measured in order to calculate flow rate.

4.1 Insertion sensors

This type of sensor is used in full pipes where access into the pipe is impractical or when it may be necessary to remove the sensor in the future without stopping the flow or emptying the pipe.

Insertion sensors require access to the outside wall of the pipe in which the sensor is to be mounted. The 2" insertion sensor should be used in pipes that have a diameter of greater than 100 mm (4").

MACE recommends that a ball or gate valve is always used when installing insertion sensors so that sensor maintenance can occur without requiring the pipe to be emptied of liquid.

4.2 Strap mount sensors

"Strap mount" type. This type of configuration is used in full pipes when access to the pipe is available and the pipe can be emptied when installation or maintenance is required.

"Strap mount velocity/depth" type. This type of sensor must be used in pipes that run partially full or in open channels.

There are several different types of straps used to hold the "strap mount" sensors in pipes:

- Plastic expandable mounting straps (polypropylene)
- Mounting plate (polypropylene)

A plastic expandable mounting "strap" can be used to secure the sensor in place. These straps are made from polypropylene and come in five lengths to suit different pipe diameters.

- 225-300mm (12" max)
- 300-450mm (18" max)
- 450-625mm (25" max)
- 600-725mm (29" max)
- 700-810mm (32" max)

Single mounting plates are normally used in large pipes where a cost-effective solution is required. The sensor is attached to the plate, which is then bolted to the inside surface of the pipe. This plate is supplied in polypropylene.

5.0 Installing an insertion sensor

1. Attach a male 2" BSP or NPT nipple to the pipe in a manner suitable for the pipe material. This fitting must:

- Be at right angles to the flow
- Provide for a clean join inside the pipe (no burring etc)
- Be watertight

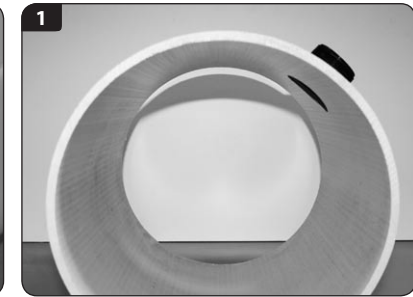

WARNING - DO NOT mount this fitting:

- In the centre, at the top of the pipe (may contain trapped air)
- In the centre, on the bottom of the pipe (may contain a sediment load)

2. Fit a full bore 2" gate or ball valve to the male nipple, using thread sealant to ensure that it makes a water tight seal.



3. You are now ready to insert the sensor but first you must determine how far into the pipe the sensor face needs to be inserted. The sensor face must be the only thing that intrudes into the flow. Accurate measurements must be taken to get the *values* x , y and z as shown in the diagram over the page.

4. Measure *value* z . Measure from the top of the sensor head to the top of the sensor shaft. Write the number as your *z value*.

5.0 Installing an insertion sensor - *Continued*

HOW TO CALCULATE INSERTION MEASUREMENT FOR TRANSDUCER

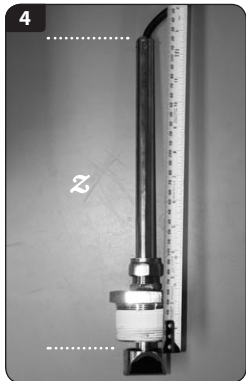
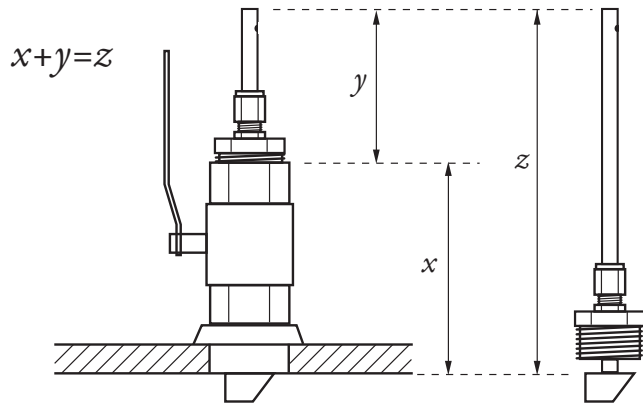

4. Measure *value z*. Take a measurement from the top of the ball valve to the inside of the pipe wall. **NOTE: You need the end of the tape measure to be level with the inside diameter of the pipe wall.**

5. Calculate *value y*. *Value y* is the difference between *value x* and *value z*.



6. Apply thread sealant onto the thread of the sensor to ensure that it makes a water tight joint with the valve. Screw the sensor assembly into the valve.

7. Make sure that the $\frac{3}{4}$ " gland nut is only finger tight. This will allow the sensor head to be moved freely while the head is aligned into the flow.

8. Open the valve fully and push the sensor head into the flow so it fully enters the stream without exposing any shaft. To get the sensor in exactly the right position you need to make the distance between the top of the ball valve to the top of the sensor shaft the same as *value y*. Refer to the photos over page.



9. Now that the insertion depth is correct, rotate the sensor so that the grub screw at the top of the sensor shaft is accurately pointing in the direction of the longest straight section of pipe. Remember you must have a distance of at least six pipe diameters of straight pipe in front of the sensor and two pipe diameters of distance behind the sensor.

NOTE: The grub screw indicates the velocity sensing face.

10. Tighten the $\frac{3}{4}$ " gland nut to lock the sensor in place.

! Do not use thread sealant on the $\frac{3}{4}$ " gland nut

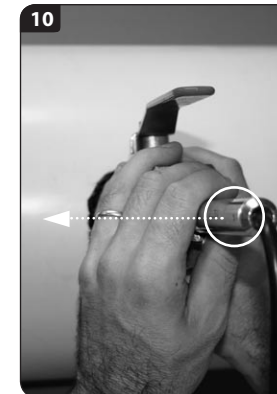
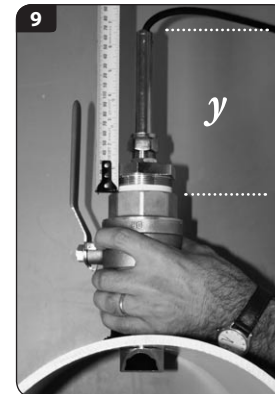

11. When the installation is complete, the sensor shaft should be pointing directly towards the centre of the pipe in all planes.

12. Carefully route the cable from the sensor back to where the electronics box will be mounted.

! Particular care should be taken when routing cables to ensure that moisture CANNOT enter the connector of the sensor cable as permanent damage may occur

! MACE recommends that all cables be appropriately routed through electrical conduit or other similar mechanism. MACE will not be liable for damage to cables, especially that caused by vehicles, digging implements, animals or debris in the pipe or channel

6.0 Installing a sensor on a plastic strap

These plastic (polypropylene) straps are typically used to mount the sensor in locations where temporary monitoring will take place. They allow for both very quick installation and removal of a strap mount sensor.

1. Hold the sensor so that you can see the 'eyes' of the sensor in front of you, the sensor cable running to your left
2. Place the mounting strap on the ground or a bench so that you can see the chamfered edge of the strap in front of you. Place the 'toe' of the sensor into the front of the hole in the strap. Press the body of the sensor down onto the strap.
3. Turn the whole assembly over. Make sure the cut out in the strap sits down around the 'foot' on the sensor.
4. You should see six countersunk holes in the strap. Fit the six screws supplied (M3 x 8 mm Phillips head countersunk 304 s/s).



Use only a hand screwdriver. Do not over tighten these screws as permanent damage to the thread may result

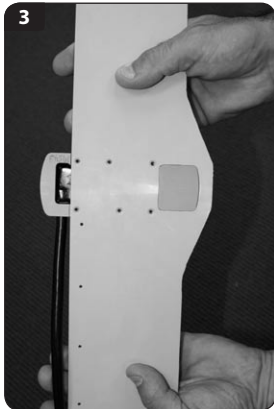

5. Tie the cable to the plastic strap using the holes and cable ties provided. Make sure that the knob of the cable tie sits to the back of the assembly, out of the flow.

6. Place the strap so you are behind the sensor looking upstream.



Upstream is preferred, but not critical as this can be reversed in FloCom+ software. Ensure that minimum straight pipe requirements are still met

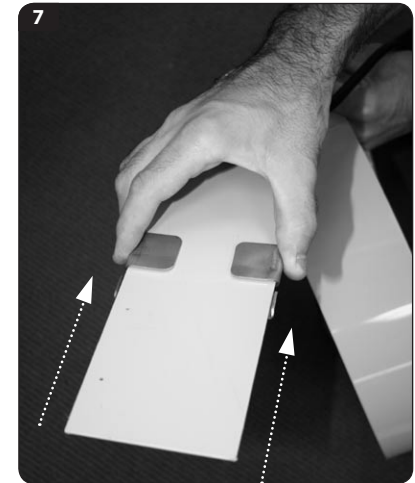

7. A stainless steel buckle is provided. Slide the buckle onto the mounting strap as shown.

8. The left side of the strap will simply run through the buckle. The position of the buckle on the left side of the strap determines the diameter of the hoop. Therefore, the largest diameter occurs when you first place the buckle on the strap. The right side of the strap curves around inside the left and tucks into the buckle. Pick up the left side of the mounting strap and curve it over to form a semi circle.

9. Bring the right side of the strap up, inside the left and tuck into the mounting strap. The strap should now form a complete hoop.

10. Position the buckle so that the whole assembly is slightly too large to comfortably fit in the pipe

11. Now, form a 'Z' at the creases in the strap as shown below.

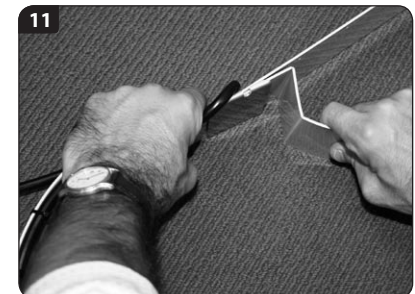

6.0 Installing a sensor on a plastic strap - *Continued*

12. Hold the 'Z' with one hand, the sensor with the other and place the assembly into the pipe reaching as far as is comfortable. Ensure that the sensor is parallel to the flow and in the bottom part of the pipe, off set to either side (if there is a build up of debris the sensor will not get covered)

13. Press out the 'Z' in the hoop with the palm of your hand. The strap will 'snap' into place. You won't be able to move the mounting strap up or down the pipe by hand if done properly.

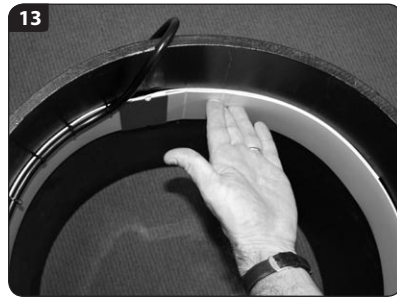
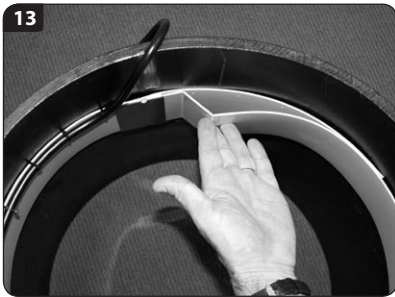

14. Carefully route the cable from the sensor back to where the electronics box will be mounted as described in installation of insertion sensors.



Particular care should be taken when routing cables to ensure that moisture CANNOT enter the connector or the air reference line of the sensor cable as permanent damage may occur

15. To remove, open the strap by wedging a screwdriver into the flattened 'Z' and bearing down on the strap.



7.0 Installing a sensor using the mounting plate

The mounting plate consists of a plastic plate with four 6mm clearance holes.

1. Attach the sensor head securely to the mounting plate by the six 3mm screws supplied (M3 x 8 mm Phillips head countersunk 304 s/s).



Use only a hand screwdriver. Do not over tighten these screws as permanent damage to the thread may result

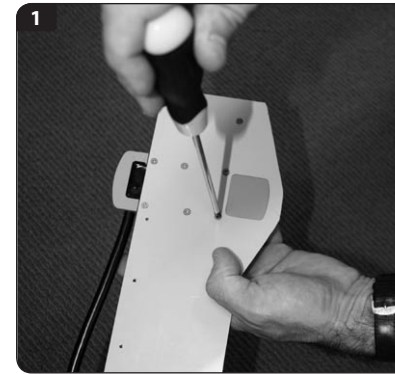

2. Tie the cable to the mounting plate using the holes and cable ties provided. Make sure that the knob of the cable tie sits to the back of the assembly, out of the flow.

3. The cable from the sensor to the instrument should then be run inside the pipe and secured to the pipe in such a manner as to prevent damage by debris in the pipe. For example, in most cases the cable should be routed through electrical conduit.

4. Using a fixing method that is suitable for the pipe material, the sensor plate should be attached to the pipe or channel in a position such that the sensor is always facing parallel with the pipe.

5. Carefully route the cable from the sensor back to where the electronics box will be mounted as described in installation of insertion sensors.



Particular care should be taken when routing cables to ensure moisture CANNOT enter the connector or the air reference line of the sensor cable as permanent damage may occur

8.0 Installing FloPro power options

8.1 Solar panel installation on a 2" pole

The solar panel is used to charge the internal battery of the FloPro Series 3 where mains power is unavailable.



Users are advised to ascertain the suitability of solar panels for their application by checking relevant solar radiation maps for their region (for example those found at http://rredc.nrel.gov/solar/old_data/nsrdb/redbook/atlas/). As a guideline, for a FloPro with three Doppler sensors and measuring every five minutes, at least three hours sunlight is required per day

1. Place an M8 bolt with M8 flat washer through the hole in left arm of the mounting bracket. Ensure that the head of the bolt is on the INSIDE and the thread faces outward.
2. On the OUTSIDE of the bracket, place an M8 spring washer then an M8 nut. DO NOT TIGHTEN THE NUT.
3. Repeat these two steps on the right hand side of the bracket.
4. Holding the solar panel carefully, hold it above the two arms of the mounting bracket.
5. Slide the solar panel down so that the head of each of the M8 bolts fits in the channel on either side of the solar panel.

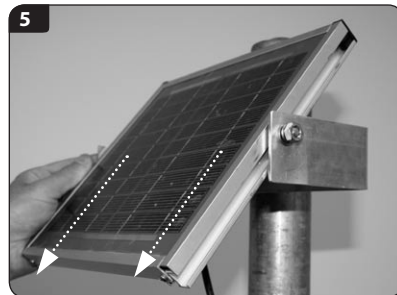
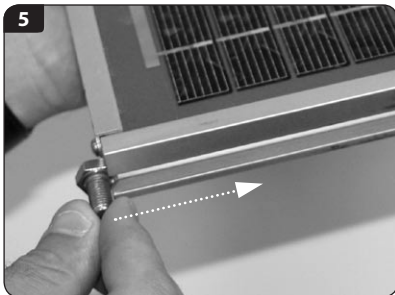

Ensure that the gutter of the solar panel is positioned between the flat washer and the head of the M8 Bolt

7. Place the u-bolt provided in the solar panel mounting kit around the pole.

8. Place the solar panel mounting bracket onto the u-bolt. Ensure that the arms of the bracket face out from the pole and that the mounting hole on each arm is towards the top of each arm.

9. Slide the bracket to the desired position on the pole, taking care to place it at the desired height and so that the open face of the bracket faces towards the sun.

10. Place the $\frac{3}{8}$ " flat and spring washers on to the U-bolt and tighten the two nuts so that the bracket is secured on the pole.

11. Tilt the solar panel so that the active side faces towards the sun (North in Southern hemisphere, South in Northern hemisphere) at an angle specified in the data sheet provided. (your latitude + 15°).

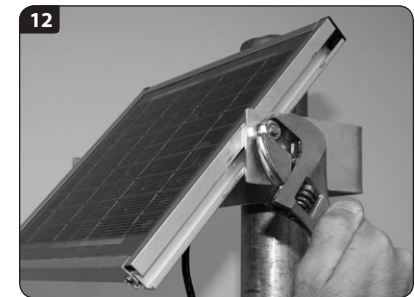
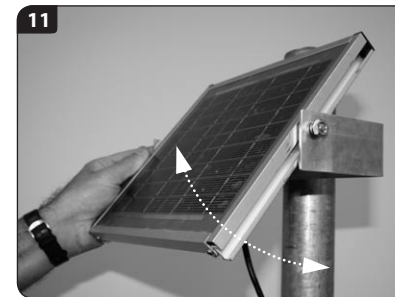

12. Now tighten the M8 nuts on each side of the mounting bracket to secure.

13. The cables from the solar panel/charger to the electronics unit must be enclosed to minimise exposure to the elements. The cable should be either routed through conduit or through the solar panel mounting pole. You will need a hole drilled in the mounting pole at the top near the solar panel as well as a cut away where the electronics unit is to be mounted. Refer to the pictures below.

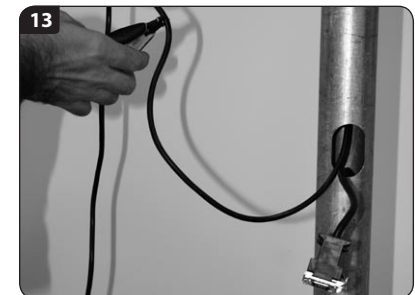

8.1 Solar panel installation on a 2" pole - Continued

14. Ensure that the cable from the solar panel is terminated using the three-pin connector provided in the electronics box and that the polarity is correct. The photo below shows the location of the three-pin connector inside the FloPro.

15. The polarity is labelled on the circuit board near the connector.

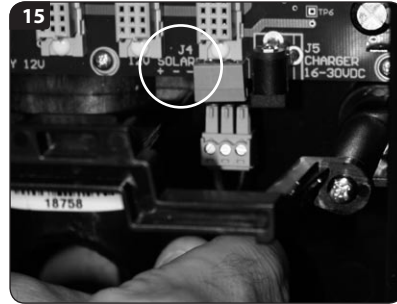
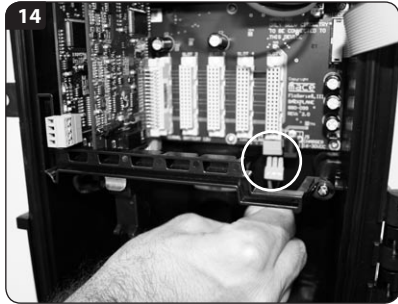

! **NOTE:** The electronics module should be installed before connecting the solar panel. Refer to the next chapter on the electronics module for more detail

! **MACE highly recommends the use of Tri-spikes on the top of the solar panel to reduce accumulation of bird droppings on the front face of the solar panel**

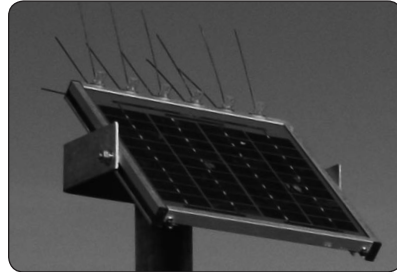

8.2 Installing a MACE mains powered trickle charger

In certain applications or where the use of a solar panel is impractical or undesirable, the FloPro can be powered from any DC source of 16-30 Volts (2Amps).

! **When the ambient temperature is less than -10°C (14F), the battery should be removed to avoid permanent damage to the battery. The FloPro should be powered by an external power source**

1. The charger available from MACE (Part No. 850-323) comes complete with a circular barrel connector that plugs directly into the electronics module. See photos over page.

! **The barrel connector for the 16-30VDC charger input is centre positive**

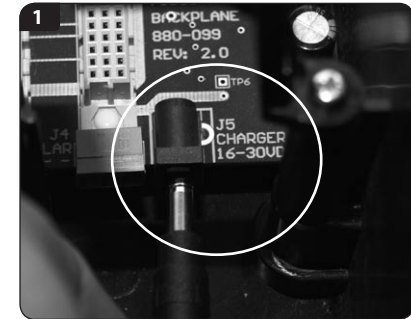

2. Alternatively, if a DC source other than a MACE charger is used, this is terminated using the same three-pin connector as for the solar panel described above.

8.3 Powering the FloPro with an external battery

In certain applications, it may be desirable to power the FloPro with an external battery.

1. The Series 3 FloPro can be powered by an external 12V battery through the dedicated "External Battery 12V" terminal. See photos below.

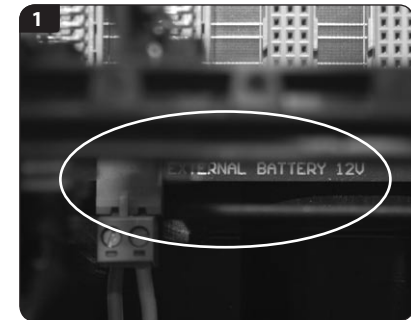
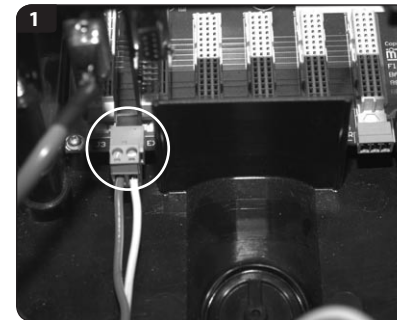

2. If a solar panel is connected to the FloPro as in Chapter 8.1, the internal charging circuit of the FloPro will also charge the external battery. The charging circuitry of the FloPro has a 20 Watt capacity.

! **If the external battery is charged via its own solar panel and NOT through the FloPro charging circuit, the internal FloPro battery will discharge completely**

9.0 Electronics module

The electronics module is the central processing unit of the FloPro Series 3. It includes the enclosure, battery and circuit boards that control the device.

On the front of the FloPro Series 3, a liquid crystal display (LCD) allows the user to see an on-site readout of channel information and status messages.

The membrane switches can be used to scroll the display between the various parameters.

A serial communications port is located on the bottom face of the main enclosure. Using the MACE serial data cable (Part No. 891-300) between this port and a PC, users can configure, troubleshoot and download the device.

ELECTRONICS MODULE - FRONT

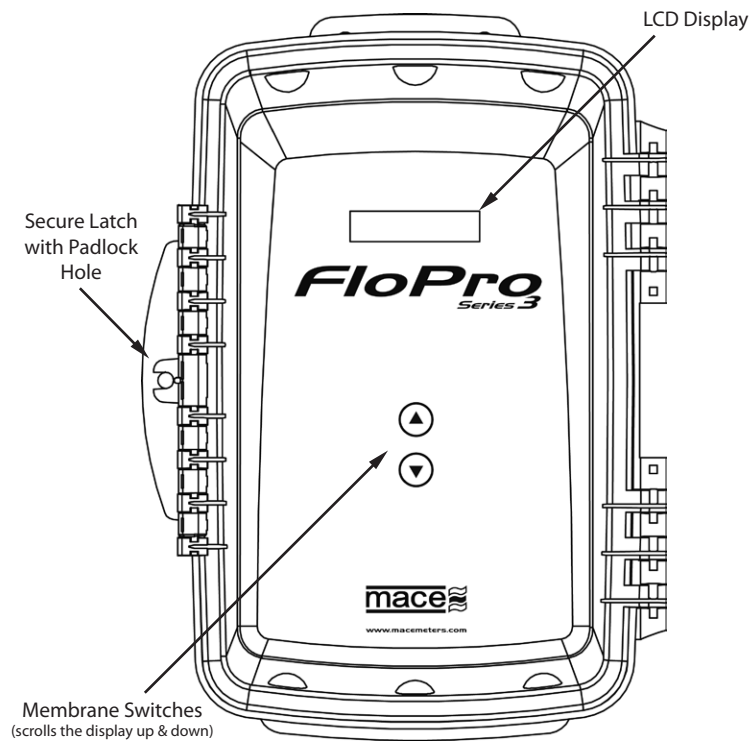

ELECTRONICS MODULE - INSIDE

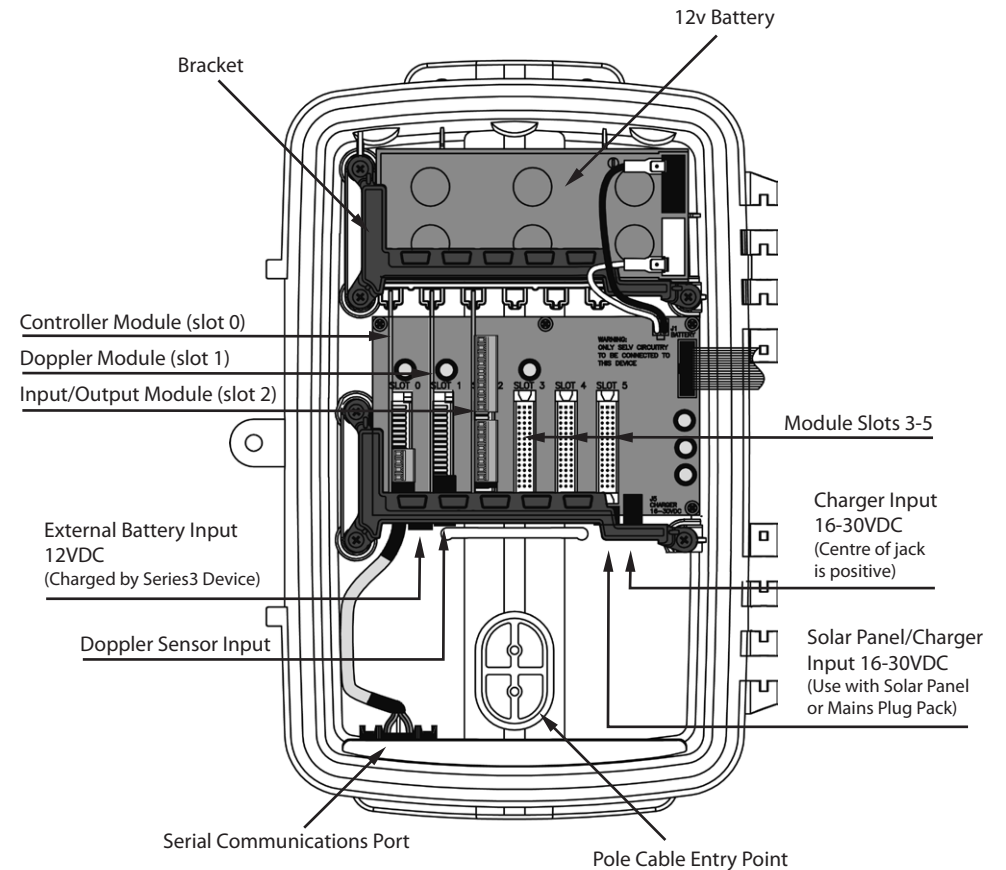

ELECTRONICS MODULE - UNDERSIDE

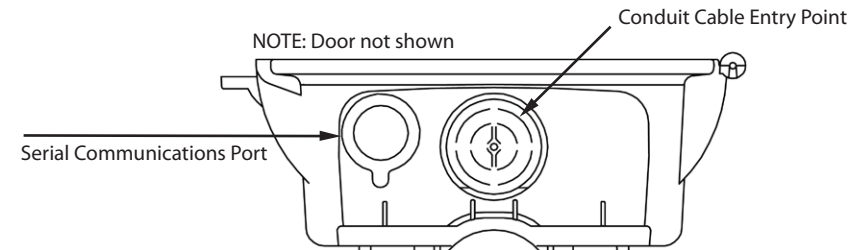

10.0 Installing the FloPro on a 2" pole

The sensor and power cables can be routed either directly through the inside of the 2" mounting pole or through electrical conduit. Installation directions for both are provided below.

! MACE recommends that the FloPro Series 3 electronics module be mounted so that the LCD faces in a direction away from direct sunlight.

10.1 Sensor and power cables routed inside the pole

1. Place the electronics module on a work bench and using a hammer and screwdriver carefully knock out the plastic cable entry point from the rear of the enclosure. It is only thin plastic and is designed to break away at the edges so work your way around the edge of the oval shape until the cover is completely broken free of the unit.

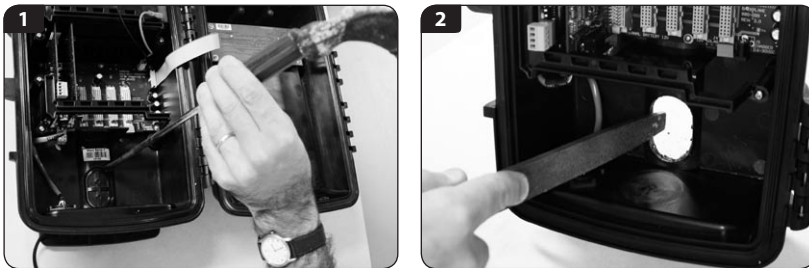

! **IMPORTANT:** Apply NON-ACIDIC cure silicon sealant to the back of the electronics module in the channel around the cable entry point. This will stop water flowing down the pole and into the electronics module.

2. File away any rough edges from the plastic cable entry point
3. Hold the electronics module up against the pole so that the oval cut-away on the pole matches the cable entry point. Route the sensor and power cables through the cable entry point as shown.

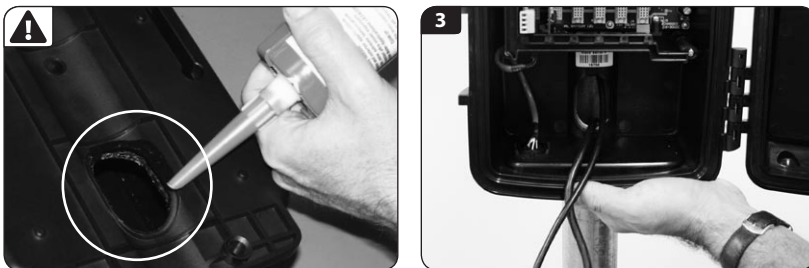

4. Use the two "U" bolts, $\frac{3}{8}$ " nuts and $\frac{3}{8}$ " washers provided to secure the electronics module to the pole.

! Do not overtighten the pole mounting bolts as permanent damage may occur to the electronics enclosure

5. Plug in both the sensor cable and solar panel cable into the sockets as shown in the picture below.

! The Doppler sensor cable should be looped prior to connecting to act as a form of strain relief. Ensure that the sensor cable is securely attached by squeezing the slidlock and latching it in place

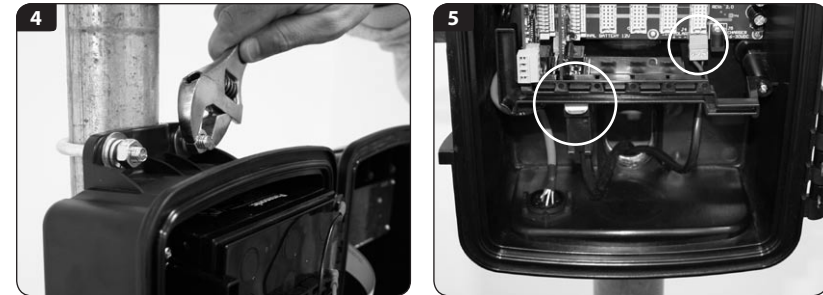

! Ensure that the cable from the solar panel/charger is terminated using the three-pin connector provided in the electronics box and that the polarity is correct. The polarity is labelled on the circuit board near the connector

6. If using a 16-30VDC mains charger then plug this into the socket shown in the picture below. Alternatively, the charger may be wired into the solar panel screw terminal block (to the left of the socket).

7. Once all the cables are connected the system should be fully tested. Assuming everything is connected and fully functional the cable entry point should be filled with expanding "space filler" foam. This is to prevent insects and/or moisture damaging the system.

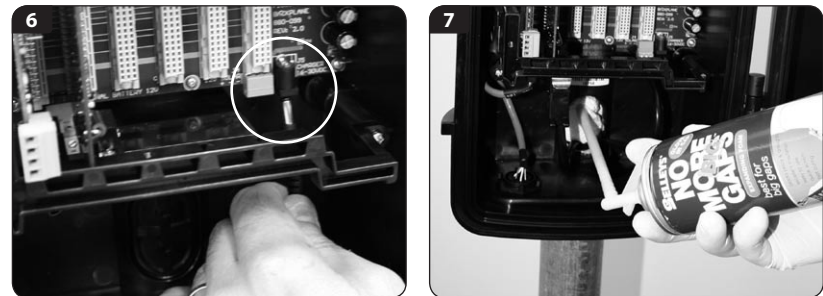

10.2 Sensor and power cables routed through conduit

1. Place the electronics module on a work bench. Using a power drill and 2" holesaw, carefully drill out the round plastic cable entry point at the base of the unit as shown below. It is only thin plastic and is designed to break away. Alternatively, the round cable entry point may be removed using the "hammer and screwdriver" method described in **Chapter 10.1**.
2. Use the two "U" bolts, $\frac{3}{8}$ " nuts and $\frac{3}{8}$ " washers provided to secure the electronics module to the pole.

! Do not overtighten the pole mounting bolts as permanent damage may occur to the electronics enclosure

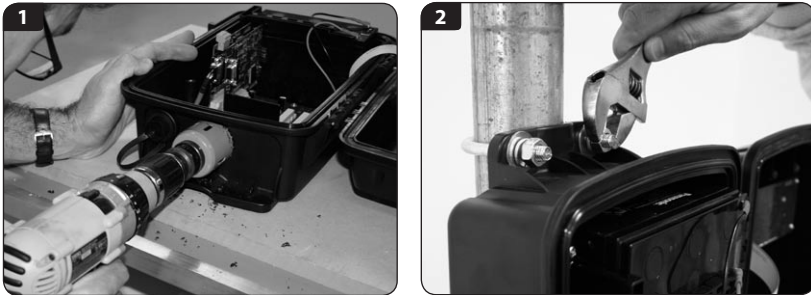

3. Carefully attach an electrical conduit adaptor (*Clipsal 50mm or Carlon 1 1/2"*) to the electronics module.
4. Plug in both the sensor cable and solar panel cable into the sockets as shown in the picture below.

! The Doppler sensor cable should be looped prior to connecting to act as a form of strain relief. Ensure that the sensor cable is securely attached, by squeezing the slidelock and latching it in place

! Ensure that the cable from the solar panel/charger is terminated using the three-pin connector provided in the electronics box and that the polarity is correct. The polarity is labelled on the circuit board near the connector



5. If using a 16-30VDC mains charger then plug this into the socket shown in the picture below. Alternatively, the charger may be wired into the solar panel screw terminal block (*to the left of the socket*).

6. Once all your cables are plugged in you need to fully test the system. When you are happy that everything is connected and working properly you need to fill the cable entry point with expanding "space filler" foam. Fill down the first 5 to 10cm (2" to 4") of the conduit. This is to prevent insects and/or moisture damaging the system.

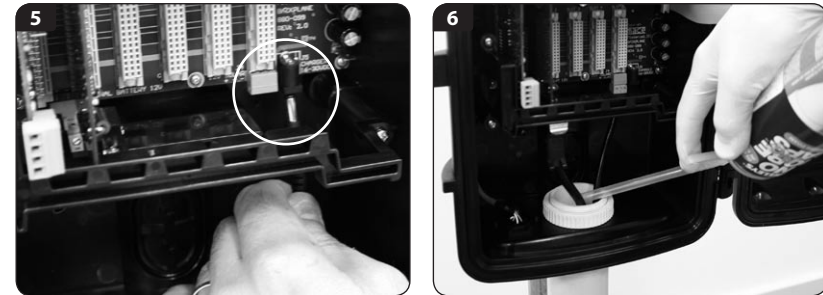

11.0 Installing the FloPro on a wall

1. Follow instructions on the previous page to drill out the cable entry point for routing cables through conduit.
2. Use four M8 screws, bolts or coach screws to secure the box to the wall. (*Use flat washers between the screw head and the box*).

! Do not overtighten the wall mounting bolts as permanent damage may occur to the electronics enclosure

3. Follow instructions 3-6 on the previous page for routing the cables through conduit.



12.0 The I/O (Input/Output) card

The I/O card (module) supplied in the FloPro Series3 provides the inputs for connecting environmental monitoring sensors and outputs for connection to ancillary devices.

The input and output terminals available on each I/O card are shown in the diagram below.

- !** **MACE recommends the user studies the relevant documentation supplied with each third party sensor prior to connection**
- !** **WARNING: The maximum system current available for powering sensors attached to ALL I/O cards is 1.25 Amps at 12VDC**
- !** **WARNING: The maximum input voltage on any terminal is 30VDC**

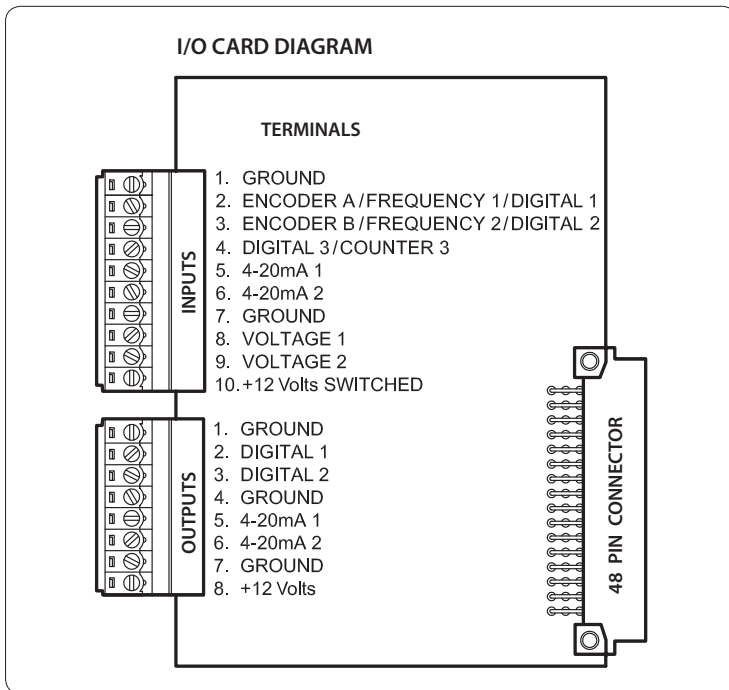

- !** **Should insufficient I/O be available on a single I/O card another card (Part No. 850-329) should be purchased. FloPro Series 3 supports a maximum of four I/O cards**

13.0 Wiring digital inputs

13.1 Frequency Input

Each I/O card provides up to two frequency inputs for connecting devices such as ultrasonic depth sensors and/or flow meters. The frequency input terminals available on each I/O card are shown in the diagram below.

- !** **NOTE: If a frequency input is wired a shaft encoder input is not available**

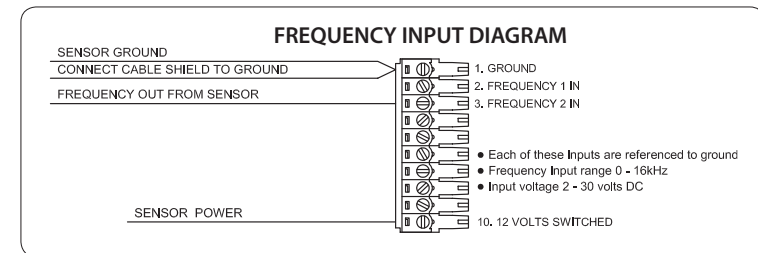

13.2 Digital or Counter Input

Each I/O card provides up to three digital inputs or one counter input for connecting devices such as rainfall gauges, hours run meters and/or counting pulses. The digital/counter input terminals available on each I/O card are shown in the diagram below.

- !** **NOTE: If a shaft encoder input is wired only a single digital/counter input is available**

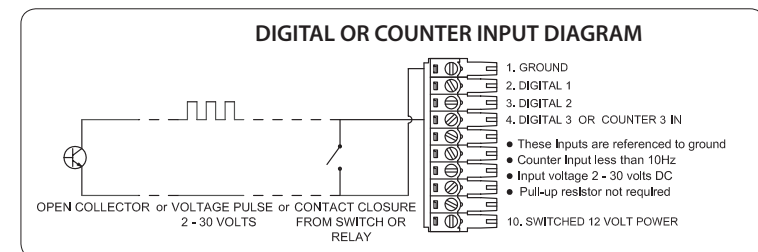

13. Wiring digital inputs - Continued

13.3 Shaft Encoder Input

Each I/O card provides one input for connecting a shaft encoder. The shaft encoder input terminals available on each I/O card are shown in the diagram.



NOTE: If a shaft encoder input is wired only a single digital/counter input is available. NO frequency input is available

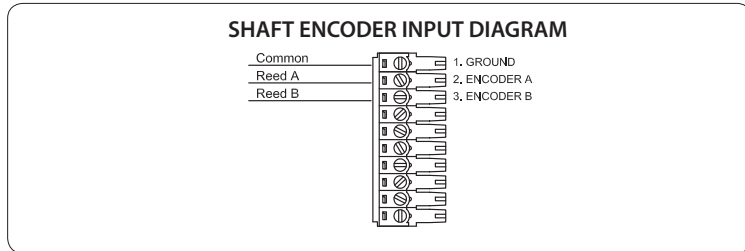

Should the field application require a shaft encoder and a frequency input another I/O card (Part No. 850-329) should be purchased

14.0 Wiring analogue inputs



NOTE: 12 VDC sensor power is available on terminal 10 of the input terminal strip. This is a switched power supply and the warm up time for sensors that require power is configurable using FloCom+ software. FloCom+ is available for download from www.macemeters.com

14.1 Two - Wire 4-20mA Input

Each I/O card provides up to two 4-20mA inputs for connecting devices such as ultrasonic depth sensors and/or flow meters. The 4-20mA input terminals available on each I/O card are shown in the diagram below.

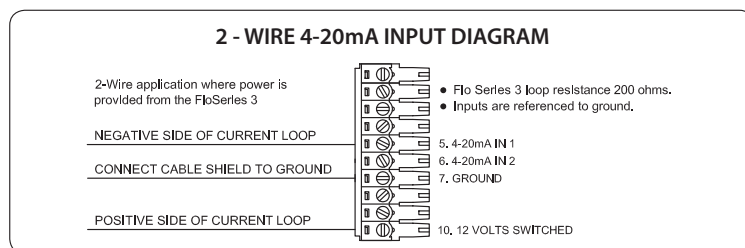

14.2 Three - Wire 4-20mA Input

Each I/O card provides up to two 4-20mA inputs for connecting devices such as ultrasonic depth sensors and/or flow meters. The 4-20mA input terminals available on each I/O card are shown in the diagram below.

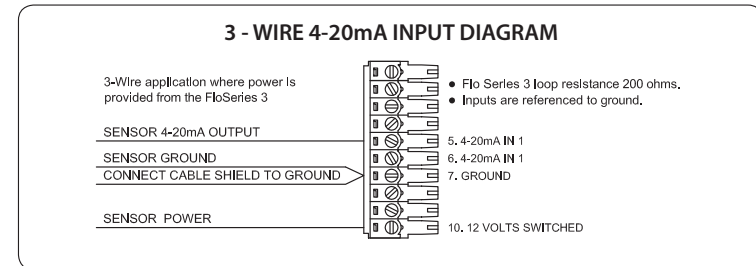

14.3 Voltage Input

Each I/O card provides up to two voltage inputs for connecting devices such as ultrasonic depth sensors, conductivity probes and/or temperature sensors. The voltage input terminals available on each I/O card are shown in the diagram below.



NOTE: The input voltage range can be either 0 - 2.5 VDC or 0 - 30 VDC

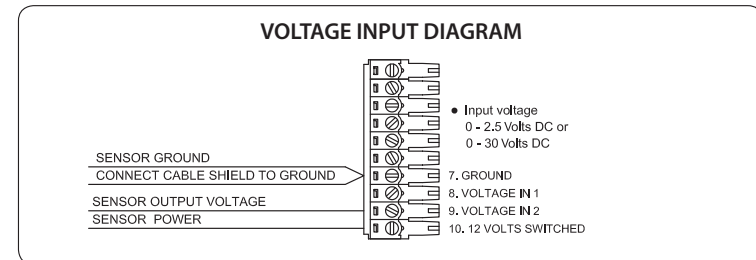

15.0 Wiring digital outputs

Digital Output

Each I/O card provides up to two digital outputs for sending pulses to devices such as water samplers and/or data loggers. The digital output terminals available on each I/O card are shown in the diagram below.

NOTE: The pulse output consists of a 50 millisecond pulse with a 50 millisecond space between pulses

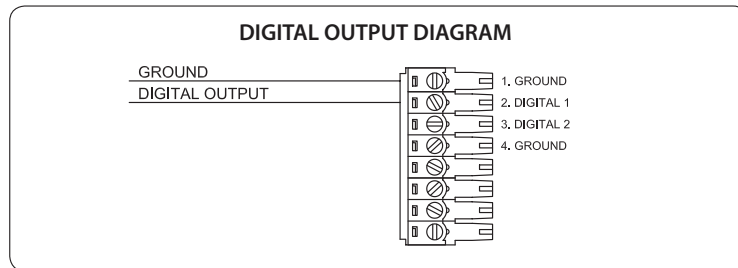

16.0 Wiring analogue outputs

4-20mA Output:

Each I/O card provides up to two 4-20mA outputs for sending signals to devices such as SCADA systems and/or PLC's. The 4-20mA output terminals available on each I/O card are shown in the diagram below.

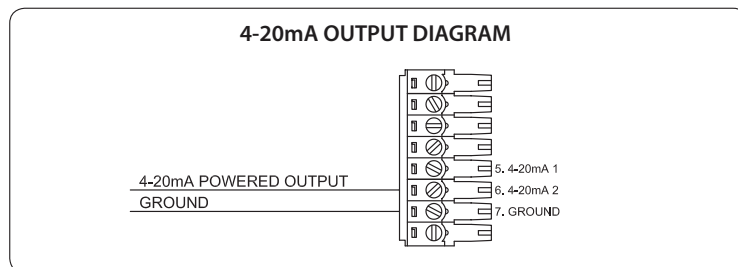

17.0 Installing additional cards

! Users are advised to download data and stop the FloPro prior to installing additional cards

1. Open the Series3 enclosure and remove the three screws (using a #2 Phillips screwdriver) fastening the PCB clamping bracket. Take care not to drop screws in the box as damage may occur to the circuitry.

! IMPORTANT: Before removing card from packaging you MUST earth yourself by touching one of the screws on the display module

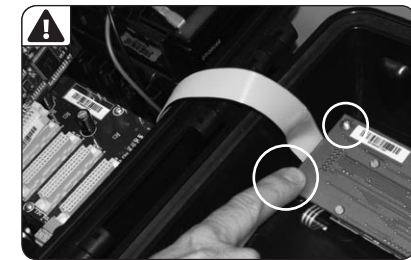
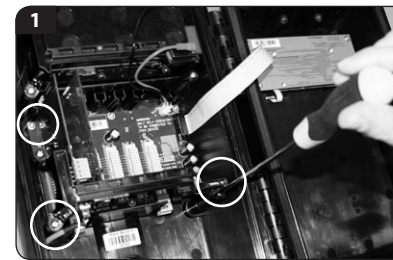

3. Remove the MACE Series3 card from its packaging. Position the new card in your hand such that the large cream 48-pin connector is facing down and aligned with the mating connector on the backplane PCB.

4. **Earth yourself again.** Your finger must remain earthed on the screw whilst carefully inserting the card into any spare slot. Take care to align the pins of the two connectors together. There is a slot at the top of the card area that helps the alignment process. Ensure that the card is contained within this slot and press down firmly to ensure that it is seated fully.

5. Replace the PCB clamping bracket ensuring that the slots in the underside of the bracket are aligned with the tops of all the cards. Fix the bracket into place with the 3 screws. **DO NOT over tighten the screws.**

6. Connect to the instrument with a PC and configure the card using FloCom+ as detailed in the software section of this manual.

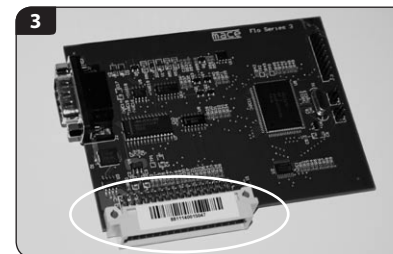

18.0 Installing a Series3 FloSI card

The Flo Series Serial Interface (FloSI) is an optional upgrade module for Flo Series3 devices. The FloSI provides unconditional polling access to the most recent user configured measurement results of Flo Series3 devices.

The FloSI requires no routine maintenance and has no user serviceable components.

Configuration of the FloSI requires MACE Flocom+ software and successful PC communications with a MACE Flo Series3 device. The FloSI configuration settings are available from the settings menu of Flocom+ as described in the software section of this Manual.

Installing the FloSI Card

Install the FloSI card as per the procedure outlined in the previous *Chapter 17.0 Installing additional cards*.

Wiring the FloSI

After installing the card, connect it to the remote device using either:

1. The 9-pin d-connector (RS232, ASCII or RS232 ModBUS) for RS232;
2. The 4-way terminal block for RS485 ModBUS mode;
3. The 3-way terminal block for SDI-12 mode.

Pin out details for the various connectors are printed on the back of the FloSI card and below:

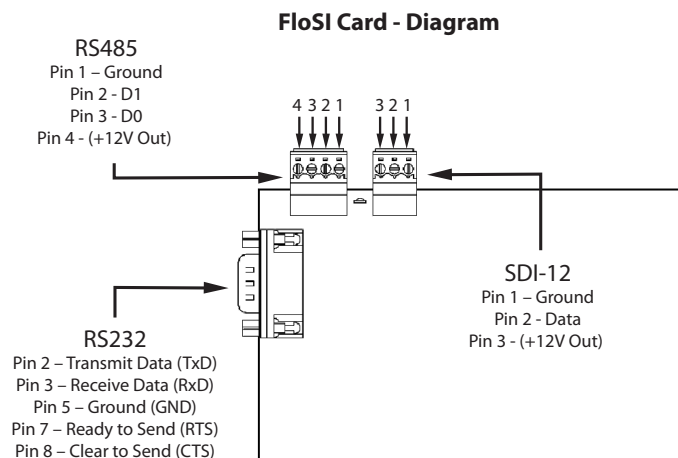

19.0 Maintenance

Depending on the physical location and the type of flow being monitored, the FloPro Series 3 may require regular maintenance. Should the instrument require servicing, it must be returned to your vendor.

19.1 Battery maintenance

The FloPro Series 3 internal battery, if kept fully charged should last many years. However, if the battery remains flat for an extended time, it may be damaged and should be replaced. Contact your vendor for a replacement battery.

19.1.1 Removing the damaged/flat battery

1. Disconnect the battery cable assembly from the backplane board.
2. Carefully hold the battery in position.
3. Use a #2 Phillips head screwdriver to remove the three screws which fasten the battery bracket to the main enclosure.
4. Carefully remove the battery from the main enclosure.
5. Disconnect the battery cable from the battery terminals.

19.1.2 Installing the new battery

1. Connect the battery cable to the new battery, with the red lead to the positive terminal of the battery and the black lead to the negative terminal.
2. Place the battery in the main enclosure and hold it in place.
3. Secure the new battery in place using the battery bracket and three screws.
4. Tighten all three screws.
5. Reconnect the battery cable assembly to the backplane board.

! Damage to the FloPro Series 3 caused by incorrect battery replacement will void the warranty

! Using a battery that is not approved MAY damage the FloPro Series 3 and void the warranty

19.2 Solar panel maintenance

The solar panel should be checked regularly for build up of solids such as dust and bird droppings. These type of build-ups can affect the performance of the solar panel and result in a decrease of the charge that is received by the internal battery. The solar panel should be cleaned with a wet brush or rag.

! Do not use steel bristle brushes that may cause damage to the glass of the solar panel

19.3 Sensor maintenance

To ensure trouble free data collection, sensors mounted in the flow should be kept free of built up debris, silt or grease. This is done by using a stiff bristle brush and carefully cleaning the sensor head and surrounding area. This process should be repeated as often as necessary in order to keep the sensors clean. Also check the sensor cable for physical damage.

 **WARNING: Do not use steel bristle brushes that may cause damage to either the MACE velocity or depth sensors.**

 **WARNING: For third party sensor maintenance refer to the documentation supplied with your sensor/s.**

19.4 Depth sensor reference filter maintenance

The ceramic depth sensor used by the FloPro Series 3 measures the hydrostatic pressure of the stream depth. This sensor is vented to atmospheric pressure via a vent tube inside the sensor cable, which passes through a filter before entering the silica gel canister that is attached to the sensor connector and housed within the FloPro Series 3.

In order to keep the depth sensor working properly, this vent tube must always remain free from moisture.

The silica gel crystals contained within the reference filter effectively entrap atmospheric moisture. However, these crystals require changing regularly to ensure that they are still effective.

The silica gel crystals used in the FloPro Series 3 are an indicator type. When fresh they are a deep blue in colour and when exhausted they are light pink. The crystals should be replaced when they first appear to be light pink. The following procedure should be followed to change the crystals:

1. Remove the large rubber stopper on the bottom of the filter housing. (*This is the stopper without the tube attached*).
2. Empty the filter chamber of exhausted crystals.
3. Add new crystals (MACE Part No. 590-009) to the filter chamber so that there is enough room for the rubber stopper to be replaced.
4. Replace the rubber stopper.

 **Ensure that the reference filter tube is not crimped as a blockage will result in incorrect depth readings from the sensor**

 **The longevity of the silica gel crystals is dependent on the amount of moisture in the atmosphere in which the instrument is mounted. It is recommended that the crystals be checked at least on a monthly basis**

 **Do not eat the crystals. Wash hands after use**

This page left intentionally blank

Section B:

Software Manual

FloCom+ for Mace FloPro Series 3

20.0 Introduction to FloCom+

This manual describes FloCom+ and way it is used to configure, calibrate and extract data from MACE Flo Series3 devices.

System Requirements

Minimum system requirements for PC are:

- Windows® XP
- 4Mb available hard drive space
- Serial port or USB to Serial Adapter
- FloCom+ Version 1.1.0.12 (*minimum requirement*)

Windows is a registered trademark of Microsoft Corporation in the United States and other countries.

MACE Software End User License Agreement (EULA)

Users should read and accept the terms of the MACE EULA before installing FloCom+ on their PC. The EULA can be found on the downloads page of the MACE website, www.macemeters.com



IMPORTANT: The minimum version of FloCom+ required to communicate with the FloPro Series3 is **Version 1.1.0.12**. You can check the version number by clicking "Help" from the main menu and clicking "About FlocomPlus". The latest version of FloCom+ is available for download from www.macemeters.com

21.0 Installing the software

Download FloCom+ from our website www.macemeters.com

1. Run the “*FlocomPlus_[version number].exe*” file to start the installation process.
2. Follow the instructions on the welcome screen then click the “*Next*” button to move to the next screen.
3. Choose a location on your computer to install FloCom+. FloCom+ will setup a folder in your program files called “*Mace\FlocomPlus*”. This is the default option. Click the “*Next*” button to continue
4. Backing up replaced files. FloCom+ will ask if you wish to create backups of replaced files. We advise you to click “*Yes*” and then click the “*Next*” button.
5. Selecting a Program Manager Group. “*Mace utilities*” is the default group and we suggest leaving this as is.

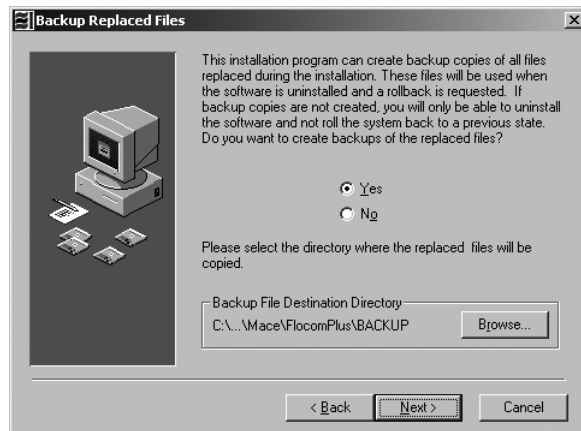

6. Starting installation. Click “*Next*” to begin installing FloCom+.

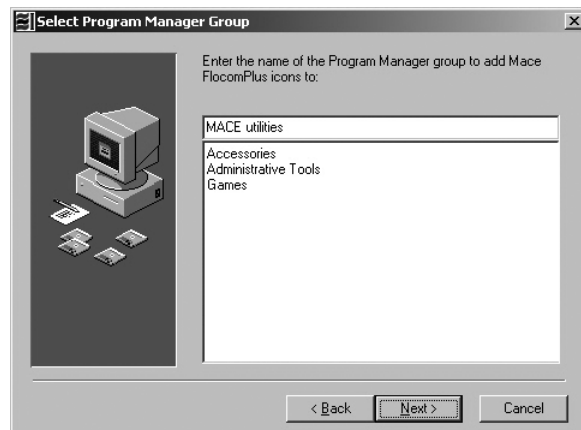

7. FloCom+ will now install. Once the software installation is complete click the “*Finish*” button to exit the setup program. FloCom+ is now ready to be used.
8. Run FloCom+ using the shortcut provided on your desktop. The startup menu will appear as shown below. Click “*File>Comms settings...*” to configure FloCom+ for your computer.

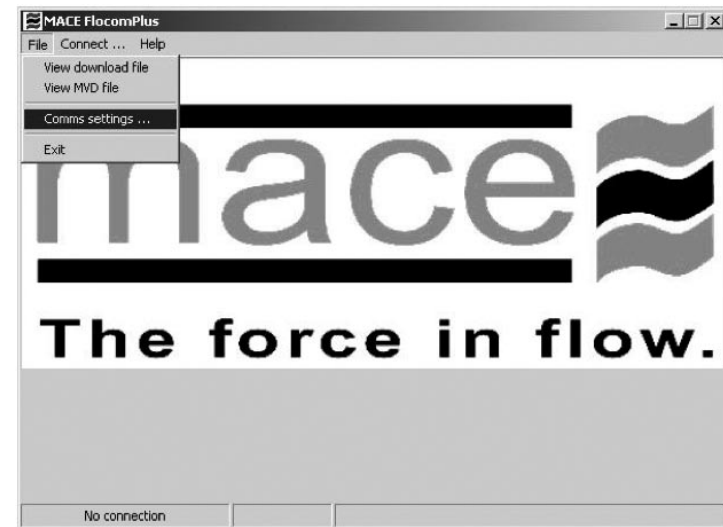

9. Select the serial port of your computer which will be used to communicate with the Flo Series3 device when a local connection will be made (i.e with a serial cable directly connected to the device).

! If using a USB to Serial adapter please refer to the product documentation supplied with the adapter to ensure the correct driver is installed

If one is present, select the modem which will be used if remote communication will take place with the device. (The Flo device must also have a modem attached to it at the remote site).

Click “*Apply*” to save the settings.

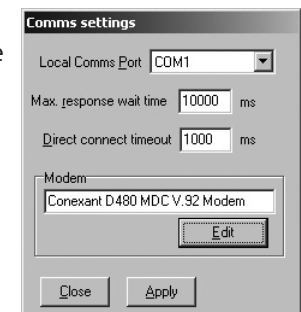

22.0 Connecting to the device

22.1 Connecting to the device using the serial port

1. Unscrew the cover from the serial port.
2. Connect a MACE serial cable (Part No. 891-300) between the serial port of the computer and the serial port of the FloSeries3 device located on the underside of the electronics module.
3. Click **"Connect>direct"**.

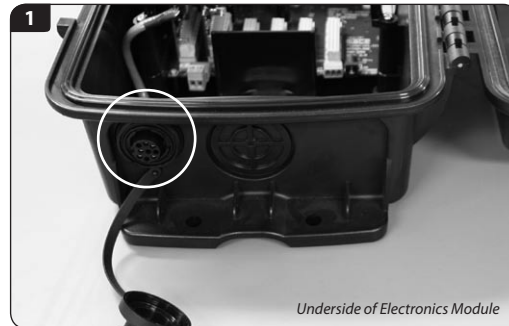

Enter the password which has been set in the unit and select continue. (The default password is **"superid"**).

4. The main menu which includes the device status summary screen is now visible as shown below.

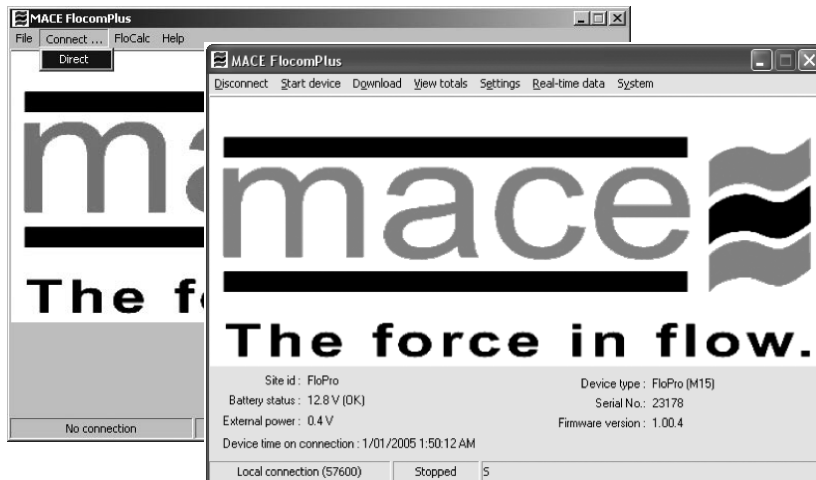

- !** The device must be configured and started before the instrument will measure and record data
- !** Once finished, remove the MACE serial cable and screw the serial port cover back in place to maintain environmental protection

22.2 What to do if the password is lost/forgotten

In the event that you have forgotten or lost your password, the following steps should be taken.

1. From the **"MACE FloCom Plus"** main screen, click **"Help>Show device authorisation code"**.
2. Click **"Connect>Direct"** and the **"Connect to device"** dialogue box will appear.



3. In this dialogue box the device's unique authorisation code is seen at the bottom.

- !** You **MUST** note this code **EXACTLY** to fulfil the next steps
- 4. The unique device serial number located on an adhesive label inside the box should also be noted. This will be used to verify the history of the device.
- 5. Once you have noted the code and serial number, you must contact your local MACE dealer/distributor and inform them of these details. They will obtain a **"counter-code"** for your device.

- !** You will be required to prove that you have the authority to access the device prior to a **"counter-code"** being issued. For a billing device, only an official of the water distribution authority will be given the **"counter-code"**. No exemptions from this requirement will be given

6. From the **"MACE FloCom Plus"** main screen, click **"Connect>Direct"** and the **"Connect to device"** dialogue box will appear.

- !** This **"counter-code"** has a time limit on its validity (typically three days). It must be used to access the unit within this time or it will be void and a new one will need to be produced

Enter the 16 digit authorisation **"counter-code"** into the **"Password"** field and click **"continue"**. You will now have super user access to the device.

- !** You should immediately change the super password to one that will not be forgotten (see Chapter 23.3 for details)

23.0 System information

From the main menu click **“System”** and the following menu options will appear as listed below:

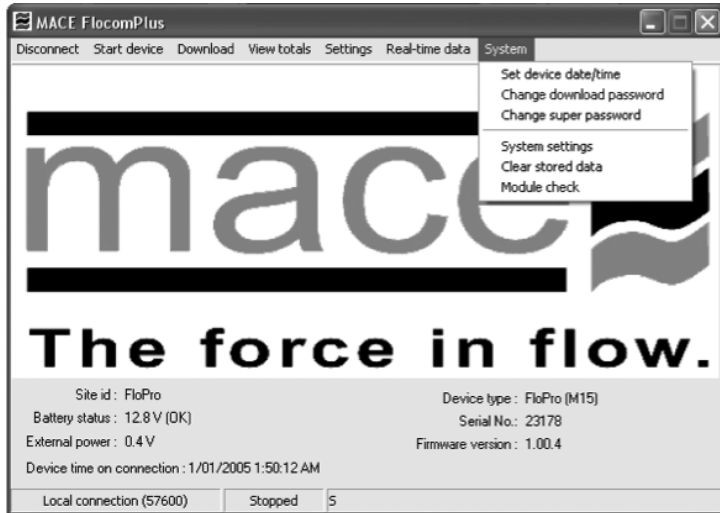

23.1 Set device date/time

The device date and time must be set correctly, so that data can be accurately matched to known time intervals.

- The date and time can be set by manual entry or by synchronizing with the computer time.
- The time is held in 24 hour time.
- Allowance can be made for daylight savings time.



23.2 Change download password

The download password allows low level access to the device. When this password is used for entry to the device, channel totals may be viewed and data can be downloaded.

Many irrigation districts give this password to irrigators to allow them to use the data for water management operations.



23.3 Change super password

The super password allows high level access to the device. When this password is used for entry to the device, all editing functions (including data downloading) are allowed. Most irrigation districts set this password to prevent non authorized access to the device.

! Both the super and download passwords are case sensitive.



23.4 System settings

The system settings function allows the user to change the measurement units from metric to U.S and vice versa.

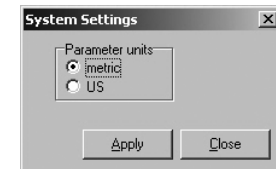

23.5 Clear stored data

This function should only be used by high level users. It clears all stored data from the device including all time stamped flow rate data.



23.6 Module check

This function provides the user with a simple method of identifying the FloSeries3 modules which are currently installed in the device.

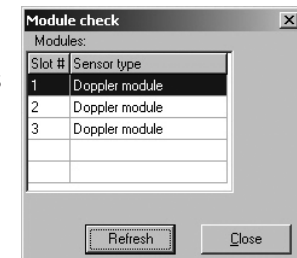

24.0 FloPro settings dialogue box

The procedure for configuring a FloPro is structured in a logical sequence so that the FloPro is configured in the correct order. For example, in the “*FloPro Settings*” dialogue box (shown below) the user must “*Configure modules*” prior to being able to “*Configure channels*” and “*Configure outputs*” (these buttons are greyed out so they cannot be accessed until you have configured a module). FloCom+ uses this logical sequence throughout the entire configuration process to minimise user error.

The essential steps to configure your FloPro Series3 are listed below.

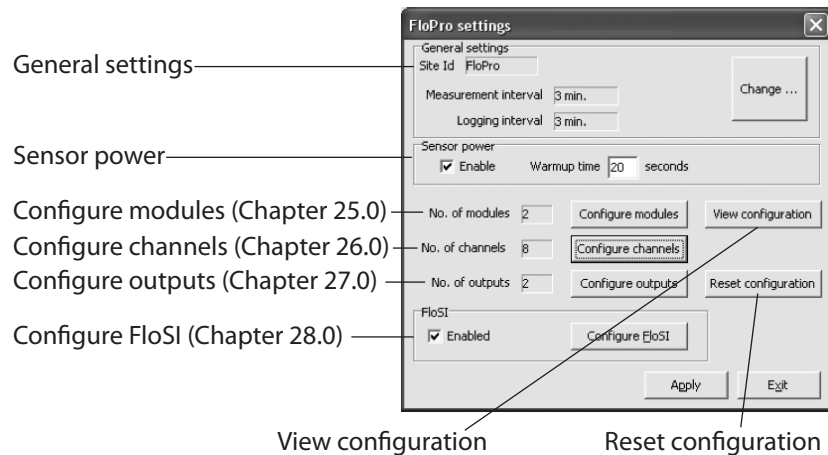

Essential Steps to configure your FloPro Series3

- | | |
|-------------------------------------|--------------|
| 1. Edit General Settings | Chapter 24.1 |
| 2. Add Modules | Chapter 25.1 |
| 3. Edit Doppler Modules | Chapter 25.2 |
| 4. Add Channels | Chapter 26.1 |
| 5. Edit Channels | Chapter 26.3 |
| 6. Add Outputs (where required) | Chapter 27.1 |
| 7. Edit Outputs (where required) | Chapter 27.2 |
| 8. Configure FloSI (where required) | Chapter 28.0 |
| 9. Apply Settings | |

WARNING: Once Steps 1 - 8 have been completed, apply all settings by clicking “Apply” from the “FloPro settings” dialogue box as shown above.

24.1 General settings

1. From the main menu click “*Settings*” and the “*FloPro Settings*” dialogue box will appear as shown above.

2. Click “*Change*” and the “*General Settings*” dialogue box will appear as shown below.

Site Id

The “*Site Id*” is a text field used to identify the location of the device. When data is retrieved from the device, it will be identified by this name.

For example, the “*Site Id*” might be the name of the treatment plant or license number.

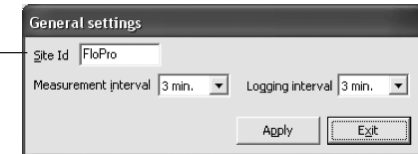

NOTE: The instrument’s “*Site Id*” is required before the FloPro configuration can be applied successfully

Measurement and Logging Interval

The measurement interval is the time at which the device ‘wakes up’ to measure/calculate the values on each of the configured channels.

Data is logged in the data file ONLY at the logging interval.

The measurement interval will always be shorter than or equal to the logging interval.

In the case of the measurement interval being shorter than the logging interval, then the data logged will be the average of those values calculated per measurement interval.

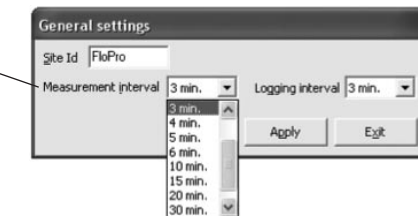

3. Click “*Apply*” and the “*FloPro Settings*” dialogue box will re-appear.

NOTE: The logging interval can only be a multiple of the measuring interval.

24.2 Sensor power

When enabled (via the check box), this function instructs the FloPro to switch the 12VDC (switched) power line ON for sensors wired to I/O card/s (refer to chapters 12-14 for wiring details).

A warmup time must be set by the user, suitable for the sensor/s application. For example, a 4-20mA output downward looking ultrasonic depth sensor may require a 20 second warm up prior to recording a stable depth reading.

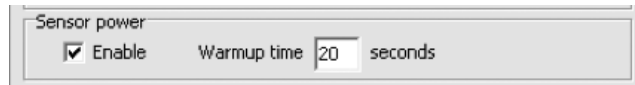

WARNING: The maximum system current available for powering sensors attached to ALL I/O cards is 1.25 Amps at 12VDC

24.3 View configuration

By clicking “View configuration” the user is able to see a tree view of all configured modules and their respective measured channels.

For example, in the “Module details” dialogue box opposite, the I/O module in card slot 2 has four measured channels. The first is named Depth #2 and the sensor is wired into the 4-20mA input number 1.

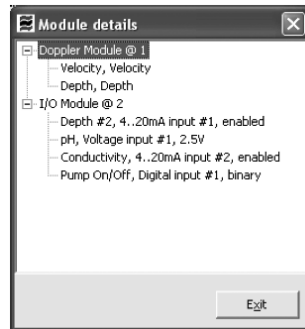

NOTE: There is no tree view available until at least one channel is configured.

NOTE: Derived channels, those that are calculated based on the values of two or more measured channels are not displayed.

24.4 Reset configuration

WARNING: Use “Reset configuration” with care.

Clicking “Reset configuration” causes all configured modules, channels and outputs to be removed.

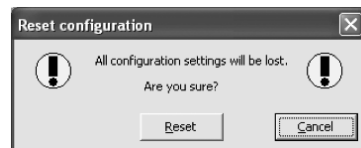

25.0 Configure modules

25.1 Adding a module

A module is defined in FloCom+ as either a MACE Doppler velocity card or a MACE I/O card.

1. From the “FloPro Settings” dialogue box click “Configure modules” and a dialogue box will appear as shown.

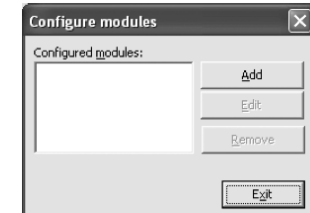

2. Click “Add” and the available modules will be listed in the “Select module” dialogue box.

3. Each MACE card available is referenced in the list by its type and slot number. (eg. Doppler module in card slot 1). Highlight the module you wish to add and click “Add module”. A “Doppler module options” dialogue box will appear if a Doppler module is added.

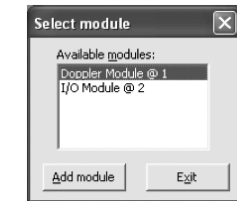

NOTE: Once a module has been added it will no longer appear on the available modules list

4. The “Configure modules” dialogue box will appear with a listing of the configured modules.

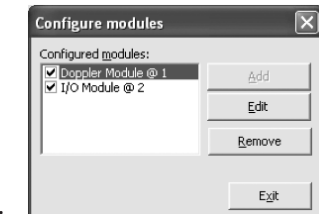

25.2 Configuring and editing the Doppler module options

1. From the “Sensor type” drop down list box, select the type of sensor connected to the Doppler module.

2. From the “Conduit type” drop down list box, select the type of conduit in which the sensor is installed.

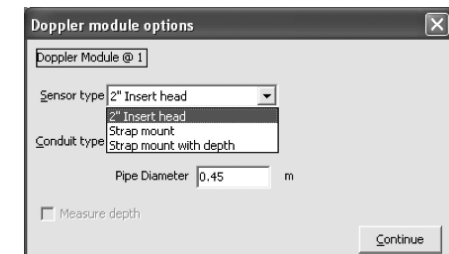

25.2 Configuring and editing the Doppler module options

Conduit type	Description
Circular pipe	Full or partially full
Non circular full pipe	A full pipe with a known cross-sectional area such as: <ul style="list-style-type: none"> • Box culvert • Oval pipe
Other conduit type	Non-circular open channel such as: <ul style="list-style-type: none"> • Trapezoidal • Irregular earthen channel

3. Enter the *“Pipe diameter”* or *“Cross-sectional area”* if applicable.

WARNING: Ensure the diameter or cross-sectional area of the pipe is entered in the appropriate units of measure.

4. If a *“Strap mount with depth”* sensor was selected and you wish to measure depth with this sensor, check the *“Measure depth”* check box.

Editing the Doppler module

If you wish to edit a Doppler module after it has been added and configured, click *“Edit”* from the *“Configure modules”* dialogue box. Only the *“Pipe diameter”* or *“Cross-sectional area”* may be edited.

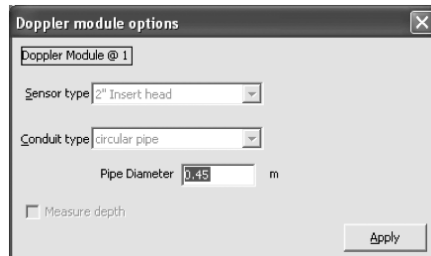

NOTE: If you wish to edit the *“Sensor type”* or *“Conduit type”* the entire module must be removed and a NEW module must be added

25.3 Removing a configured module

1. Highlight the module that you wish to remove. Click *“Remove”* and you will be prompted to confirm your action. Click *“Yes”* and the module will be removed.

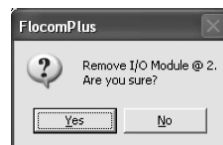

26.0 Configure channels

26.1 Adding a new channel

From the *“FloPro Settings”* dialogue box click *“Configure channel”* and the *“Configure channels”* dialogue box will appear.

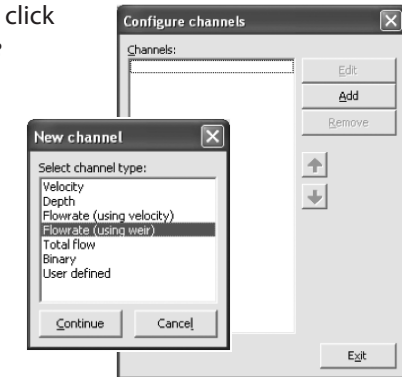

1. Click *“Add”* and the *“New channel”* dialogue box will appear as shown.

Channel types	Description
Velocity:	This channel type MUST be used whenever a MACE Doppler velocity sensor is configured. This channel type must also be used whenever the resultant velocity measurement will be used in a flow rate calculation.
Depth:	This channel type MUST be used whenever a MACE combined depth/velocity sensor is configured. This channel type MUST also be used whenever the resultant depth measurement will be used in a flow rate calculation.
Flowrate: (using velocity)	This channel type is used to calculate a flow rate based upon the results obtained from configured velocity and depth channels.
Flowrate: (using weir)	This channel type is used to calculate a flow rate based upon a depth channel and a selected weir type.
Total Flow:	This channel type is used to calculate an accumulated positive or negative total based on the results obtained from a configured flow rate channel.
Event: (pulse, status change)	This channel type is used to record time stamp data based on pulse or status change events.
Input pulse total:	This channel type is used to totalise pulses such as totalising flow meters and rain gauges.
Binary:	This channel type is used to monitor switch closure events such as pump on/off status and/or rainfall gauges.
User Defined:	This channel type can be used when a 3rd party sensor with digital/analogue output is to be configured. It should NOT be used for velocity or depth sensors where the results are required for a flow rate calculation.

26.1.1 Add a "Velocity" channel type - Doppler card

1. Select the "Velocity" channel type from the "New channel" dialogue box and click "Continue".

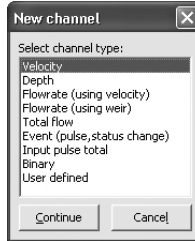

2. The "Channel name" dialogue box will appear. Enter a channel "Name" in to the text field (16 character maximum). This "name" will also be displayed on the FloPro main LCD if enabled. Click "Continue".

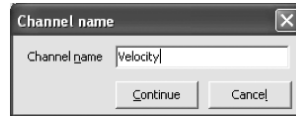

3. In the "New channel" dialogue box highlight the "Doppler Module" option from which the named channel will receive its value. Click "Continue" to complete the new channel. The "Configure channels" dialogue box will re-appear with the new channel listed.

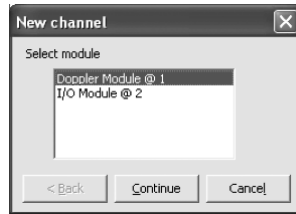

NOTE: As a particular module's input becomes fully utilised the module will not appear on the "Select module" list.

26.1.2 Add a "Depth" channel type - Doppler card

1. Select the "Depth" channel type from the "New channel" dialogue box and click "Continue".

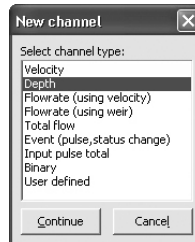

2. The "Channel name" dialogue box will appear. Enter a channel "Name" in to the text field (16 character maximum). This "name" will also be displayed on the FloPro main LCD if enabled. Click "Continue".

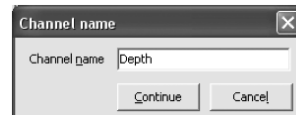

3. In the "New channel" dialogue box highlight the "Doppler Module" option from which the named channel will receive its value. Click "Continue" to complete the new channel. The "Configure channels" dialogue box will re-appear with the new channel listed.

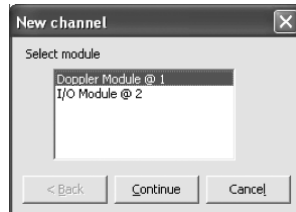

NOTE: As a particular module's input becomes fully utilised the module will not appear on the "Select module" list.

26.1.3 Add a "Velocity" channel type - I/O card (4-20mA)

1. Select the "Velocity" channel type from the "New channel" dialogue box and click "Continue".

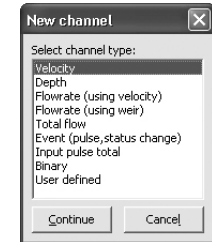

2. The "Channel name" dialogue box will appear. Enter a channel "Name" in to the text field (16 character maximum). This "name" will also be displayed on the FloPro main LCD if enabled. Click "Continue".

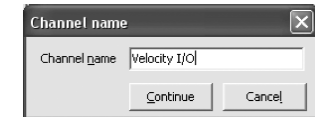

3. In the "New channel" dialogue box highlight the "I/O Module" option from which the named channel will receive its value. Click "Continue" and a new dialogue box will appear with the available input types listed.

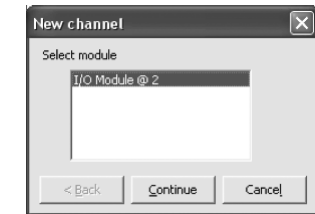

NOTE: As a particular module's input becomes fully utilised the module will not appear on the "Select module" list.

4. Select the "4-20mA" input type from the "I/O Module @ 2" list. Click "Continue" and then select the appropriate input from which the named channel will receive its value.

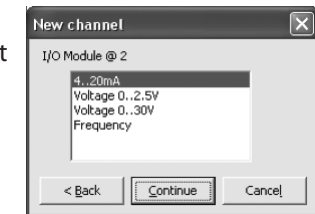

5. In this example the channel named "Velocity I/O" will be calculated using a sensor attached to "I/O Module @ 2" on "4..20mA input #1". Click "Continue" to complete the new channel. The "Configure channels" dialogue box will re-appear with the new channel listed.

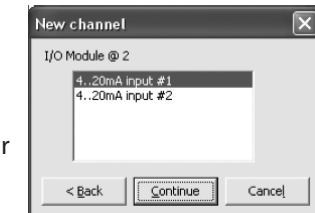

NOTE: As a particular module's inputs are utilised the input will not appear on the "I/O module" list. In the example above, the "4..20mA input #1" will no longer be available.

26.1.4 Add a "Velocity" channel type - I/O card (Frequency)

1. Select the "Velocity" channel type from the "New channel" dialogue box and click "Continue".

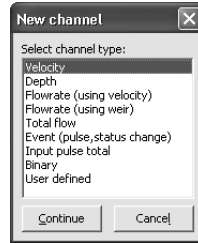

2. The "Channel name" dialogue box will appear. Enter a channel "Name" in to the text field (16 character maximum). This "name" will also be displayed on the FloPro main LCD if enabled. Click "Continue".



3. In the "New channel" dialogue box highlight the "I/O Module" option from which the named channel will receive its value. Click "Continue" and a new dialogue box will appear with the available input types listed.

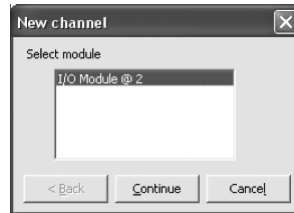

NOTE: As a particular module's input becomes fully utilised the module will not appear on the "Select module" list.

4. Select the "Frequency" input type from the "I/O Module @ 2" list. Click "Continue" and then select the appropriate input from which the named channel will receive its value.

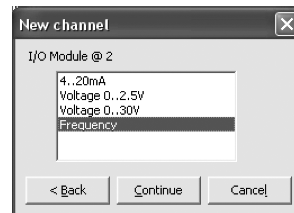

5. In this example the channel named "Velocity Freq" will be calculated using a sensor attached to "I/O Module @ 2" on "Digital input #1". Click "Continue" to complete the new channel. The "Configure channels" dialogue box will re-appear with the new channel listed.

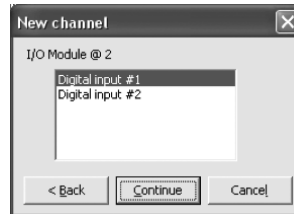

NOTE: As a particular module's inputs are utilised the input will not appear on the "I/O module" list. In the example above, the "Digital input #1" will no longer be available.

26.1.5 Add a "Depth" channel type - I/O card (4-20mA)

1. Select the "Depth" channel type from the "New channel" dialogue box and click "Continue".

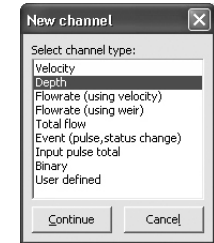

2. The "Channel name" dialogue box will appear. Enter a channel "Name" in to the text field (16 character maximum). This "name" will also be displayed on the FloPro main LCD if enabled. Click "Continue".

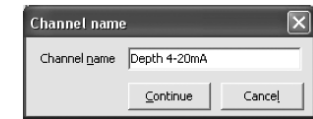

3. In the "New channel" dialogue box highlight the "I/O Module" option from which the named channel will receive its value. Click "Continue" and a new dialogue box will appear with the available input types listed.

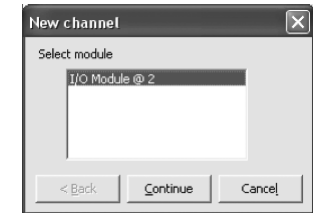

NOTE: As a particular module's input becomes fully utilised the module will not appear on the "Select module" list.

4. Select the "4-20mA" input type from the "I/O Module @ 2" list. Click "Continue" and then select the appropriate input from which the named channel will receive its value.

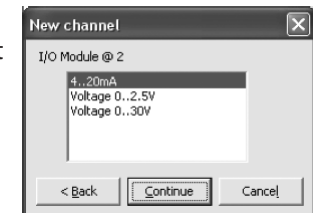

5. In this example the channel named "Depth 4-20mA" will be calculated using a sensor attached to "I/O Module @ 2" on "4-20mA input #2". Click "Continue" to complete the new channel. The "Configure channels" dialogue box will re-appear with the new channel listed.

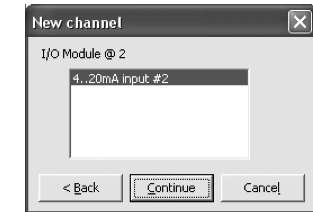

NOTE: As a particular module's inputs are utilised the input will not appear on the "I/O module" list. In the example above, the "4-20mA input #2" will no longer be available.

26.1.6 Add a “Depth” channel type - I/O card (Shaft encoder)

1. Select the “Depth” channel type from the “New channel” dialogue box and click “Continue”:

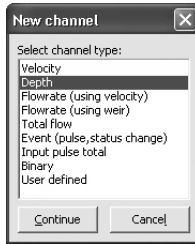

2. The “Channel name” dialogue box will appear. Enter a channel “Name” in to the text field (16 character maximum). This “name” will also be displayed on the FloPro main LCD if enabled. Click “Continue”:

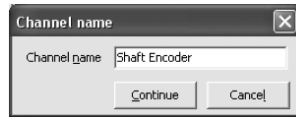

3. In the “New channel” dialogue box highlight the “I/O Module” option from which the named channel will receive its value. Click “Continue” and a new dialogue box will appear with the available input types listed.

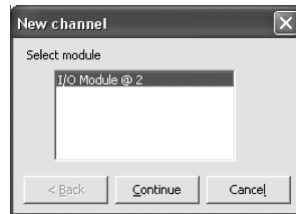

NOTE: As a particular module’s input becomes fully utilised the module will not appear on the “Select module” list.

4. Select the “Shaft encoder” input type from the “I/O Module @ 2” list. Click “Continue” and then select the appropriate input from which the named channel will receive its value.

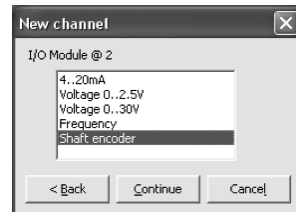

5. In this example the channel named “Shaft Encoder” will be calculated using a sensor attached to “I/O Module @ 2” on “Digital input #1”. Click “Continue” to complete the new channel. The “Configure channels” dialogue box will re-appear with the new channel listed.

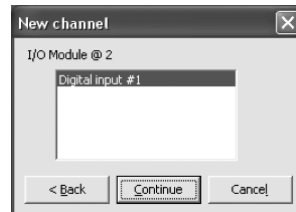

NOTE: As a particular module’s inputs are utilised the input will not appear on the “I/O module” list. In the example above, the “Digital input #1” will no longer be available.

26.1.7 Add a “Flowrate (Velocity)” channel type - Doppler

1. Select the “Flowrate (using velocity)” channel type from the “New channel” dialogue box and click “Continue”:

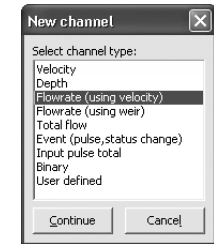

2. The “Channel name” dialogue box will appear. Enter a channel “Name” in to the text field (16 character maximum). This “name” will also be displayed on the FloPro main LCD if enabled. Click “Continue”:

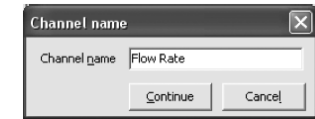

3. In the “Select velocity channel” dialogue box use the drop down list to highlight the Doppler velocity channel named “Velocity” from which the channel named “Flow rate” will receive its value. Click “Continue” and the “Flowrate measurement type” dialogue box will appear.

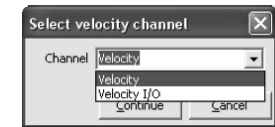

4. Select either “Full circular pipe” or “Circular pipe using depth” depending upon your application.

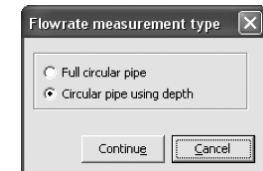

5. If you select “Full circular pipe”, click “Continue” to complete the new channel.

If you select “Circular pipe using depth”, click “Continue” and the “Select depth channel” dialogue box will appear. In the “Select depth channel” dialogue box use the drop down list to highlight the channel named “Depth...” from which the channel named “Flow rate” will receive its value. Click “Continue” to complete the new channel.

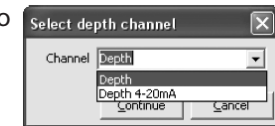

NOTE: If “Other conduit type” was selected when configuring a Doppler module, then the “Flowrate measurement type” dialogue box will not appear and FloCom+ will automatically prompt for selection of both velocity and depth channels.

6. The “Configure channels” dialogue box will re-appear with the new channel listed.

26.1.8 Add a “Flowrate (Velocity)” channel type - I/O card

1. Select the “Flowrate (using velocity)” channel type from the “New channel” dialogue box and click “Continue”.

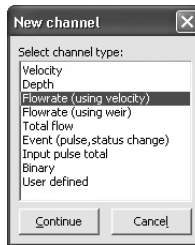

2. The “Channel name” dialogue box will appear. Enter a channel “Name” in to the text field (16 character maximum). This “name” will also be displayed on the FloPro main LCD if enabled. Click “Continue”.

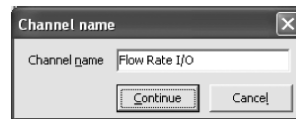

3. In the “Select velocity channel” dialogue box use the drop down list to highlight the velocity channel on the I/O card from which the named “Flow Rate I/O” channel will receive its value. Click “Continue” and the “Select flowrate calculation type” dialogue box will appear.



4. Select either “Full circular pipe”, “Full non-circular pipe”, “Circular pipe using depth” or “Other conduit using depth” depending upon your application.

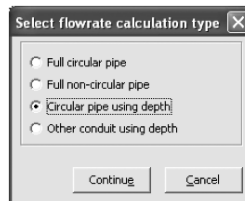

5. If you select a “Full...” pipe type, click “Continue” to complete the new channel.

If you select a “Circular pipe using depth” or “Other conduit using depth”, click “Continue” and the “Select depth channel” dialogue box will appear.

6. In the “Select depth channel” dialogue box use the drop down list to highlight the named “Depth...” channel from which the named “Flow Rate I/O” channel will receive its value. Click “Continue” to complete the new channel.

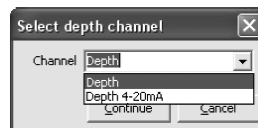

7. The “Configure channels” dialogue box will reappear with the new channel listed.

26.1.9 Add a “Flowrate (Weir)” channel type

The FloPro Series 3 contains in-built equations for allowing users to measure flow rate through rated structures such as flumes and weirs. The table below lists the structures supported and the equations used to calculate flow rate.

All of the weir equations assume that the flow is fully contracted, meaning that the approach channel is wide enough and deep enough that the proximity of the floor and sidewalls to the weir opening does not affect the flow (Tony L. Wahl, Bureau of Reclamation Hydraulics Laboratory in Denver, Colorado, USA).

The equations used by the FloPro Series 3 and reproduced here are used with permission of U.S. Dept. of the Interior, Bureau of Reclamation - Hydraulic Investigations and Laboratory Services Group. For further information users are encouraged to visit the following websites:

www.usbr.gov/pmts/hydraulics_lab/pubs/wmm/index.htm

www2.alterra.wur.nl/Internet/webdocs/ilri-publicaties/publicaties/Pub20/pub20.pdf

Flume and Weir Equation Summary

	Equation, cfs (head measured in feet)	Equation, kL/sec (m ³ /sec) ~ head measured in meters
Contracted rectangular weir	$Q=3.33(L-0.2h_1)h_1^{1.5}$	$Q=1.84(L-0.2h_1)h_1^{1.5}$
Suppressed rectangular weir	$Q=3.33(L)h_1^{1.5}$	$Q=1.84(L)h_1^{1.5}$
V-notch weir, 90°	$Q=2.49h_1^{2.48}$	$Q=1.34h_1^{2.48}$
V-notch weir, 30°	$Q=(8/15)(2g)^{0.5}C_e \tan(\theta/2)(h_1+k_n)2.5$	$Q=(8/15)(2g)^{0.5}C_e \tan(\theta/2)(h_1+k_n)2.5$
V-notch weir, 45°	$Q=(8/15)(2g)^{0.5}C_e \tan(\theta/2)(h_1+k_n)2.5$	$Q=(8/15)(2g)^{0.5}C_e \tan(\theta/2)(h_1+k_n)2.5$
V-notch weir, 60°	$Q=(8/15)(2g)^{0.5}C_e \tan(\theta/2)(h_1+k_n)2.5$	$Q=(8/15)(2g)^{0.5}C_e \tan(\theta/2)(h_1+k_n)2.5$
Cipoletti weir	$Q=3.367(L)h_1^{1.5}$	$Q=1.86(L)h_1^{1.5}$
Parshall flumes	$Q=Ch_3^n$	$Q=0.552^*Ch_3^n$
Replogle flumes (long-throated flumes or “ramp” flumes)	$Q = K_1(h_1+K_2)^U$	$Q = K_1(h_1+K_2)^U$
Palmer-Bowlus flumes	$Q = K_1(h_1+K_2)^U$	$Q = K_1(h_1+K_2)^U$

<p>Definitions, cfs Q = discharge, cfs L = weir width, ft h₁ = upstream head, ft C_e = V-notch weir coefficient k_n = V-notch weir head adjustment factor, ft θ = V-notch weir angle, degrees h₃ = Parshall flume upstream head, ft C = Parshall flume coefficient n = Parshall flume exponent g = acceleration due to gravity, 32.2 ft/s²</p>	<p>Definitions, kL/sec Q = discharge, kL/sec L = weir width, m h₁ = upstream head, m C_e = V-notch weir coefficient k_n = V-notch weir head adjustment factor, m θ = V-notch weir angle, degrees h₃ = Parshall flume upstream head, m C = Parshall flume coefficient n = Parshall flume exponent g = acceleration due to gravity, 9.806 m/s²</p>
--	--

The V-notch weir and Parshall flume coefficients used by the FloPro can be found in Appendix A

26.1.9 Add a “Flowrate (Weir)” channel type - *continued*

1. Select the “Flowrate (using Weir)” channel type from the “New channel” dialogue box and click “Continue”.

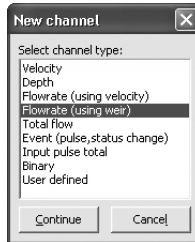

2. The “Channel name” dialogue box will appear. Enter a channel “Name” in to the text field (16 character maximum). This “name” will also be displayed on the FloPro main LCD if enabled. Click “Continue”.

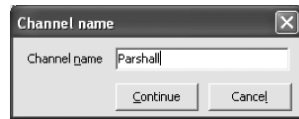

3. In the “Select depth channel” dialogue box use the drop down list to highlight the depth channel from which the channel (named “Parshall” in this example) will receive its value. Click “Continue” and the “Select weir type” dialogue box will appear.

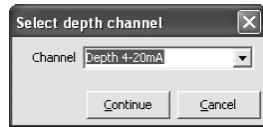

4. Select the weir type that you wish to configure. If you are setting up a flow rate through a Parshall flume, expand the “Parshall flume” weir type and select the appropriate flume width from the expanded list.

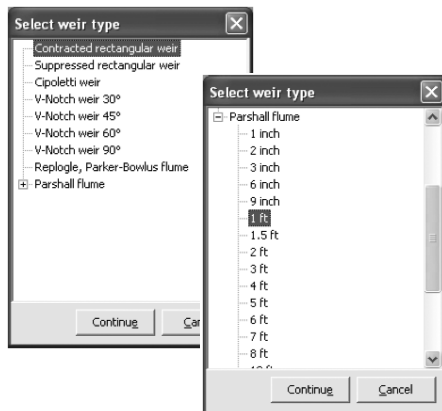

5. Click “Continue” to complete the new channel.

6. The “Configure channels” dialogue box will re-appear with the new channel listed.

26.1.10 Add a “Total flow” channel type

1. Select the “Total flow” channel type from the “New channel” dialogue box and click “Continue”.

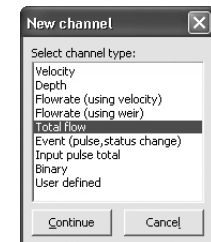

2. The “Channel name” dialogue box will appear. Enter a channel “Name” in to the text field (16 character maximum). This “name” will also be displayed on the FloPro main LCD if enabled. Click “Continue”.

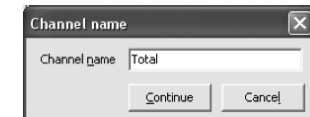

3. In the “Select flowrate channel” dialogue box use the drop down list to highlight the channel named “Flow Rate” from which the channel named “Total” will receive its value. Click “Continue” and the “Select total type” dialogue box will appear.

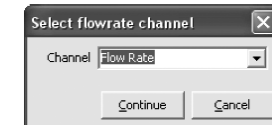

4. Select either “Totalise positive flow” or “Totalise negative flow” depending upon your application.

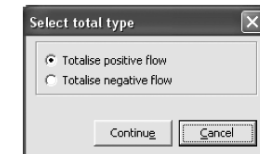

WARNING: The “Totalise positive flow” type will only increment the totaliser. If negative flows are recorded the totaliser will NOT decrement. The positive totaliser rolls over to zero.

WARNING: The “Totalise negative flow” type will only decrement the totaliser. If positive flows are recorded the totaliser will NOT increment. The negative totaliser rolls over to zero.

NOTE: Both positive and negative flow rates will be recorded in the data file.

5. Click “Continue” to complete the new channel and the “Configure channels” dialogue box will re-appear with the new channel listed.

26.1.11 Add a “Event - pulse” channel type

1. Select the “Event” channel type from the “New channel” dialogue box and click “Continue”:

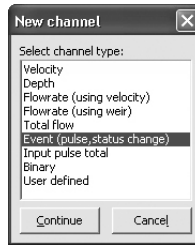

2. The “Channel name” dialogue box will appear. Enter a channel “Name” in to the text field (16 character maximum). This “name” will also be displayed on the FloPro Series 3 main LCD if enabled. Click “Continue”:

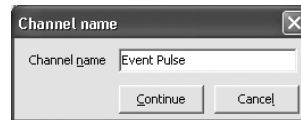

3. In the “New channel” dialogue box highlight the “I/O Module” option from which the named channel will receive its value. Click “Continue” and a new dialogue box will appear with the available input types listed.

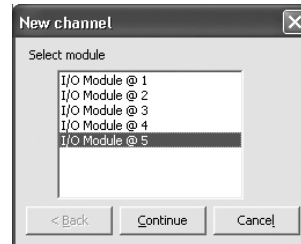

NOTE: As a particular module’s input becomes fully utilised the module will not appear on the “Select module” list.

4. Select the “Pulse event” type from the “I/O Module @ 5” list.

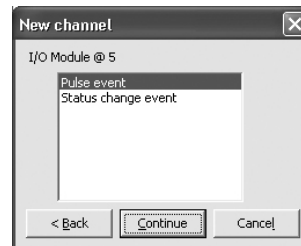

5. In this example the channel named “Event Pulse” will be calculated using “I/O Module @ 5” on “Digital input #3”. Click “Continue” to complete the new channel. The “Configure channels” dialogue box will re-appear with the new channel listed.

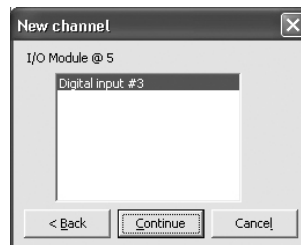

NOTE: As a particular module’s inputs are utilised the input will not appear on the “I/O module” list. In the example above, the “Digital input #3” will no longer be available.

26.1.12 Add a “Event-status change” channel type

1. Select the “Event” channel type from the “New channel” dialogue box and click “Continue”:

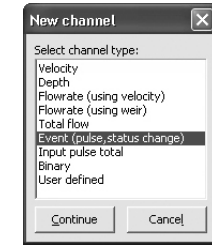

2. The “Channel name” dialogue box will appear. Enter a channel “Name” in to the text field (16 character maximum). This “name” will also be displayed on the FloPro Series 3 main LCD if enabled. Click “Continue”:

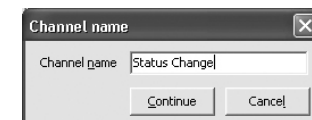

3. In the “New channel” dialogue box highlight the “I/O Module” option from which the named channel will receive its value. Click “Continue” and a new dialogue box will appear with the available input types listed.

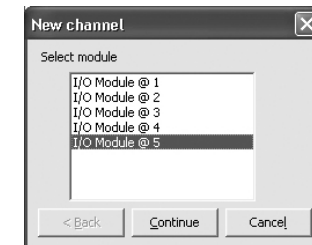

NOTE: As a particular module’s input becomes fully utilised the module will not appear on the “Select module” list.

4. Select the “Status change event” type from the “I/O Module @ 5” list.

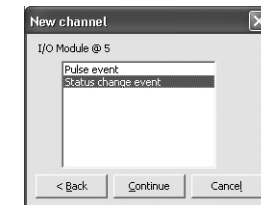

5. In this example the channel named “Status Change” will be calculated using “I/O Module @ 5” on “Digital input #3”. Click “Continue” to complete the new channel. The “Configure channels” dialogue box will re-appear with the new channel listed.

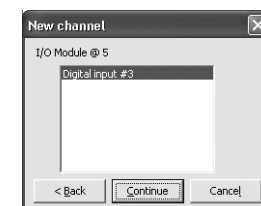

NOTE: As a particular module’s inputs are utilised the input will not appear on the “I/O module” list. In the example above, the “Digital input #3” will no longer be available.

26.1.13 Add a "Input pulse total" channel type

1. Select the "Input pulse total" channel type from the "New channel" dialogue box and click "Continue".

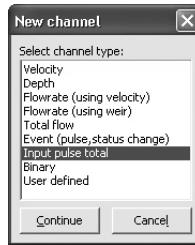

2. The "Channel name" dialogue box will appear. Enter a channel "Name" in to the text field (16 character maximum). This "name" will also be displayed on the FloPro Series 3 main LCD if enabled. Click "Continue".

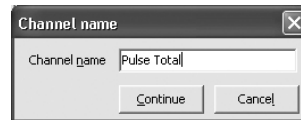

3. In the "New channel" dialogue box highlight the "I/O Module" option from which the named channel will receive its value. Click "Continue" and a new dialogue box will appear with the available input types listed.

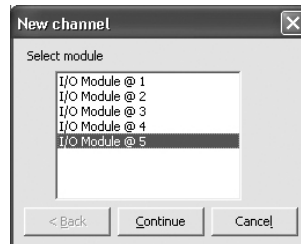

NOTE: As a particular module's input becomes fully utilised the module will not appear on the "Select module" list.

4. Select the "Pulse event" type from the "I/O Module @ 5" list.

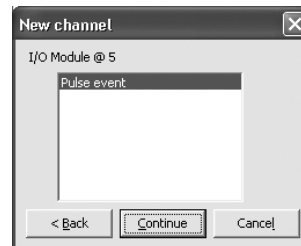

5. In this example the channel named "Pulse Total" will be calculated using "I/O Module @ 5" on "Digital input #3". Click "Continue" to complete the new channel. The "Configure channels" dialogue box will re-appear with the new channel listed.

NOTE: As a particular module's inputs are utilised the input will not appear on the "I/O module" list. In the example above, the "Digital input #3" will no longer be available.



26.1.14 Add a "Binary" channel type - I/O card

1. Select the "Depth" channel type from the "New channel" dialogue box and click "Continue".

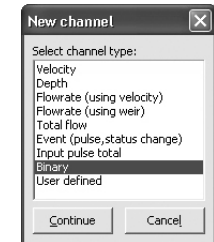

2. The "Channel name" dialogue box will appear. Enter a channel "Name" in to the text field (16 character maximum). This "name" will also be displayed on the FloPro main LCD if enabled. Click "Continue".

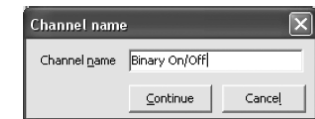

3. In the "New channel" dialogue box highlight the "I/O Module" option from which the named channel will receive its value. Click "Continue" and a new dialogue box will appear with the available input types listed.

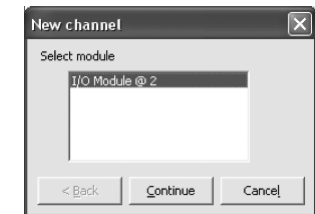

NOTE: As a particular module's input becomes fully utilised the module will not appear on the "Select module" list.

4. Select the "Digital input" type from the "I/O Module @ 2" list.

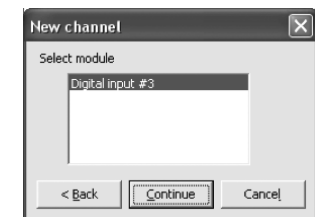

5. In this example the channel named "Binary On/Off" will be calculated using a switch attached to "I/O Module @ 2" on "Digital input #3". Click "Continue" to complete the new channel. The "Configure channels" dialogue box will re-appear with the new channel listed.

NOTE: As a particular module's inputs are utilised the input will not appear on the "I/O module" list. In the example above, the "Digital input #3" will no longer be available.

26.1.15 Add a “User defined” channel type - I/O card (Voltage)

1. Select the “User defined” channel type from the “New channel” dialogue box and click “Continue”:

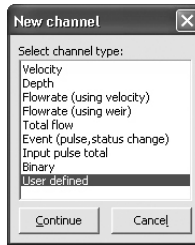

2. The “Channel name” dialogue box will appear. Enter a channel “Name” in to the text field (16 character maximum). This “name” will also be displayed on the FloPro main LCD if enabled. Click “Continue”:

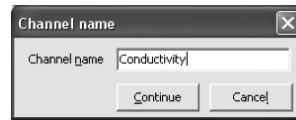

3. In the “New channel” dialogue box highlight the “I/O Module” option from which the named channel will receive its value. Click “Continue” and a new dialogue box will appear with the available input types listed.

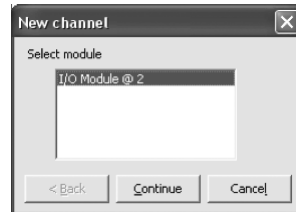

NOTE: As a particular module’s input becomes fully utilised the module will not appear on the “Select module” list.

4. Select the “Voltage 0..2.5V” or “Voltage 0..30V” input type from the “I/O Module @ 2” list. Click “Continue” and then select the appropriate input from which the named channel will receive its value.

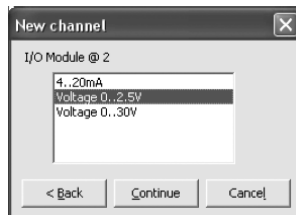

5. In this example the channel named “Conductivity” will be calculated using a sensor attached to “I/O Module @ 2” on “Voltage input #1”. Click “Continue” to complete the new channel. The “Configure channels” dialogue box will re-appear with the new channel listed.

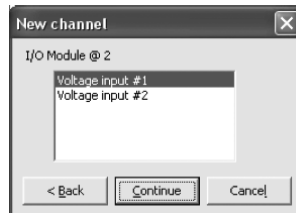

NOTE: As a particular module’s inputs are utilised the input will not appear on the “I/O module” list. In the example above, the “Voltage input #1” will no longer be available.

26.2 The order and removal of channels

26.2.1 Ordering configured channels

The channel list after “Channels” have been added reflects the order in which they were configured and in which the FloPro takes physical measurements. This also orders the channels in both the logged data and the FloPro LCD. For example, when scrolling through the displayed channels on the LCD, the output order will be the same as the “Configure channels” dialogue box.

This order can be changed to suit the users needs.

1. Highlight the “Channel” in the list you wish to move and click either the **up** or **down** arrows (where available).

The order is hierarchical and certain limitations apply. A “Channel” that is dependent on the value of one or more channels cannot be moved higher in the list than the lowest “Channel” in which it depends upon. For example, the “Flow Rate” channel is dependent on both “Velocity” and “Depth” measurements.



26.2.2 Removing configured channels

1. Highlight the “Channel” in the list you wish to remove and click “Remove”.

The removal is hierarchical and certain limitations apply. A “Channel” that is referenced by at least one other “Channel” cannot be removed unless the dependent “Channel” is removed first. For example, the “Velocity” channel is referenced in the “Flow Rate” channel and cannot be removed unless the “Flow Rate” is removed first.

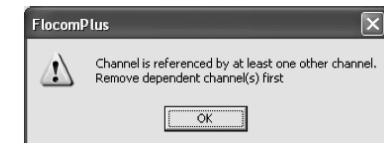

26.3 Editing a channel

WARNING: All configured channels MUST be edited prior to starting the FloPro. Editing the channel/s enables the correct configuration information to be sent to the controller module.

From the “FloPro Settings” dialogue box click “Configure channel” and the “Configure channels” dialogue box will appear.

1. Highlight the channel you wish to edit and click “Edit”. An input specific “Edit channel” dialogue box will appear.

2. Edit the settings in the “Edit channel” dialogue box to suit your application as per the recommendations on the following pages. Click “Apply” to save the settings and return to the “Configure channels” dialogue box.

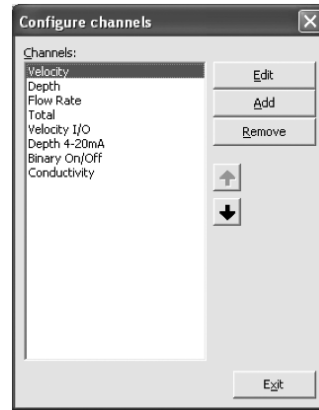

26.3.1 Edit “Velocity” channel type - Doppler card

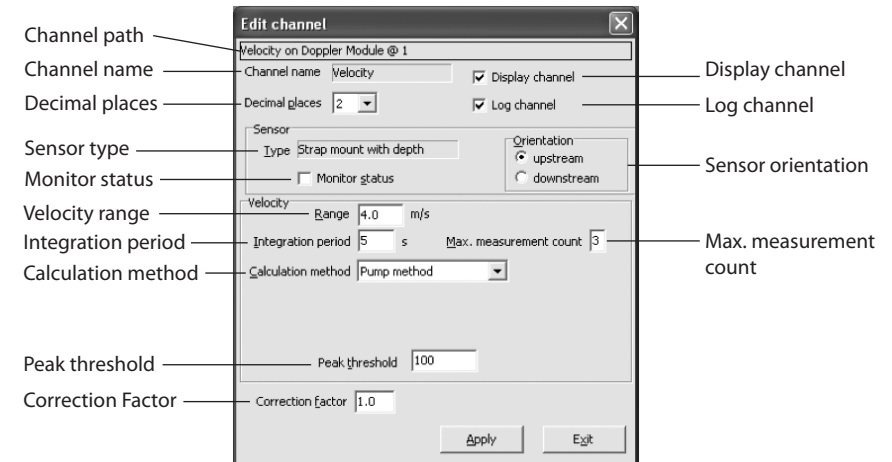

Channel path

This describes the channel type and the module input source.

Channel name

This is the name given to the channel by the user when setup.

NOTE: This name will also show on the FloPro LCD screen if the Display channel check box is ticked.

Decimal places

The user can set the number of decimal places (0, 1, 2, 3) using the drop down list box. These decimal places will be shown in both the data file and the LCD.

Display channel

If this check box is ticked then this channel will be displayed on the FloPro LCD.

Log channel

If this check box is ticked then this channel will be logged in the data file.

Sensor type

This is the Doppler velocity sensor type selected during the Doppler module configuration procedure. See “Chapter 25.2 Configuring and editing the Doppler module options”.

26.3.1 Edit “Velocity” channel type - *Doppler card* - continued

Monitor status

If this check box is ticked the FloPro will monitor whether or not the sensor is correctly connected to the Doppler module.

Sensor orientation

Under usual field conditions the velocity sensor should be positioned so that the transmitted beam is faced upstream. For example, MACE recommends that the velocity sensor is positioned so that there are 6 pipe diameters of straight flow before the sensor and 2 pipe diameters of straight flow behind the sensor. In practice this may not always be possible. However, these conditions may also be met by positioning the sensor to face downstream for 6 pipe diameters. At poor signal sites, turning the sensor around may help to increase signal strengths.

The “*Orientation*” feature allows the user to tell the processing electronics that although the velocities received are negative (when the sensor is facing downstream), you wish to totalise this flow as positive flow.

 **NOTE: When receiving data from a sensor facing downstream, the real-time velocity graph will show a spectrum that appears upside down**

Velocity range

This parameter sets the range of expected velocities that are to be analysed. MACE Flo-series instruments “pigeon-hole” velocity readings into 128 positions over the velocity range set by the user. For example, each “hole” in a range of 0 - 4 m/s is .03125 m/s wide, whereas in a 0 - 1 m/s range each hole is .0078 m/s wide. For example, in a stream in which the user knows that the peak velocity will never exceed say, 0.6 m/s a velocity range of 1 m/s may be set. **In this way, the resolution of the final average velocity is increased.** Furthermore, in slow moving streams or ones that contain few acoustically reflective particles, a smaller velocity range will often result in far more repeatable data because the instrument does not waste processing power gathering data outside of expected ranges. To be safe, the velocity range should be set larger than expected and the site monitored for several weeks under different flow conditions to determine the peak expected velocity. After this period, the user may find it prudent to increase the resolution by changing the velocity range.

 **The velocity range must be set so that ALL components of the stream velocity are captured when viewed on the “real-time” graph. Failure to do so will compromise the validity of the velocity calculation. See Chapter 29 About real time data for further details**

Integration period

The integration time is the period in which samples of the velocity spectrum are taken before an average velocity reading is calculated. The minimum integration time is 4 sec and the maximum integration time is 180 seconds and may be reduced automatically by the measurement interval and the maximum measurement count depending upon the instrument configuration.

The integration time may be varied for several reasons:

- Under field conditions where the flow is fluctuating dramatically, increasing the integration time will help to get a more accurate average velocity reading, because more samples are available to calculate the average .
- Under field conditions where the flow has a low number of acoustically reflective particles, increasing the integration time will help to get a more accurate average velocity reading, because more reflective targets will be sampled to calculate the average.

 **The power consumption of the system is affected by the integration time. The longer the unit is on and physically sampling, the shorter the battery life without charging. The Flo Series3 internal battery has a 7.2 Ah capacity. During an integration period each Doppler sensor will draw approximately 120 mA.**

Continued over page

26.3.1 Edit “Velocity” channel type - *Doppler card* - continued

Maximum measurement count

Under certain flow or no flow conditions signal noise may disrupt the calculation of a true average velocity reading. As described the peak threshold feature is designed to overcome this problem. However, unwanted velocity readings may be derived from other sources such as aquatic life, which may give strong signal strengths.

Within all Flo-series instruments one of two flow states can occur. The stream can either be moving or stationary. For example, a Flo-series sensor submerged in a river diversion pipe that is used to pump irrigation water may be full at times when no water is being pumped. Under these conditions, it is common for fish and aquatic invertebrates to inhabit the pipeline. Unfortunately, to a Doppler ultrasonic velocity sensor, a fish swimming at 500 mm/s is computed as a full pipe of water moving at 500 mm/s. This type of erroneous flow reading will result in an increase in the totalised flow. Conversely, in a slow moving stream or one that contains few acoustically reflective particles, a velocity reading may be missed if there is insufficient data to analyse. Under this circumstance, the totaliser will not be incremented.

To overcome this problem, MACE Flo-series instruments include the maximum measurement count feature whereby if the instrument detects a state change (i.e flow has started or flow has stopped) it stays on and takes X number of readings to confirm this situation. If all X number of readings meet the criteria for a valid reading as set by, peak threshold, flow threshold, minimum stream activity and stream activity percentage, then the reading is accepted and the change of state confirmed. If the readings do not all agree that there has been a change of state, then the reading is “discarded” and the current flow state remains. That is, the unit continues to calculate zero flow or accepts the flow rate as calculated.

Furthermore, the Flo-series instrument also checks that the direction of flow has not changed within the X readings. For example, if there is zero flow and the unit detects a reading of positive flow and another of negative flow then the overall reading is discarded and the unit continues to register a zero flow.

The number of readings used for the maximum measurement count is configurable by the user.

Calculation method

“Pump method”

Under normal conditions, water flow that is provided by a pump is turbulent and contains a vast number of acoustically reflective particles, particularly miniature air bubbles that are a result of cavitation events. In monitoring sites that are pumped, or where low signal strengths are uncommon, the pump method should be used.

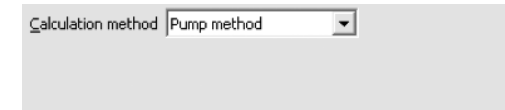

“Surface wave rejection”

In severely turbulent, open conduit flows such as encountered in a sewerage system, it is common for standing waves to develop in the flow stream. If situated closely, these standing waves (surface waves) may confound a Doppler ultrasonic sensor because they typically result in reflections of a significantly slower velocity. In the diagram, a surface wave can be seen as a sharp peak on the real-time graph at about the 0.2 m/s mark.

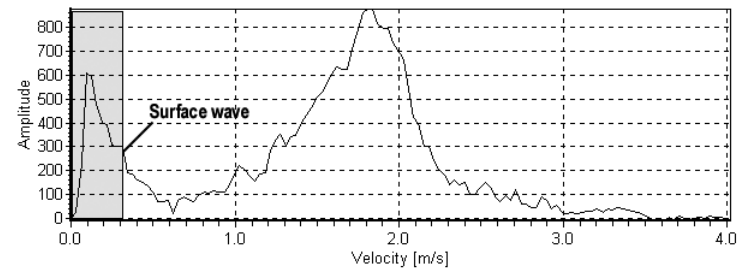
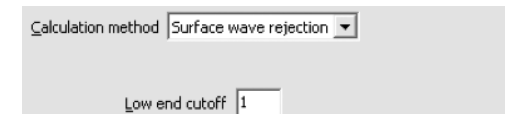

In this case, if the user selects the surface wave rejection calculation method a menu item called “low-end cutoff” will be displayed. This feature enables the user to force the Flo-series instrument to ignore Doppler shifts that lie between zero and the low-end cutoff. The low-end cutoff is a percentage of the range (x-axis) of the real-time graph. In the diagram the low-end cutoff would be configured to about 10% of the graph. That is, any data that are received between 0 and 0.4m/s will be ignored when computing an average stream velocity (greyed area, not represented in actual real-time graph).

26.3.1 Edit “Velocity” channel type - *Doppler card* - continued

“Gravity method”

This method should be used wherever a stream is slow moving and/or contains few acoustically reflective particles. Because this calculation method is designed to enhance the velocity processing of slow moving/clean streams, it may also result in erroneous velocity readings unless enabled correctly. When enabled, this method will display two new menu items.

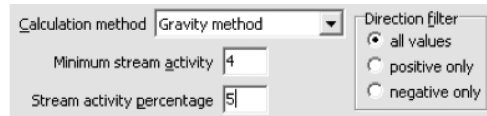

“*Minimum stream activity*” - Under conditions of zero flow within a conduit (see maximum measurement count) a single aquatic life form can produce large Doppler shifts. The minimum stream activity parameter must be set to negate the effects of these aquatic life forms. This parameter should be set to low values (2-10) in sites where extremely slow average velocities are expected (< 0.2 m/s). Values greater than 10 can be set where average velocities of >0.2 m/s are expected.

“*Stream activity percentage*” - To be used in conjunction with the minimum stream activity parameter, this parameter forces the Flo-series instrument to utilise only those velocity spectrums that have a minimum stream activity value greater than set by the user. Under good acoustic conditions typically 90 –100% of the data received by the velocity sensor will be used to calculate an average velocity. Under conditions where the data received by the velocity sensor has been caused by aquatic life, typically <10% of the data will be used. Therefore, this parameter should be set to low values (2-10) in sites where extremely slow average velocities are expected (< 0.2 m/s). Values greater than 10 can be set where average velocities of >0.2 m/s are expected.



WARNING: The user MUST check that the value entered for both “minimum stream activity” and “Stream activity percentage” do not cause real velocity data to be ignored

“*Direction filter*” - Under certain field conditions, a stream may move in a positive direction but the prevailing winds may come from the opposite (negative) direction. The effect of this on Doppler ultrasonic processing is that a **strong negative** Doppler shift may be “seen” as well as the actual **positive** shift of the stream itself. In some cases the shift caused by the winds may overwhelm the shift from the slower moving water flow and cause erroneous flow rate readings. The “*Direction filter*” is built in to allow the user to overcome such sources of error.

“*All values*” - When checked, all filtering is off.

“*Positive only*” - When checked, all negative velocity components are filtered out.

“*Negative only*” - When checked, all positive velocity components are filtered out.



WARNING: The user MUST check that the “Direction filter” does not cause real velocity data to be ignored

Velocity peak threshold

Doppler shifts that are unrelated to the measurement of velocities in a stream are often called “signal noise”. This “noise” can be a result of several different factors including:

- Electromagnetic interference;
- Reflections of signals from other echoes.

In some situations background noise may interfere with the calculation of correct average velocity readings. Flo-series instruments feature a “noise filter” called a “peak threshold”.

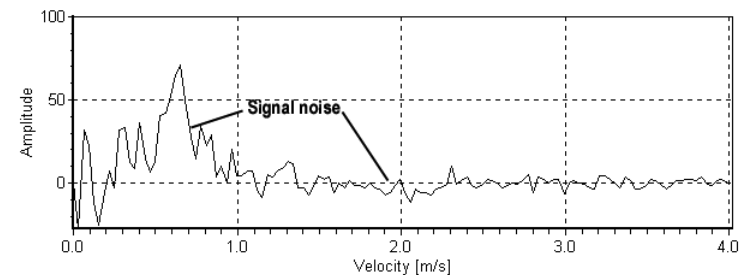

26.3.1 Edit “Velocity” channel type - *Doppler card* - continued

In the figure above signal noise can be seen on the velocity spectrum graph as low signal strength echoes. In the graph above you can see that the signal noise has an approximate amplitude value of 75. Therefore, by setting a threshold of say 100, this noise will be ignored in the computation of average velocity. The user should be careful however, at sites where signal strength is inherently lower, a peak threshold that is set too high could mean that true velocity readings are discarded.

This feature is particularly useful at sites where the sensor may be submerged for periods where no flow is occurring. For example, signal noise encountered in a submerged 1 m diameter pipeline that gives a false “average velocity” of 1 m/s will still increase a totalising counter by 785 litres per second, even though no true flow existed. By watching several real-time graphs of no flow conditions and monitoring the extent of signal noise apparent, a peak threshold may be set so that signal noise is not computed as real flow.

Correction Factor

Unfortunately, ideal hydraulic conditions cannot be achieved at every site that requires monitoring. In locations where hydraulic conditions are such that velocity calibrations at various flow regimes are required, then the “**Correction factor**” may help. Under abnormal hydraulic conditions, the average velocity of the stream must be calculated using traditional means that comply with Australian (refer to AS3778 series) or International Standards.



NOTE: The velocity correction factor can be set to scale the calculated velocity result and should only be used with extreme care

It allows a single multiplication factor to be applied to the calculated velocity readings.

For example, should a **trusted** primary source of flow measurement show that the FloPro is under-reading by 5%, then the correction factor should be set to 1.05. If it is proven to be over-reading by 5% then the correction factor should be set to 0.95.

26.3.2 Edit “Depth” channel type - *Doppler card*

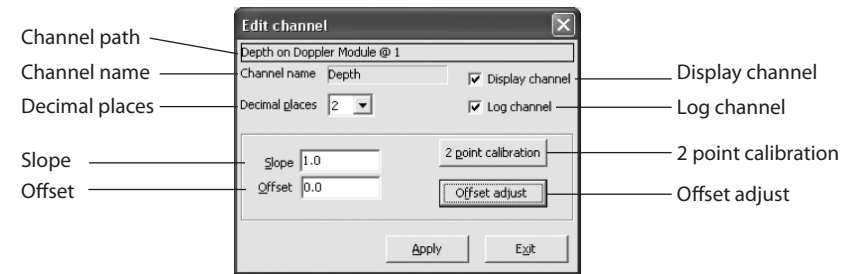

Channel path

This describes the channel type and the module input source.

Channel name

This is the name given to the channel by the user when setup.



NOTE: This name will also show on the FloPro LCD screen if the Display channel check box is ticked.

Decimal places

The user can set the number of decimal places (0, 1, 2, 3) using the drop down list box. These decimal places will be shown in both the data file and the LCD.

Display channel

If this check box is ticked then this channel will be displayed on the FloPro LCD.

Log channel

If this check box is ticked then this channel will be logged in the data file.

Slope and Offset

If the user has a sensor with known slope and offset characteristics, they may be entered directly into the unit configuration. For example, the MACE ceramic pressure sensor is supplied with a factory calibration tag indicating the sensor’s slope and offset values.



NOTE: The factory calibration tag includes slope/offset values for both metres (m) and inches (in). Be sure to enter the correct values for the selected depth units

Alternatively, the user should perform a 2-point calibration or calculate the slope and offset values of the sensor as described on the following pages.

26.3.2 Edit "Depth" channel type - Doppler card - continued

2-point calibration

To correctly calibrate an environmental sensor it is important to calibrate it over its useful range. For example, if a depth sensor has a range of 0 - 2 metres but you only wish to use it to measure the range 0.1 metres to 1.2 metres, you should re-calibrate it across the reduced range.

1. Click "2-point calibration" from the "Edit channel" dialogue box and the "2 point calibration" dialogue box appears.

The "Current value" from the sensor (in this case a depth sensor with frequency output) is displayed at the top of the window and is updated approximately once per second.

2. To carry out a two point calibration, prepare the measurement set up for the first calibration point (either the sensors upper or lower range limit).

3. When the "Current value" has stabilised, click on the "Set" button in the "1st point" box. The "Current value" is copied to the "Measured value" field of the "1st point" box and the "Actual value" field is enabled.

4. Enter the sensors actual value (in this case depth) in the "Actual value" field.

5. Prepare the measurement set up for the second calibration point (the opposite sensor range limit from that used in point 2 above). For example, if you used the upper range limit in point 2, now use the lower range limit.

6. When the "Current value" has stabilised, click on the "Set" button in the "2nd point" box. The "Current value" is copied to the "Measured value" field of the "2nd point" box and the "Actual value" field is enabled.

7. Enter the sensors actual value (in this case depth) in the "Actual value" field.

8. Click on the "Apply" button to calculate the new slope and offset parameter values for the associated channel. Clicking on the "Cancel" button terminates the procedure without altering the parameter values.

Offset adjust

This function is used to "fine tune" the depth reading whenever the sensor is deployed or reading inaccurately. For example, the depth sensor may be sitting slightly off the bottom of the stream, or the user has deployed it above a silt line on the side of a pipe.

1. Click "Offset adjust" from the "Edit channel" dialogue box and the "Channel offset adjust" dialogue box appears.

The "Current value" from the sensor (in this case a depth sensor with frequency output) is displayed at the top of the window and is updated approximately once per second.

2. To adjust the "Current value", enter your current measured value in the "Corrected value" field.

3. Click on the "Apply" button to calculate the new "Offset" parameter value for the associated channel. Clicking on the "Cancel" button terminates the procedure without altering the offset value.

WARNING: When calibrating a depth channel, measurements should ALWAYS be carried out from the BOTTOM of the channel/pipe to the top of the water level

Manually calculating slope and offset values

$$\text{Slope} = \text{Sensor range} \div \text{Span}$$

$$\text{Offset} = - (\text{Slope} \times \text{Sensor output at zero})$$

Sensor Range: The measuring range of the sensor. For example a depth sensor may be ranged from 0 to 2m.

Span: Is the difference between the sensor output (Frequency or Voltage) at the top of the measured range (say 2m) and the sensor output at zero.

For example, you wish to calculate the slope and offset for an ultrasonic depth sensor that has a range of 0 to 1250mm. At 0mm the sensor outputs a frequency of 100Hz and at 1250mm the sensor outputs 2500Hz.

The following calculations will provide the sensor's slope and offset:

$$\begin{aligned} \text{Slope} &= 1250 \div (2500-100) & \text{Offset} &= - (0.5208 \times 100) \\ &= 1250 \div (2400) & &= - 52.08 \\ &= 0.5208 & & \end{aligned}$$

26.3.3 Edit "4-20mA" input type - I/O card

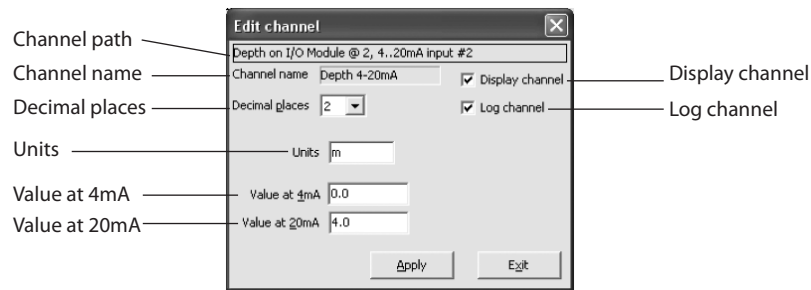

Channel path

This describes the channel type and the module input source.

Channel name

This is the name given to the channel by the user when setup.

NOTE: This name will also show on the FloPro LCD screen if the Display channel check box is ticked

Decimal places

The user can set the number of decimal places (0, 1, 2, 3) using the drop down list box. These decimal places will be shown in both the data file and the LCD.

Display channel

If this check box is ticked then this channel will be displayed on the FloPro LCD.

Log channel

If this check box is ticked then this channel will be logged in the data file.

Units

This sets the units on the logged value. This is a text field and is user defined.

NOTE: If a "Velocity" or "Depth" channel type is configured on a "4-20mA" input the units are defined according to the "System settings"

Value at 4mA

Enter the value here that corresponds to an input of 4mA.

Value at 20mA

Enter the value here that corresponds to an input of 20mA.

26.3.4 Edit "Frequency", "Voltage" and "Shaft encoder" input type - I/O card

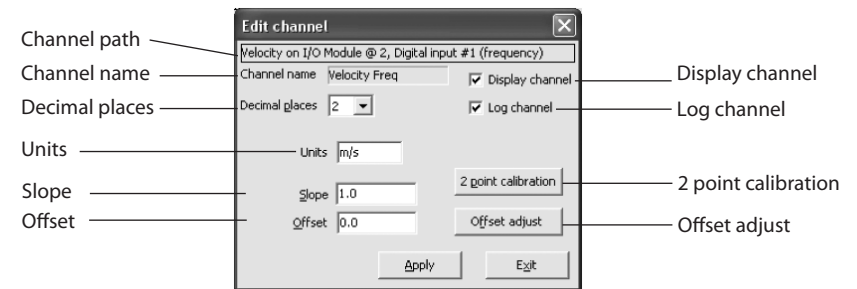

Channel path

This describes the channel type and the module input source.

Channel name

This is the name given to the channel by the user when setup.

NOTE: This name will also show on the FloPro LCD screen if the Display channel check box is ticked

Decimal places

The user can set the number of decimal places (0, 1, 2, 3) using the drop down list box. These decimal places will be shown in both the data file and the LCD.

Display channel

If this check box is ticked then this channel will be displayed on the FloPro LCD.

Log channel

If this check box is ticked then this channel will be logged in the data file.

Units

This sets the units on the logged value. This is a text field and is user defined.

NOTE: If a "Velocity or Depth" channel type is configured on a "Frequency, Voltage or Shaft encoder" input the Units are defined according to the "System settings"

Slope, Offset, 2 point calibration and Offset adjust

Refer to Chapter 26.3.2 for details

26.3.5 Edit “Flowrate (Velocity)” channel type

26.3.5.1 Flowrate: circular pipe using depth or full circular pipe

Channel name

This is the name given to the channel by the user when setup.



NOTE: This name will also show on the FloPro LCD screen if the Display channel check box is ticked

Decimal places

The user can set the number of decimal places (0, 1, 2, 3) using the drop down list box. These decimal places will be shown in both the data file and the LCD.

Display channel

If this check box is ticked then this channel will be displayed on the FloPro LCD.

Log channel

If this check box is ticked then this channel will be logged in the data file.

Measured channels

“Flowrate” is a derived channel type. These fields define from which measured channels flowrate is being calculated.



NOTE: In a “Flowrate: full circular pipe” dialog box only a velocity channel will be displayed

Flowrate units

Select the units and the timebase from the drop down list boxes. This sets the units on the logged value.

Pipe diameter

If the “Velocity channel” source is from a MACE Doppler card then the “Pipe diameter” when configuring a “Flowrate” channel is preset when the Doppler card is added to the FloPro configuration. If the “Velocity channel” source is an I/O card then the “Pipe diameter” (cross-sectional area if a non-circular pipe) is entered here.

If the “Flowrate” channel is configured for “Conduit using depth” then the “Pipe diameter” field will not appear.

Siltation depth

This parameter can be used to correct the calculated flow rate if a known amount of silt is inside the pipe.

The depth of silt will be subtracted from the area calculation in order to calculate the corrected flow rate.

26.3.5.2 Flowrate: Using Polynomial

When the stream flow is in an open channel (non-circular), the user must determine the cross-sectional area and relate it to depth via a polynomial equation. MACE Flo-series instruments can use 5th order polynomial equations.

26.3.5 Edit “Flowrate (Velocity)” channel type - *continued*

Channel name

This is the name given to the channel by the user when setup.

NOTE: This name will also show on the FloPro LCD screen if the Display channel check box is ticked

Decimal places

The user can set the number of decimal places (0, 1, 2, 3) using the drop down list box. These decimal places will be shown in both the data file and the LCD.

Display channel

If this check box is ticked then this channel will be displayed on the FloPro LCD.

Log channel

If this check box is ticked then this channel will be logged in the data file.

Measured channels

“Flowrate” is a derived channel type. These fields define from which measured channels flowrate is being calculated.

Flowrate units

Select the units and the timebase from the drop down list boxes. This sets the units on the logged value.

Polynomial coefficients

The polynomial coefficients listed in FloCom+ are related to the following equation:

$$\text{Cross-Sectional Area} = A + B*X + C*X^2 + D*X^3 + E*X^4 + F*X^5$$

Where X = depth of stream

The coefficients are listed in order A, B, C, D, E, F.

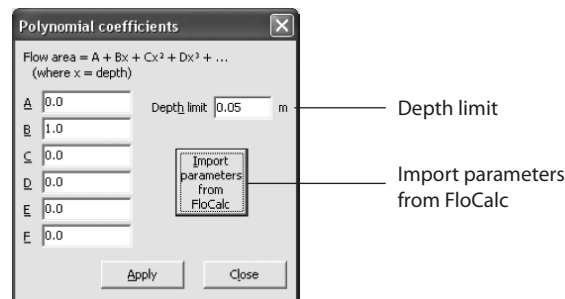

Import parameters from FloCalc

The Mace utility program FloCalc (download separately from www.macemeters.com) can be used to draw regular and irregular channel shapes. These shapes are then converted into a 5th order polynomial. Their coefficients can be imported directly into the appropriate fields in FloCom+.

1. Click “Import parameters from FloCalc” and MACE FloCalc will open on the “Profile Designer” tab sheet.

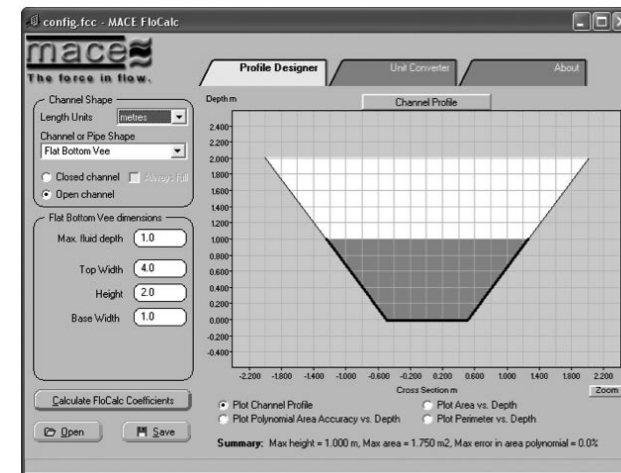

2. Describe/draw your channel or pipe shape in FloCalc (see FloCalc Product Manual).

3. Click “Calculate FloCalc Coefficients” and the “MACE FloCalc Coefficients” dialogue box will appear.

4. Click “Copy to Clipboard” then click “Close” and exit from FloCalc.

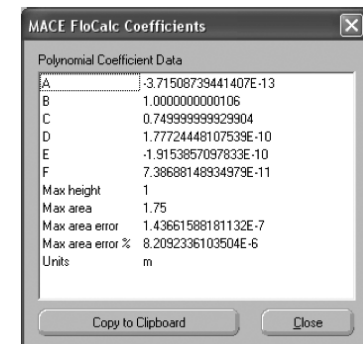

26.3.5 Edit “Flowrate (Velocity)” channel type - *Continued*

5. The “*FloCalc parameters*” dialogue box will appear containing the calculated polynomial coefficients.

6. Review the coefficients and click “*Apply*” to update the “*Polynomial coefficients*” dialogue box.

7. Click “*Apply*” and the coefficients in the “*Flowrate: Using polynomial*” dialogue box will be set.

Depth limit

When the cross-sectional area of a stream is calculated using the polynomial coefficient method, the user must set the “*Depth limit*” at which the polynomial reaches a maximum. For example, if a channel has a maximum depth of 1.5m the “*Depth limit*” should be set at 1.5m as well. Alternatively the “*Depth limit*” can be set within FloCalc and the procedure described for importing polynomial coefficients.

26.3.6 Edit a “Flowrate (Weir)” channel type

26.3.6.1 Flowrate (Weir): Rectangular and Cipoletti weirs

Channel name

This is the name given to the channel by the user when setup.

NOTE: This name will also show on the FloPro LCD screen if the **Display channel** check box is ticked

Decimal places

The user can set the number of decimal places (0, 1, 2, 3) using the drop down list box. These decimal places will be shown in both the data file and the LCD.

Display channel

If this check box is ticked then this channel will be displayed on the FloPro LCD.

Log channel

If this check box is ticked then this channel will be logged in the data file.

Weir type

The weir type selected when the channel was added.

Depth channel

The depth channel selected for the weir calculation when the channel was added.

Flowrate units

Select the units and the timebase from the drop down list boxes. This sets the units on the logged value.

Flume width

Enter the width of the weir **in the units shown**. The units are defined according to the “*System settings*”.

26.3.6 Edit a “Flowrate (Weir)” channel type - *continued*

26.3.6.2 Flowrate (Weir): V-Notch weirs (30°, 45°, 60°, 90°)

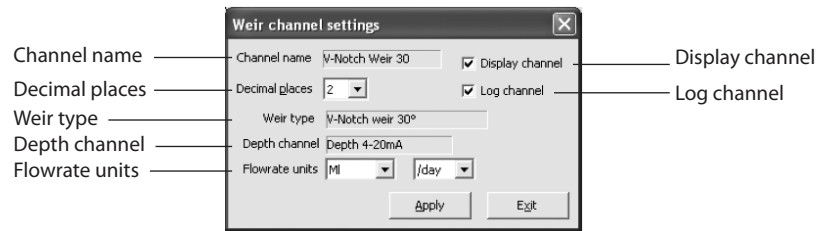

Channel name

This is the name given to the channel by the user when setup.

NOTE: This name will also show on the FloPro LCD screen if the **Display channel check box is ticked**

Decimal places

The user can set the number of decimal places (0, 1, 2, 3) using the drop down list box. These decimal places will be shown in both the data file and the LCD.

Display channel

If this check box is ticked then this channel will be displayed on the FloPro LCD.

Log channel

If this check box is ticked then this channel will be logged in the data file.

Weir type

The weir type selected when the channel was added.

Depth channel

The depth channel selected for the weir calculation when the channel was added.

Flowrate units

Select the units and the timebase from the drop down list boxes. This sets the units on the logged value.

26.3.6.3 Flowrate (Weir): Replogle, Palmer-Bowlus flumes

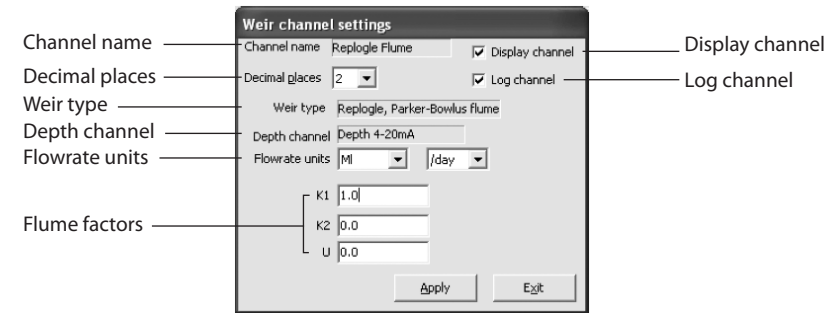

Channel name

This is the name given to the channel by the user when setup.

NOTE: This name will also show on the FloPro LCD screen if the **Display channel check box is ticked**

Decimal places

The user can set the number of decimal places (0, 1, 2, 3) using the drop down list box. These decimal places will be shown in both the data file and the LCD.

Display channel

If this check box is ticked then this channel will be displayed on the FloPro LCD.

Log channel

If this check box is ticked then this channel will be logged in the data file.

Weir type

The weir type selected when the channel was added.

Depth channel

The depth channel selected for the weir calculation when the channel was added.

Flowrate units

Select the units and the timebase from the drop down list boxes. This sets the units on the logged value.

Flume factors

Long-throated flumes are custom-designed. The values of K1, K2, and U are determined by the designer, using software such as **WinFlume** available from: http://www.usbr.gov/pmts/hydraulics_lab/winflume/index.html

26.3.6 Edit a “Flowrate (Weir)” channel type - *continued*

26.3.6.4 Flowrate (Weir): Parshall flume

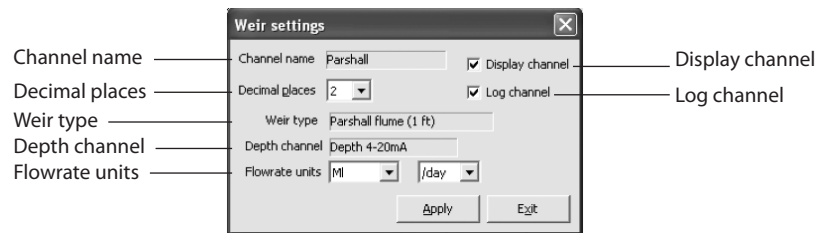

Channel name

This is the name given to the channel by the user when setup.

NOTE: This name will also show on the FloPro LCD screen if the Display channel check box is ticked

Decimal places

The user can set the number of decimal places (0, 1, 2, 3) using the drop down list box. These decimal places will be shown in both the data file and the LCD.

Display channel

If this check box is ticked then this channel will be displayed on the FloPro LCD.

Log channel

If this check box is ticked then this channel will be logged in the data file.

Weir type

The weir type selected when the channel was added.

Depth channel

The depth channel selected for the weir calculation when the channel was added.

Flowrate units

Select the units and the timebase from the drop down list boxes. This sets the units on the logged value.

26.3.7 Edit a “Total” channel type

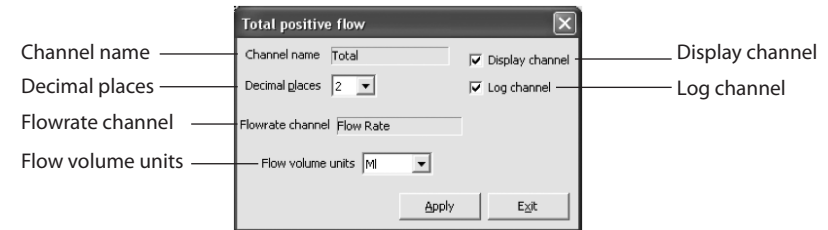

Channel name

This is the name given to the channel by the user when setup.

NOTE: This name will also show on the FloPro LCD screen if the Display channel check box is ticked

Decimal places

The user can set the number of decimal places (0, 1, 2, 3) using the drop down list box. These decimal places will be shown in both the data file and the LCD.

Display channel

If this check box is ticked then this channel will be displayed on the FloPro LCD.

Log channel

If this check box is ticked then this channel will be logged in the data file.

Flow volume units

Select the units from the drop down list box. This sets the units on the logged value.

Flowrate channel

“Total” is a derived channel type. This field defines from which named “Flowrate” channel the “Total” is being calculated.

26.3.8 Edit a “Event - pulse” channel type

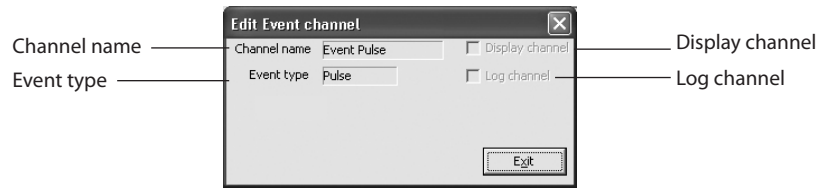

NOTE: None of these parameters can be edited

26.3.9 Edit a “Event - status change” channel type

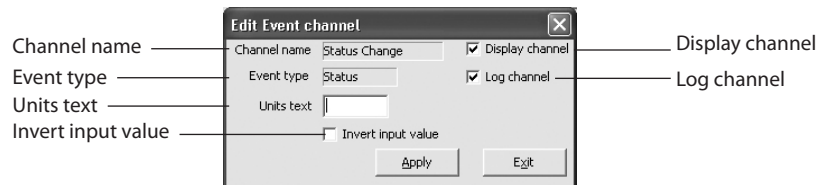

Channel name

This is the name given to the channel by the user when setup.

NOTE: This name will also show on the FloPro Series 3 LCD screen if the Display channel check box is ticked

Event type

This displays the type of event, either “Pulse” or “Status”.

Display channel

If this check box is ticked then this channel will be displayed on the FloPro Series 3 LCD.

Log channel

If this check box is ticked then this channel will be logged in the data file.

Units text

This sets the units on the logged value. This is a text field and is user defined.

Invert input value

If this check box is ticked then the value will be inverted before it is logged.

26.3.10 Edit a “Input total pulse” channel type

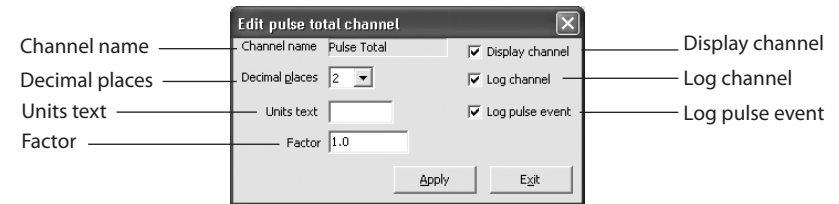

Channel name

This is the name given to the channel by the user when setup.

NOTE: This name will also show on the FloPro Series 3 LCD screen if the Display channel check box is ticked

Decimal places

The user can set the number of decimal places (0, 1, 2, 3) using the drop down list box. These decimal places will be shown in both the data file and the LCD.

Display channel

If this check box is ticked then this channel will be displayed on the FloPro Series 3 LCD.

Log channel

If this check box is ticked then this channel will be logged in the data file.

Log pulse event

If this check box is ticked a “Status” message is logged in the data file when the event occurs.

Units text

This sets the units on the logged value. This is a text field and is user defined.

Factor

This field scales the pulse to match the units being used. For example, if 1 kilo litre pulses and mega litre units are used, the factor would be 0.001 where as if 1 kilo litre pulses and kilo litre units are used, the factor would be 1.0

26.3.11 Edit a “Binary” channel type

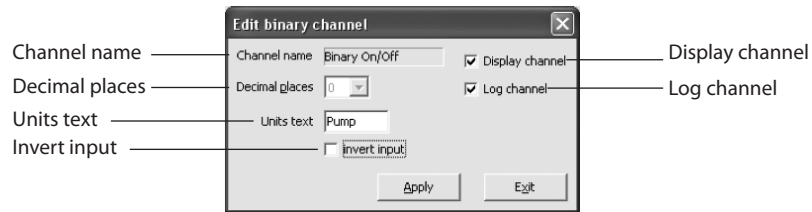

Channel name

This is the name given to the channel by the user when setup.



NOTE: This name will also show on the FloPro LCD screen if the **Display channel** check box is ticked

Decimal places

This field is greyed out as the “Binary” channel cannot have decimal places configured.

Display channel

If this check box is ticked then this channel will be displayed on the FloPro LCD.

Log channel

If this check box is ticked then this channel will be logged in the data file.

Units text

This sets the units on the logged value. This is a text field and is user defined. In this example the “Binary” channel is being used to monitor the on/off condition of a pump. In the data the word “Pump” will be logged whenever the pump is on.

Invert input

If this check box is ticked then the value will be inverted before it is logged.

27.0 Configure outputs

From the “FloPro settings” dialogue box, click “Configure outputs” and the “Configure outputs” dialogue box will appear.

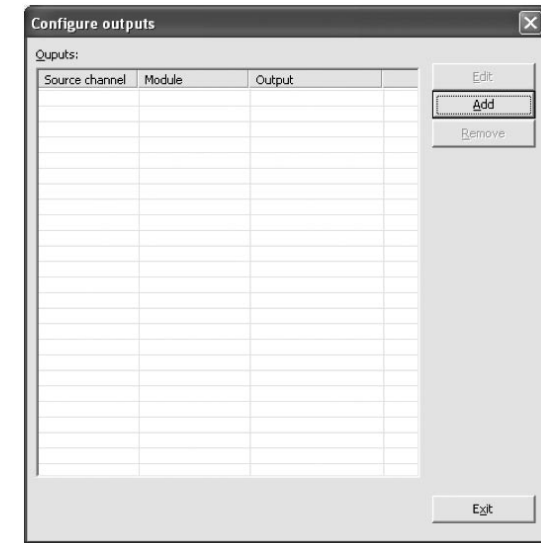

27.1 Adding outputs

From the “Configure outputs” dialogue box click “Add” and the “Select output type” dialogue box will appear.

27.1.1 Adding a 4-20mA output

1. From the “Select output type” dialogue box highlight “4..20mA out” and click “Continue”. The “Select output” dialogue box will appear.

2. Select the “4..20mA output #X” that you wish to use and click “Continue”. The “Select source channel” dialogue box will appear.

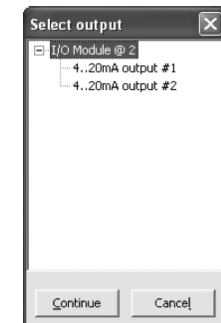
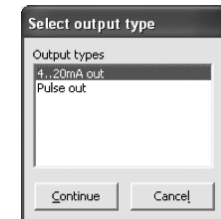

27.1 Adding outputs - Continued

3. Select the “*Channel*” from the drop down list that you wish to output. In this example the channel named “*Flow Rate*” will be output from “*I/O Module @ 2*” on “*4..20mA output #1*”. Click “*Continue*” to complete the new output. The “*Configure outputs*” dialogue box will re-appear with the new output listed.

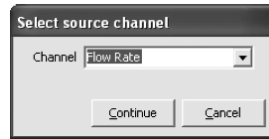

NOTE: Only channels that are suitable for outputting as a 4-20mA proportional current will be available for selection

27.1.2 Adding a pulse output

1. From the “*Select output type*” dialogue box highlight “*Pulse out*” and click “*Continue*”. The “*Select output*” dialogue box will appear.

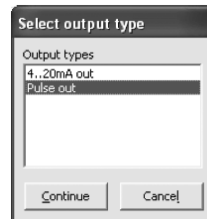

2. Select the “*Digital output #X*” that you wish to use and click “*Continue*”. The “*Select source channel*” dialogue box will appear.

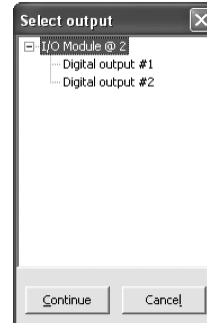

3. Select the “*Channel*” from the drop down list that you wish to output. In this example the channel named “*Total*” will be output from “*I/O Module @ 2*” on “*Digital output #1*”. Click “*Continue*” to add the new output. The “*Configure outputs*” dialogue box will re-appear with the new output listed.

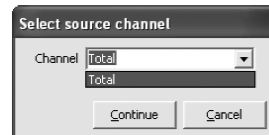

NOTE: Only channels that are suitable for “*Pulse*” outputting will be available for selection

27.2 Editing outputs

WARNING: All configured output channels **MUST** be edited prior to starting the FloPro. Editing the channel/s enables the correct configuration information to be sent to the controller module.

From the “*FloPro Settings*” dialogue box click “*Configure outputs*” and the “*Configure outputs*” dialogue box will appear.

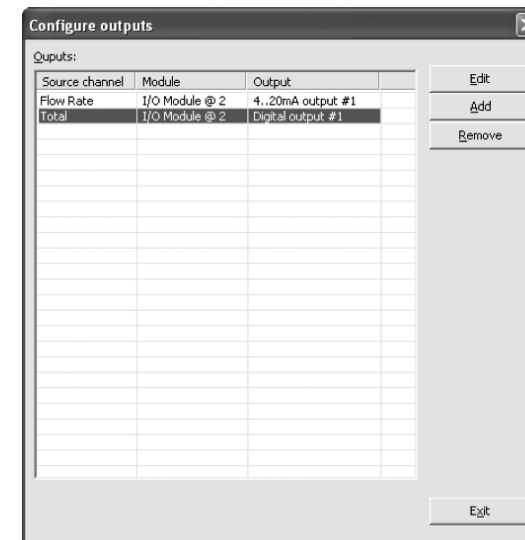

1. Highlight the channel you wish to edit and click “*Edit*”. An output specific “*Edit output*” dialogue box will appear.

2. Edit the settings in the “*Edit output*” dialogue box to suit your application as per the recommendations on the following page. Click “*Apply*” to save the settings and return to the “*Configure outputs*” dialogue box.

Removal of outputs

From the “*Configure outputs*” dialogue box highlight the “*Output*” you wish to remove and click “*Remove*”. You will be prompted to confirm the removal.

27.2 Editing outputs - Continued

27.2.1 Editing a 4-20mA output



Value at 4mA

The value of the “*Source*” channel at which the “*4-20mA output*” will be set to 4mA.

Value at 20mA

The value of the “*Source*” channel at which the “*4-20mA output*” will be set to 20mA.

Averaging

The user can elect to output an **averaged** value on the “*4-20mA output*” by checking the box. When checked, the “*4-20mA output*” will only be updated at the FloPro logging interval otherwise it is updated at each measurement interval. In the case of the measurement interval being shorter than the logging interval, then the “*4-20mA output*” will be the average of those values calculated per measurement interval.

! Click “*Apply*” to save the settings then click “*Exit*” to return to the “*Configure outputs*” dialogue box.

27.2.2 Editing a pulse output

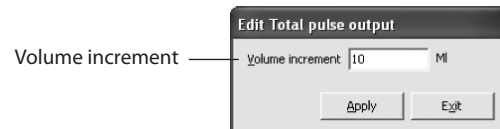

Volume increment

The incremental value at which a pulse will be sent. In the example above, a pulse will be sent whenever an increment of 10 Megalitres is totalised.

! **NOTE: A maximum of 10 pulses per second may be sent per measurement interval. For example, during a measurement interval of three minutes (180 seconds) a maximum of 1,800 pulses can be sent. If the FloPro has not sent all pulses by the time of the next measurement, pulses WILL be lost.**

! Click “*Apply*” to save the settings then click “*Exit*” to return to the “*Configure outputs*” dialogue box.

28.0 Configuring FloSI Card

The Flo Series Serial Interface (FloSI) is an optional upgrade module for FloPro Series3 devices. The FloSI provides unconditional polling access to the most recent user configured measurement results of the FloPro Series3.

! **NOTE: Only one FloSI per FloPro Series3 device is supported**

RS-232, RS-485 and SDI-12, interfaces are available from the FloPro Series3 with the use of a FloSI. The FloSI enables users to request the last measurement from FloPro without the complexity of communicating via the host communications port.

The FloSI cannot be used to download or configure a FloPro, and only one serial protocol may be used at one time.

The FloSI requires no routine maintenance and has no user serviceable components.

Configuration of the FloSI requires **MACE Flocom+ (Version 1.1.0.12 or later)** software and successful PC communications with a MACE FloPro Series3 device (**Firmware Version 1.00.4 or later**). The FloSI configuration settings are available from the “*FloPro settings*” dialogue box.

28.1 Configuring a FloSI

1. Establish communications with the device as per **Chapter 22 - Connecting to the device**.
2. Ensure at least one module and one channel is configured as per **Chapters 25 - 26**. Check the **FloSI enabled** check box.

3. Click “*Configure FloSI*” and the “*FloSI settings*” dialogue box will appear.

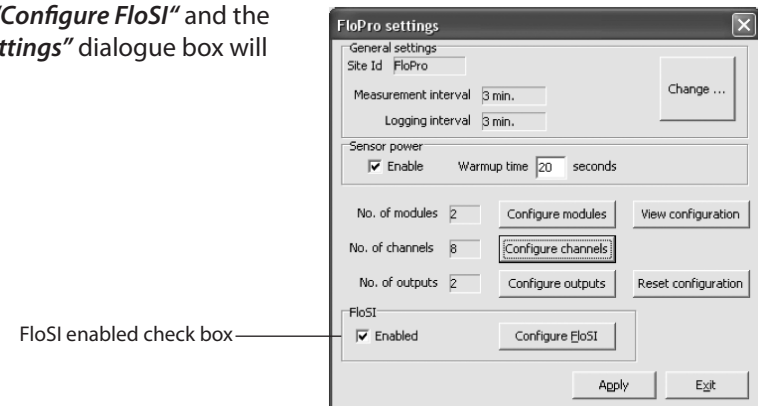

28.1 Configuring a FloSI - Continued

4. Click “Change” and the “Select output mode” dialogue box will appear.

5. From the drop down list select the output mode you wish to use. Click “Apply” and the updated “FloSI settings” dialogue box will appear.

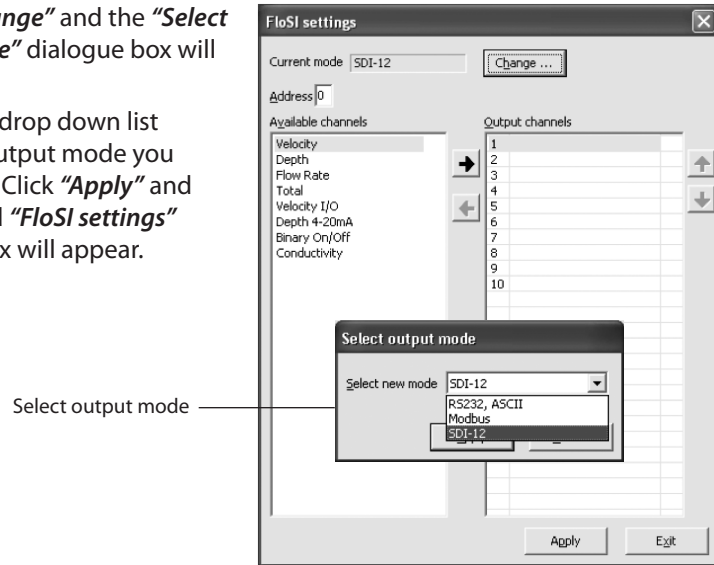

28.2 Serial Interface Settings

The FloSI can only be configured to use one serial protocol from the three available. The parameter values are provided in the user configured units.

28.2.1 RS-232, ASCII Mode

The line transmission characteristics are as follows:

Baud rate:	9600
Data bits:	8
Parity:	None
Stop bits:	1

In this mode, the FloSI is dormant while RTS is inactive. On RTS going active, the FloSI transmits the most current result string from the FloPro Series3. If RTS is active when a scheduled sample is made, then the string is transmitted immediately on completion of the measurement.

The transmitted ASCII text string starts with the character ‘*’ (asterisk), ends with a carriage return and contains the configured number of channel values. The number and order of channel values in the output string can be configured using Flocom+. Each channel value in the string always begins with either a ‘+’ (plus sign) or ‘-’ (minus sign) - there are no spaces between values.

28.2.2 MODBUS Mode

The MODBUS implementation complies with the MODBUS over Serial Line Specification V1.0 and MODBUS Application Protocol Specification V1.1.

The external port is either a standard “RS232” port or a two-wire “RS485” port, depending on the selected MODBUS mode. The MODBUS parameters are configurable by entering the appropriate “Address”, selecting the correct “Baudrate” from the drop down list and checking the required radar buttons.

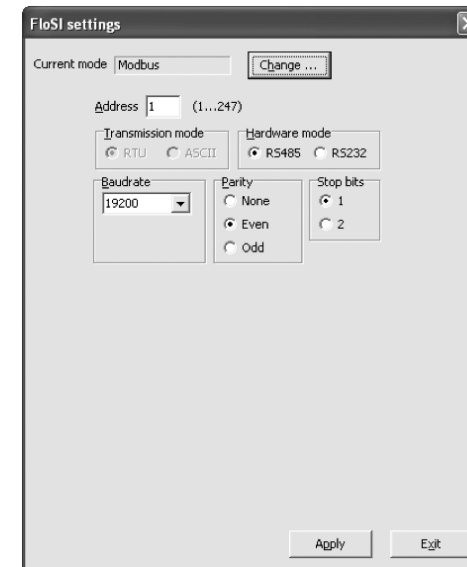

WARNING: The user must ensure that there are no two devices with the same address on the same bus. In such a case, the behaviour of the bus is unpredictable

28.2 Serial Interface Settings - continued

SUPPORTED FUNCTION CODES:

Command	Code (hex)	Sub-code (dec)
Read Input Registers	04	
Diagnostics	08	00-04,10-18

REGISTER MAP:

Parameter	FloPro Output ⁵	Type	Size (bits)	# Registers	Register(s)
Channel 1	Velocity	float	32	2	40001-40002
Channel 2	Depth	float	32	2	40003-40004
Channel 3	Flow Rate	float	32	2	40005-40006
Channel 4	Total	float	32	2	40007-40008
Channel 5	Velocity I/O	float	32	2	40009-40010
Channel 6	Depth 4-20mA	float	32	2	40011-40012
Channel 7	Binary On/Off	float	32	2	40013-40014
Channel 8	Conductivity	float	32	2	40015-40016
Channel 9	-	float	32	2	40017-40018
Channel 10	-	float	32	2	40019-40020
Channel 11	-	float	32	2	40021-40022
Channel 12	-	float	32	2	40023-40024
Channel 13	-	float	32	2	40025-40026
Channel 14	-	float	32	2	40027-40028
Channel 15	-	float	32	2	40029-40030
Channel 16	-	float	32	2	40031-40032
Channel 17	-	float	32	2	40033-40034
Channel 18	-	float	32	2	40035-40036
Channel 19	-	float	32	2	40037-40038
Channel 20	-	float	32	2	40039-40040

Notes:

1. Register byte order is big-endian
2. Float values are formatted according to IEEE 754 32-bit representation
3. Flow total has a range from 0 to 999999.9
4. Registers corresponding to parameters, which are not configured to be measured or calculated, contain random values.
5. FloPro channel outputs are in order of channel configuration as per FloPro settings. Refer to Chapter 26.2.1 for ordering configured channels.

WARNING: The outputs listed in this table are for illustrative purposes only.

28.2.3 SDI-12 Mode

The SDI-12 implementation complies with V1.3 of the SDI-12 specification.

Configurable parameters are:

- Address ('0'-'9', 'A'-'Z', 'a'-'z')
- Which measurement results to provide

On receiving an SDI-12 Measurement command, the FloSI replies with notification that the measurement results are immediately available. Upon receiving a Send Data command, the FloSI returns the currently available result data which it has been configured to provide.

THE FOLLOWING SDI-12 COMMANDS ARE SUPPORTED:

Name	Command	Response
Acknowledge active	a!	a<CR><LF>
Send Identification	a!	a13MACE P/FloSI3100#nnnn<CR><LF>
Address Query	?!	a<CR><LF>
Start Measurement	aM!	a000n<CR><LF>
Start Measurement and Request CRC	aMC!	a000n<CR><LF>
Send data	aD0! to aD9!	a<values><CR><LF> or a<values><CRC><CR><LF>
Additional Measurements	aM1! to aM9!	a0000<CR><LF>
Additional Measurements and Request CRC	aMC1! to aMC9!	a0000<CR><LF>
Start Verification	aV!	a0000<CR><LF>
Start Concurrent Measurement	aC!	a000n<CR><LF>
Start Concurrent Measurement and Request CRC	aCC!	a000n<CR><LF>
Additional Concurrent Measurements	aCC1! to aCC9!	a0000<CR><LF>
Continuous Measurement #0	aR0!	a<values><CR><LF>
Continuous Measurements #1 to 9	aR1! to aR9!	a<CR><LF>
Continuous Measurement #0 and Request CRC	aRC0!	a<values><CRC><CR><LF>
Continuous Measurements #1 to 9 and Request CRC	aRC1! to aRC9!	a<CRC><CR><LF>

28.3 Ordering the SDI-12 or ASCII Output String

The number and order of channel values in the output string for SDI-12 or RS232, ASCII output can be configured using Flocom⁺.

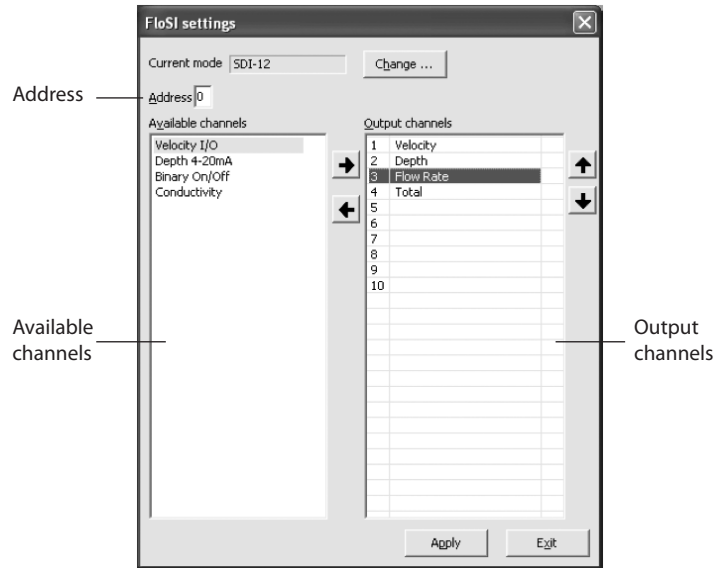

1. From the “FloSI settings” dialogue box, move the required channels from the “**Available channels**” table to the “**Output channels**” table by highlighting the desired channel in the “**Available channels**” table and clicking the **right arrow**. If a channel in the “**Output channels**” table is no longer required, highlighting it and clicking the **left arrow** will remove it from the “**Output channels**” table. The position of a channel in the “**Output channels**” table can be changed by highlighting the channel and clicking the **up** or **down arrow**.



The user must ensure that there are no two devices with the same address on the same bus. In such a case, the behaviour of the bus is unpredictable

29.0 About real time data

MACE Flo-Series instruments measure average stream velocity using Doppler ultrasonic technology. Anything moving in the stream, which is acoustically reflective, may produce an echo and therefore a Doppler shift. Acoustically reflective particles include:

- Suspended solids;
- Bubbles, eddies and waves;
- Larger particles such as, sand, leaves and pebbles.

When selected in FloCom⁺, the user can display a real-time graph of the velocity spectrum received by the velocity sensor. The histogram you see in real-time data is a composite spectrum of the velocities of the stream flow as well as various other factors explained below.

- The graph is two dimensional (X-Y).
- The X-axis is the velocity (range set by user).
- The Y-axis (vertical) is the strength of the signal received by the processing electronics from each velocity sensed in the spectrum.
- Several thousand data points are plotted to give the composite graph.

MACE Flo-Series instruments measure several thousand data points and compute an average velocity. The flow is then calculated using the formula:

$$Q=V \times A$$

where: *Q*= Quantity, *V*= Stream velocity and *A*= Cross-sectional area.

Users of MACE Flo-Series instruments can use the real time graph to determine the correct positioning of the velocity sensor by assessing the shape of the curve and the signal strength. The following graph is an example of a spectrum that was received from a full pipe irrigation flow. Under field conditions, several factors can affect the spectrum without affecting the performance or accuracy of the velocity sensor.

Armed with an understanding of these factors and some field experience, the operator can vary the position of the sensor and the system settings to correct site induced errors in the velocity readings.

29.0 About real time data - *continued*

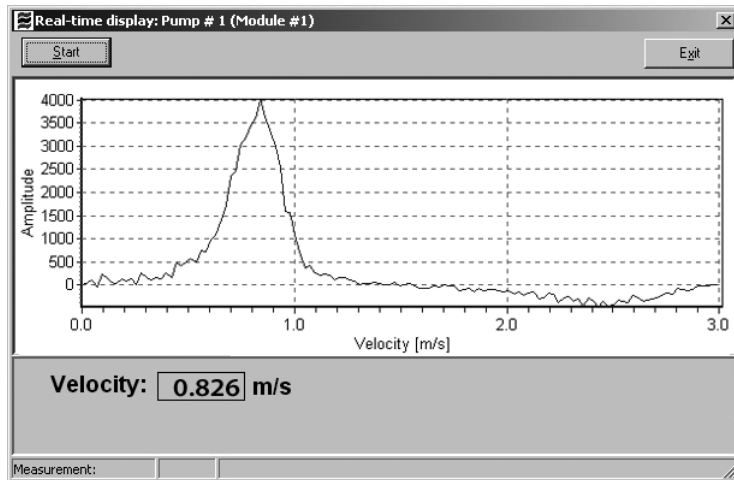

Factors affecting the velocity sensor

This chapter is designed to give the operator a brief understanding of some of the factors affecting the performance of the MACE Flo-Series velocity sensor.

In flowing streams, there are always a range of different velocities present, particularly in turbulent water where the effects of eddies and boundary layers can cause the velocity histogram to appear distorted in the diagram below. Although distorted, MACE Flo-Series instruments have powerful signal processing algorithms, which determine the average stream velocity from these signals.

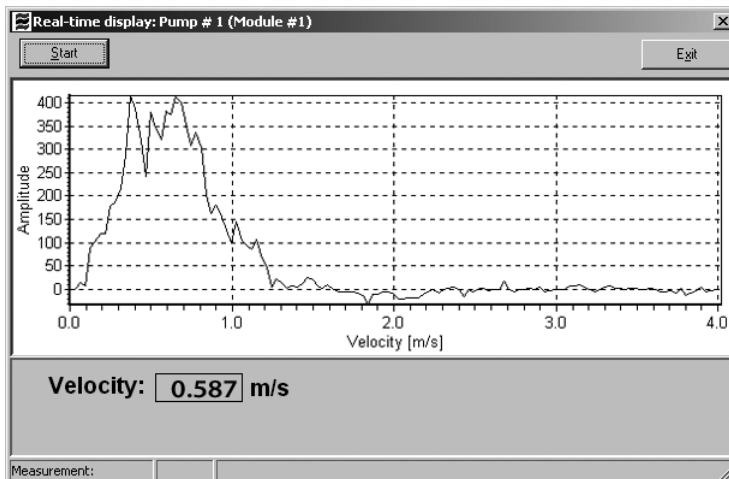

If the operator is receiving data such as displayed in the diagram above, the sensor may be moved slightly to try to overcome the distortion. Furthermore, the operator should inspect the positioning of the sensor to ensure that there is not a build-up of debris or other matter, close to the sensor head. If no obstruction is observed and re-positioning the sensor does not improve the data, you can be assured that the sensor is operating effectively and that the displayed data is a site induced phenomenon.

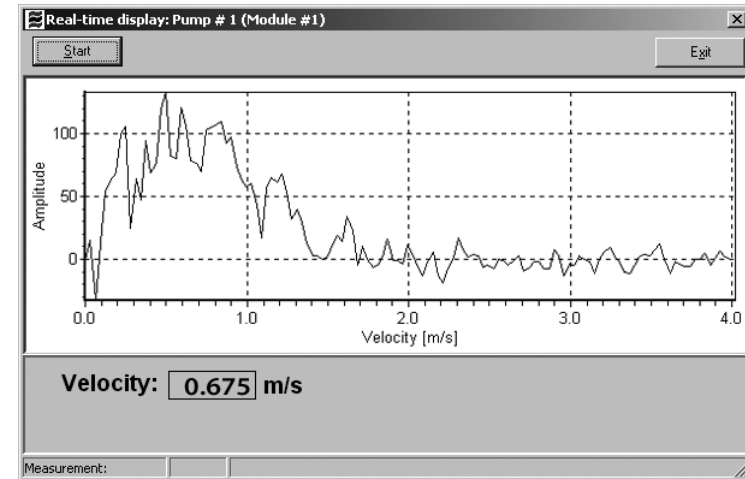

If data such as that seen above is received, the operator should ensure that the sensor is positioned correctly and monitor the site for any obstructions close to the sensor. If no obstructions are located close to the sensor, the site may be unsuitable to flow measurement with Doppler ultrasonic flow devices.

The signal strength of received echoes on the real-time histograms, is a measure of the number of reflective particles moving in the stream. Therefore, low signal strengths do not necessarily equate to poor velocity readings. Relatively few particles may provide enough echoes for an accurate average velocity reading. Furthermore, a histogram with a broad base will generally tend to have a peak with a lower signal strength. In sites where it is suspected that there are relatively few reflective particles in the flow, the period in which the MACE Flo-Series instrument takes readings may require extending (see, Integration Period on page 69).

29.0 About real time data - *continued*

A general rule of thumb, if a spectrum has low signal strength but gives a consistent velocity reading, then the measurements should be accurate. However, if the spectrum has low signal strength and gives inconsistent velocity readings or none at all, the site may be unsuitable for flow measurement with Doppler ultrasonic flow devices.

Very distorted signals such as that described in the diagram on the previous page may result from interference to the velocity sensor by the build-up of debris or siltation.

In sites where there is an expectation of sedimentation, the velocity sensor should be mounted in a raised position. In a full-pipe application, it is recommended that the sensor be mounted (or inserted) on the side of the pipe to avoid sedimentation.

Similarly, in partially full pipes, the sensor may be offset from the invert of the pipe. In these instances, the depth reading will need to be offset accordingly.

Covering the sensors with algae and other materials that are saturated generally does not affect the accuracy of velocity readings. This is because saturated materials exhibit the same speed of sound as water.

MACE Flo-Series instruments include several signal processing features specifically designed to overcome anomalous data produced by such phenomena as: aquatic life (fish, weeds, small invertebrates); surface waves (produced by turbulence and wind); and background noise.

It should always be remembered when examining real-time graphical data, that settings within the unit itself can have a marked effect on the data displayed. The configuration of the instrument should always be checked thoroughly before viewing real-time data.

30.0 Real time data

From the main menu click **“Real time data”** and the following menu options will appear as listed below:

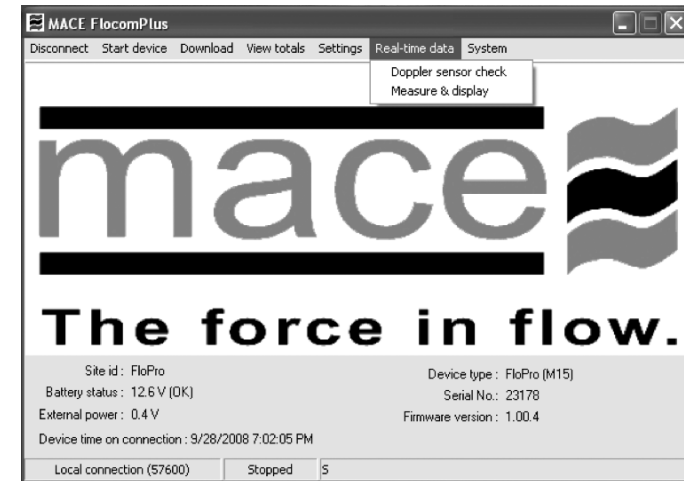

Doppler sensor check

1. Click **“Doppler sensor check”** and the **“MACE Doppler real time data”** dialogue box will open.
2. Highlight the channel that you wish to observe, click **“Display”** and the **“Real time display”** will open.
3. Should you wish to save Real Time graphs in a file check the **“Save data to file”** check box.
4. Click **“Start”** to begin measurements.

If you checked **“Save data to file”** a Windows® **“Save As”** dialogue box will appear. Save the file to a location of your choice and Doppler measurements will start.

5. When you have viewed/saved sufficient graphs, click **“Stop”** to end measurements then **“Exit”** to return to the main menu.

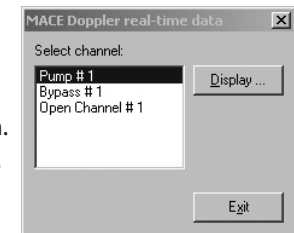

Measure and display

1. Click **“Measure and display”** then **“Start”** to observe the current channel values.
2. Click **“Stop”** then **“Close”** to return to the main menu.

31.0 Start/Stop device

Once the FloPro Series3 has been configured and tested it is ready to be started so that measuring and logging is initiated.



WARNING - If the device is NOT started measurements will NOT occur

From the main menu click **“Start device”** and you will be asked **“Are you sure?”**. Click **“Yes”** and the device will start and you will be returned to the main menu. You will notice that the **“Start Device”** has changed to **“Stop device”** in the main menu.



To enable changing of settings, access of real-time data and resetting totals, the FloPro must first be stopped.

From the main menu click **“Stop device”** and you will be asked **“Are you sure?”**. Click **“Yes”** and the device will stop and you will be returned to the main menu. You will notice that the **“Stop Device”** has changed to **“Start device”** in the main menu.

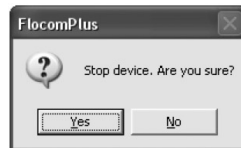

32.0 Disconnect

From the main menu click **“Disconnect”** and you will be asked **“Are you sure?”**. Click **“Yes”** and the device will be disconnected and you will be returned the start up menu. Click on **“File>Exit”** to shut down FloCom+.

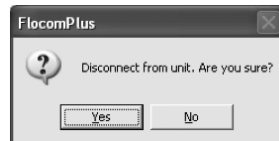

WARNING - If FloCom+ is not disconnected from the device excess current will be drawn from the main battery

33.0 View totals

From the main menu click **“View totals”** and the **“Flow volume totals”** dialogue box will appear.

This dialogue box lists all the accumulated flow channels and their respective totals and units.

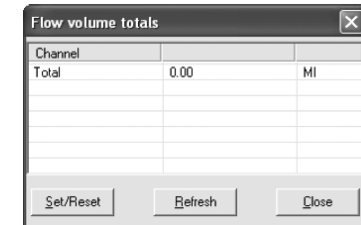

If the FloPro has not been started, the **“Set/Reset”** button will be active and the totalised reading can be changed.



It is strongly advised to download the logged data PRIOR to resetting the total value

1. Highlight the channel you wish to reset by clicking on its name.
2. Click **“Set/Reset”** and the **“Set total value”** dialogue box will appear.

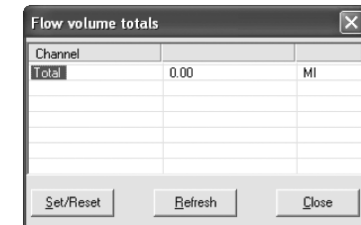

3. Enter the **“New value”** into the field and click **“Set value”**. The new value will then be displayed in the **“Flow volume totals”** dialogue box.

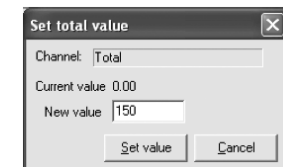

Double check that this value is CORRECT

4. If the FloPro has not been stopped, the **“Set/Reset”** button will be greyed out and the total/s will not be re-settable.
5. To update the reading whilst flow is accumulating, click **“Refresh”**.

34.0 Downloading stored data

From the Start up screen click **“Connect >Direct”** to display the main menu.

Select **“Download”** to initiate the stored data download procedure.

A save file dialogue box will appear. The default file name is the unit ID. The default target directory is the directory into which the previous download file was stored.

Click **“OK”** once you are ready to download the device. The **“download”** dialogue box will appear which shows the amount of stored data in the device and the date of the earliest available record. If the download end time is left unchanged or set to a time earlier than the earliest record, all stored records will be downloaded. Otherwise, only those data stored after the chosen **“Download from”** date will be downloaded.

Click **“Start download”** to complete the download procedure.

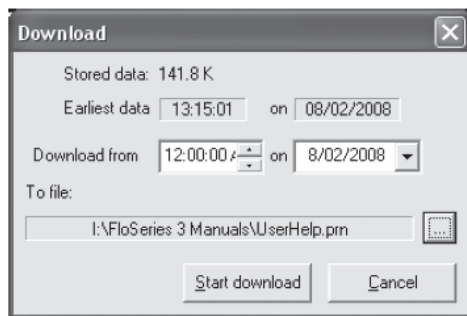

35.0 View downloaded data file

This function is accessed via the **“File”** menu and then selecting the **“View downloaded file”** option. The **“File”** menu is only available when not connected to the FloPro Series 3.

Opening a file

On entry, an open file prompt window is displayed. If downloaded data was saved during the current session, the last downloaded data file appears as the default selection. On selecting **“Open”** the selected file is loaded and if successful the data is displayed as a text file. A different downloaded data file may be selected at any time by selecting the local **“File”** function and repeating the file selection procedure.

Viewing a file

Time stamp tree view

This pane enables the user to quickly navigate the data file by date and time. Expand the tree on the date of interest by clicking the **“+”** to reveal the various time stamps. Click the time stamp you wish to view and the data file will automatically scroll to it.

Time stamp tree view | **Header information**

```
File: M:\FloPro-Download.csv
File
  Header
  2008/11/04
    13:43:08
  End
!Program,FlocomPlus,1.1.1.5
!Download Start,2008/11/04 15:36:24
!Device,FloPro
!SerialNo,123456
!Ident,"FloPro"
!Version,1.00.12
!Device Time,2008/11/04 14:36:24
!Battery,"OK",13.80V
!
!Channels,5
!Names,"Depth","Flow Rate","Flow Total","Pulse Total","Pump Status"
!Units,"m","M/day","Ml","kl",""
!
!Points,11
!Interval,300
2008/11/04 13:43:08,*Note,"Unit started"
2008/11/04 13:45:00,1,115.78,0.16,0,1
2008/11/04 13:45:00,*Note,"No external power"
2008/11/04 13:50:00,1,115.78,0.56,0,1
2008/11/04 13:53:10,*PulseEvent,"Pulse Total",1
2008/11/04 13:55:00,1,115.78,0.96,1,1
2008/11/04 14:00:00,1,115.78,1.36,1,1
2008/11/04 14:00:00,*Note,"External power restored"
2008/11/04 14:01:21,*StatusChange,"Pump Status",0
2008/11/04 14:05:00,1,115.78,1.76,1,0
2008/11/04 14:09:50,*PulseEvent,"Event Pulse",1
2008/11/04 14:10:00,1,115.78,2.17,1,0
2008/11/04 14:15:00,1,115.78,2.57,1,0
2008/11/04 14:19:51,*StatusChange,"Pump Status",1
2008/11/04 14:20:00,1,115.78,2.97,1,1
2008/11/04 14:25:00,1,115.78,3.37,1,1
2008/11/04 14:26:30,*PulseEvent,"Pulse Total",1
2008/11/04 14:30:00,1,115.78,3.77,2,1
2008/11/04 14:35:00,1,115.78,4.18,2,1
!
!Download End,2008/11/04 15:36:24
```

Status messages

Time stamped data

End of file

35.0 View downloaded data file - *continued*

Header information

At the top of each data file the following information is displayed:

- Version of FloCom+ used to download the file;
- Time and date the data was downloaded to the PC;
- Device type; ie AgriFlo, FloPro or HydroMace 3000;
- Serial number of the electronics module;
- Version of firmware installed in the electronics module;
- Time and date of the clock in the electronics module;
- Battery status and charge (voltage) of the electronics module;
- Number of channels being recorded;
- The names of each channel being recorded;
- The units of measure used for each channel being recorded;
- 'Points' refers to the number of data lines in the downloaded file;
- 'Interval' refers to the time in seconds between each time stamp (logging interval).

Status messages

Status messages are defined by the use of an asterisk (*) immediately following a time stamp. For example, in the download on the previous page the following message appears which tells the user the date and time the unit was started.

```
2008/11/04 13:43:08,*Note,"Unit started"
```



NOTE: Refer to the table over page for a full listing of status messages

Time stamped data

At each time stamp the date, time and recorded channel values are shown. In the example below the date and time are followed by the recorded values for each of the five configured channels which are Depth, Flow Rate, Flow Total, Pulse Total and Pump Status..

```
2008/11/04 13:45:00,1,115.78,0.16,0,1
```

End of file

The end of the data file is always delineated by a 'Download End' followed by the date and time.

Status message table

Status message	Description
Unit started	FloPro was started
Unit stopped	FloPro was stopped
No external power	No external power is detected. If a solar panel is used this will occur at sunset.
External power restored	External power is detected. If a solar panel is used this will occur at sunrise.
Low Battery	Time at which battery voltage fell below 11.5V
Battery normal	Time at which battery voltage exceeded 11.5V
Flat battery condition	Battery voltage at download time is less than 10V
Battery was flat	Battery was less than 10V
Sensor not detected	MACE Doppler sensor not detected
Sensor error	MACE Doppler/IO module not detected
Device reset #0	Power up reset occurred
TOD clock error	Error reading Time-of-day clock
Pulse event	A pulse from a pulse event channel has occurred
Status change	The value on a status event channel has changed

Appendix A - Flume/weir coefficients

V-notch weir factors

θ , degrees	C_e (same for all systems of units)	k_h , ft	k_h , m
30	0.586	0.007	0.0021
45	0.58	0.005	0.0015
60	0.577	0.0038	0.0012

Parshall flume factors

Width of flume	C (for use with h_a in feet)	C (for use with h_a in meters)	n (same for cfs or kL/sec)
1-inch	0.338	0.0604	1.55
2-inch	0.676	0.1207	1.55
3-inch	0.992	0.1771	1.55
6-inch	2.06	0.381	1.58
9-inch	3.07	0.535	1.53
1-ft	3.95	0.705	1.55
1.5-ft	5.975	1.067	1.55
2-ft	8	1.429	1.55
3-ft	12	2.19	1.57
4-ft	16	2.96	1.58
5-ft	20	3.75	1.59
6-ft	24	4.49	1.59
7-ft	28	5.31	1.6
8-ft	32	6.14	1.61
10-ft	39.38	7.46	1.6
12-ft	46.75	8.86	1.6
15-ft	57.81	10.96	1.6
20-ft	76.25	14.45	1.6
25-ft	94.69	17.94	1.6
30-ft	113.13	21.4	1.6
40-ft	150	28.4	1.6
50-ft	186.88	35.4	1.6

Mace USA LLC

PO Box 7144

Overland Park, KS 66207

United States of America

Ph: 888 440 4215 Fax: 888 440 6999

Email: sales@maceusa.com

www.maceusa.com

Measuring & Control Equipment (MACE) P/L

PO Box 911, Pennant Hills

NSW 1715, Australia

Ph: (02) 9658 1234 Fax: (02) 9651 7989

Email: sales@macemeters.com

www.macemeters.com



Water Monitoring Solutions