

Agriflo

Series 3



Mace USA LLC

PO Box 7144

Overland Park, KS 66207

United States of America

Ph: 888 440 4215 Fax: 888 440 6999

Email: sales@maceusa.com

www.maceusa.com

Measuring & Control Equipment (MACE) P/L

PO Box 911, Pennant Hills

NSW 1715, Australia

Ph: (02) 9658 1234 Fax: (02) 9651 7989

Email: sales@macemeters.com

www.macemeters.com

mace 

Water Monitoring Solutions

QUICK START GUIDE



www.macemeters.com

mace 

Water Monitoring Solutions

1. Introduction

This Quick Start Guide describes the basic installation of the AgriFlo Series 3. The detailed *"AgriFlo Series 3 Product Manual"* is available for download from www.macemeters.com

The AgriFlo Series 3 typically consists of four main components:

- The electronics module
- The sensor(s)
- The solar panel (or power supply)
- Flocom⁺ software enabling you to configure and download your AgriFlo Series 3

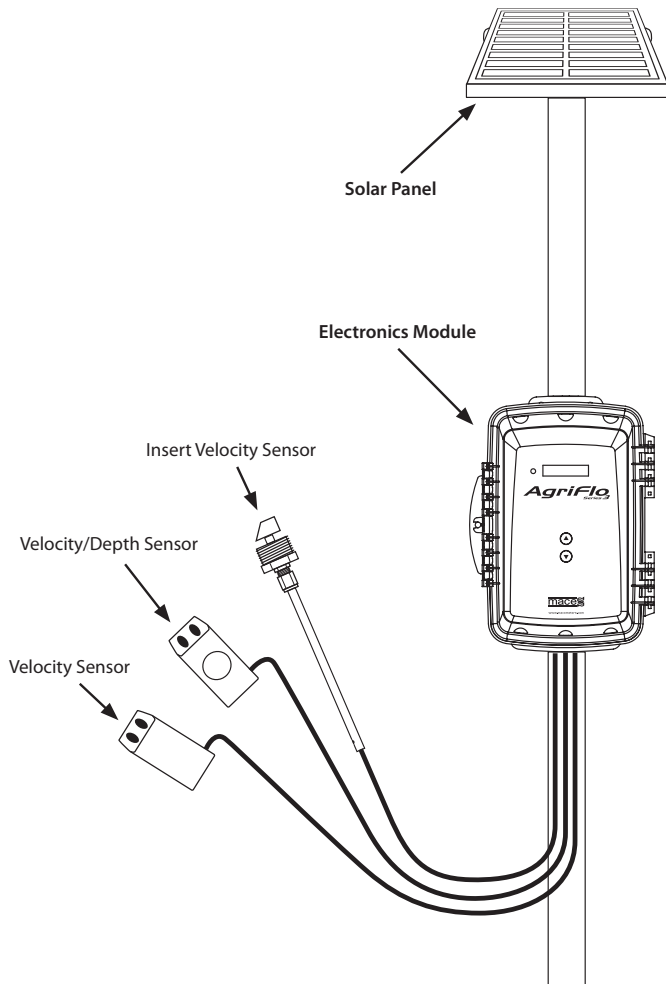

ELECTRONICS MODULE - FRONT

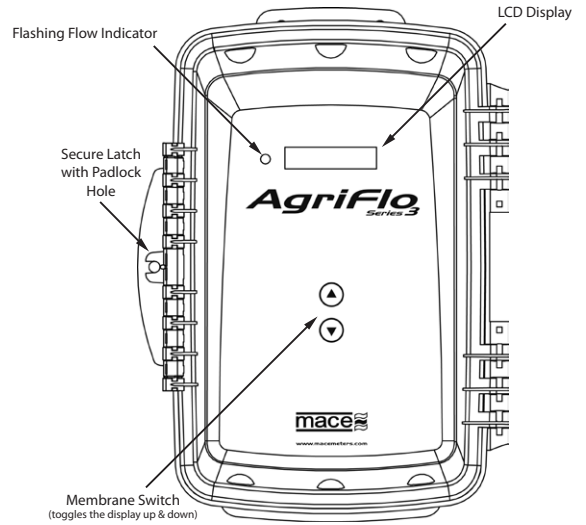

ELECTRONICS MODULE - INSIDE

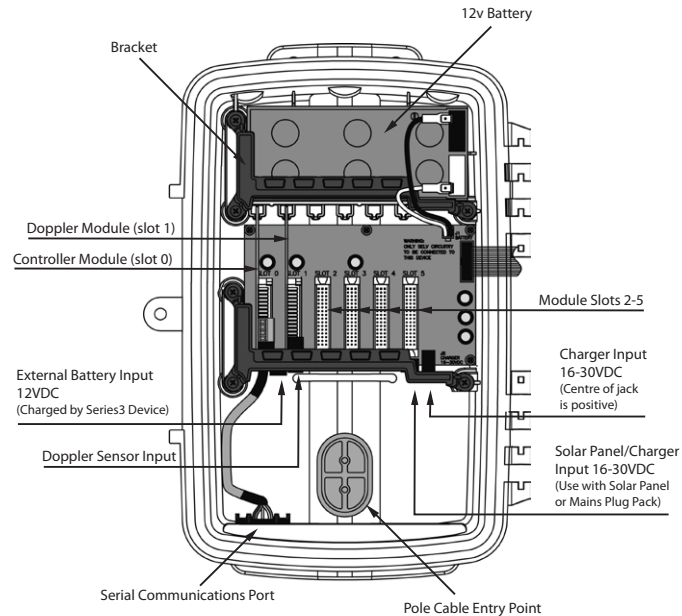

NOTE: Door not shown
Conduit Cable Entry Point

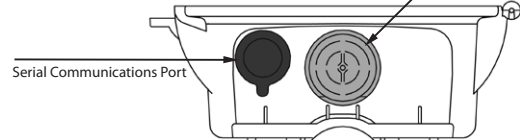

ELECTRONICS MODULE - UNDERSIDE

2. Site selection & sensor installation

When selecting a suitable site to measure flow and mount the instrument, you must consider the following:

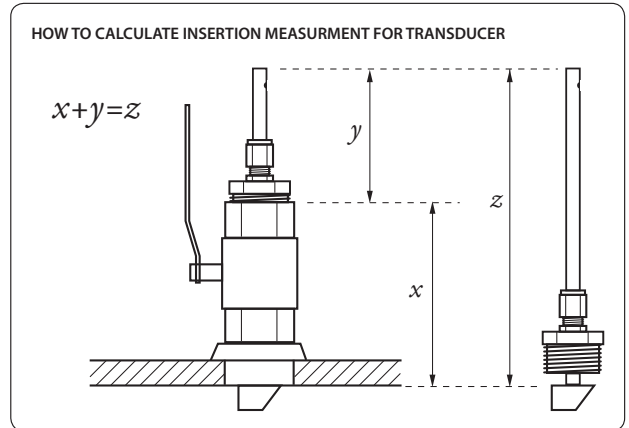
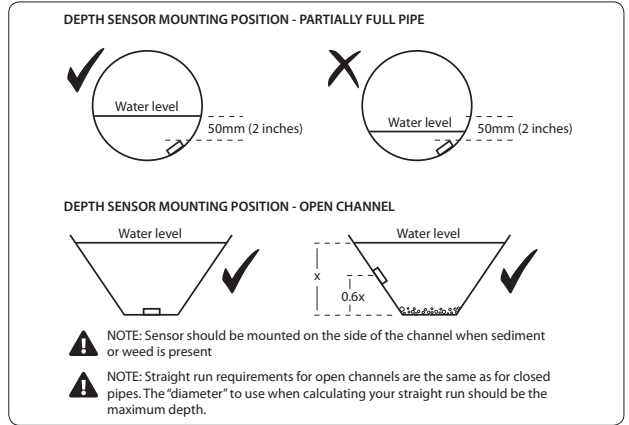
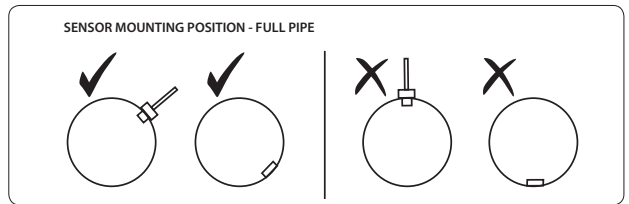
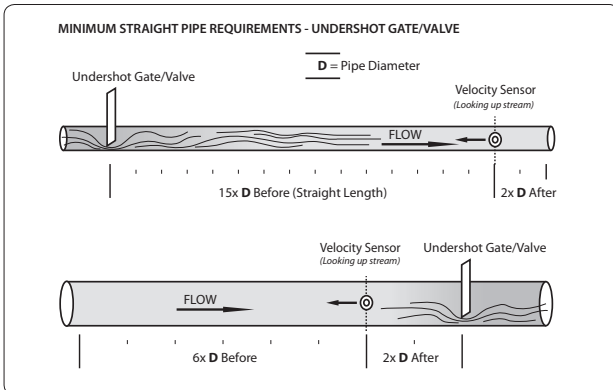
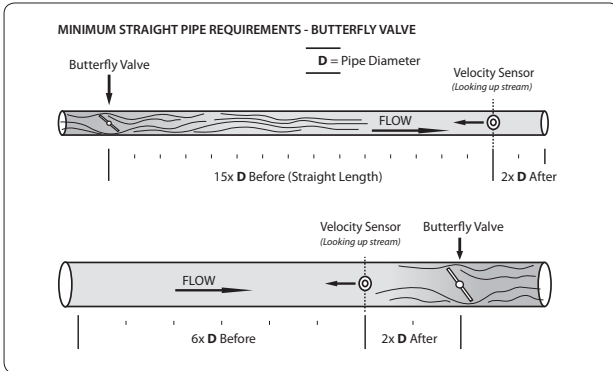
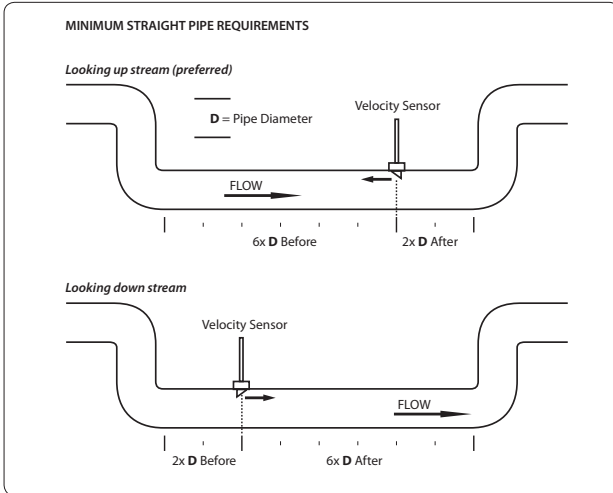

Once the insertion depth is correct, rotate the sensor so that the grub screw at the top of the sensor shaft is accurately pointing in the direction of the straight section of pipe. Tighten the 3/4" gland nut to lock the sensor in place.

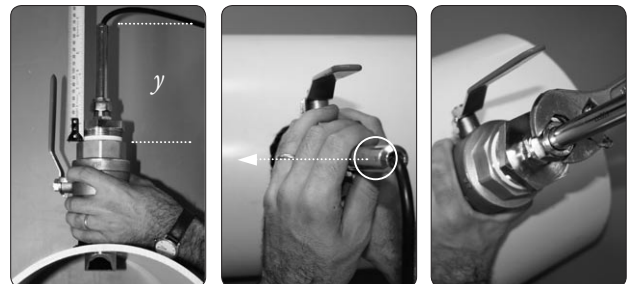

3. Installing the Electronics Module

Installing the Electronics Module on a pole or a wall and setting up the solar panel cannot be covered in this Quick Start Guide. Please download the "AgriFlo Series 3 Product Manual" from www.macemeters.com for detailed instructions.



4. Installing FloCom+ Software

FloCom+ software and the "AgriFlo Series 3 Product Manual" covering software installation can be downloaded from www.macemeters.com Brief instructions as follows:

1. Run the "FlocomPlus_[version number].exe" file to start the installation process.
2. Follow the instructions on the welcome screen then click "Next".
3. Choose a location on your computer to install FloCom+. The default option in your program files is "Mace\FlocomPlus". Click "Next".
4. FloCom+ will ask if you wish to create backups of replaced files. We advise you to click "Yes" then "Next".
5. Selecting a Program Manager Group. "Mace utilities" is the default group. We suggest leaving this as is. Click "Next" to begin installation.
6. Once the software installation is complete, click "Finish" to exit the setup program. FloCom+ is now ready to be used.

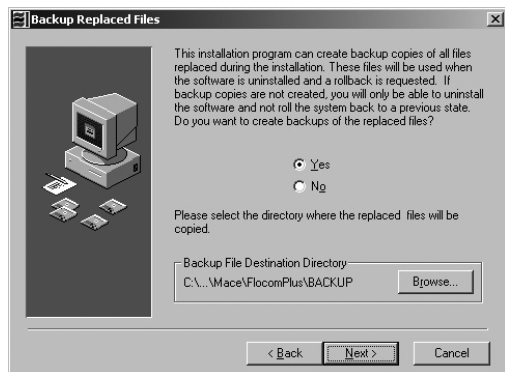

7. Run FloCom+ using the shortcut provided on your desktop. The startup menu will appear as shown below. Click "File>Comms settings..." to configure FloCom+ for your computer.



8. Select the serial port of your computer which will be used to communicate with the Flo Series3 device when a local connection will be made (i.e with a serial cable directly connected to the device).

! If you are using a USB to Serial adapter please refer to the product documentation supplied with the adapter to ensure the correct driver is installed

5. Connecting to the device

1. Connect the MACE serial cable (Part No. 891-300) provided between the serial port of the computer and the serial port of the FloSeries3 device located on the underside of the electronics module.

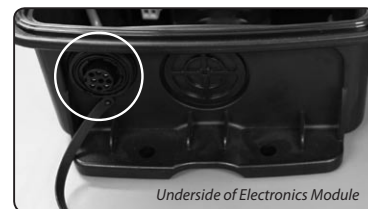

2. Click "Connect>direct". Enter the password which has been set in the unit and select continue. (The default password is "superid").
3. The main menu which includes the device status summary screen is now visible as shown below.



! The device must be configured and started before the meter will record flow

For detailed information on configuring the device refer to the FloCom+ software section of the "AgriFlo Series 3 Product Manual" which is available for download from www.macemeters.com